

# Beldray<sup>®</sup>

Est 1872

Nobody Does It Better

## Cordless Wet and Dry Vac Instruction Manual



Spills



Compact



THE **SCIENCE**  
BEHIND CLEAN



[www.beldray.com](http://www.beldray.com)

Please read all of the instructions carefully and retain for future reference.

## **Safety Instructions**

When using electrical appliances, basic safety precautions should always be followed

Check that the voltage indicated on the rating plate corresponds with that of the local network before connecting the appliance to the mains power supply.

Children aged from 8 years and people with reduced physical, sensory or mental capabilities or lack of experience and knowledge can use this appliance, only if they have been given supervision or instruction concerning use of the appliance in a safe way and understand the hazards involved.

Children should be supervised to ensure that they do not play with the appliance.

Unless they are older than 8 and supervised, children should not perform cleaning or user maintenance.

This product is not a toy.

This appliance contains no user serviceable parts. If the power supply cord, plug or any part of the appliance is malfunctioning or if it has been dropped or damaged, only a qualified electrician should carry out repairs. Improper repairs may place the user at risk of harm.

Keep the appliance out of the reach of children.

Keep the appliance and its supply cord away from heat or sharp edges that could cause damage.

Keep the appliance free of dust, lint, hair or anything that may reduce the airflow of the appliance.

Do not use the appliance with wet hands.

Do not use this appliance if any of the openings are blocked.

Do not use the appliance to pick up flammable liquids, matches, cigarette ends, hot ashes or any hot, burning or smoking objects.

Do not use this appliance to pick up hard, sharp objects such as glass or nails etc.

Do not use any accessories other than those supplied.

Do not fit any parts/accessories other than the parts supplied with this appliance, as this may cause damage.

Do not use the appliance to pick up water or any other liquid, as this poses risk of an electric shock.

Do not immerse the appliance in water or any other liquid.

Do not use the appliance for anything other than its intended use.  
Do not use this appliance outdoors.  
Do not leave the appliance unattended whilst connected to the mains power supply.  
Do not remove from the mains power supply by pulling the cord; switch off and remove the plug by hand.  
Do not store the appliance in direct sunlight or in high humidity conditions. Always unplug the appliance after use and before any cleaning or maintenance.  
Use of an extension cord with the appliance is not recommended.  
This appliance should not be operated by means of an external timer or separate remote control system.  
This appliance is intended for domestic use only. It should not be used for commercial purposes.

## **Battery Safety**

The battery unit should not be placed near excessive heat sources, such as fire.  
The supply terminals are not to be short-circuited.  
Exhausted batteries should be removed from the appliance to avoid leakage. In the event of the battery leaking, do not allow any liquid to come into contact with the skin or eyes.  
If contact has been made, wash the affected area with copious amounts of water and seek medical advice.  
Keep batteries out of reach of children.  
Avoid storing in direct sunlight.  
Do not dispose of the battery unit in a fire.  
Do not crush, puncture, dismantle or otherwise damage the battery.  
Do not store above 60°C.  
Do not expose batteries to heat or fire as they may explode.  
Do not subject the battery (batteries) to mechanical shock.  
Do not dispose of exhausted battery in your household waste.  
To dispose of the exhausted battery, take it to your local recycling station. Contact your local government offices for further details.  
This appliance is fitted with a 12 V 2.6 mAh sealed lead acid battery.

## Getting Started

Remove the appliance from the box.

Remove any packaging from the appliance.

Place the packaging inside the box and either store or dispose of safely.

## In the Box

Cordless Wet and Dry Vac

12 V rechargeable battery unit

Washable HEPA filter

Dust container

Waterproof cover

Mains power adapter

Wall mounted stand with accessory holder

Wall mount fixings

Wall mount screws

Crevice tool

Brush tool

Rubber Nozzle

## Features

12 V rechargeable battery

10 minutes of operation time

Washable HEPA filter

Metallic, high gloss finish

## Description of Parts

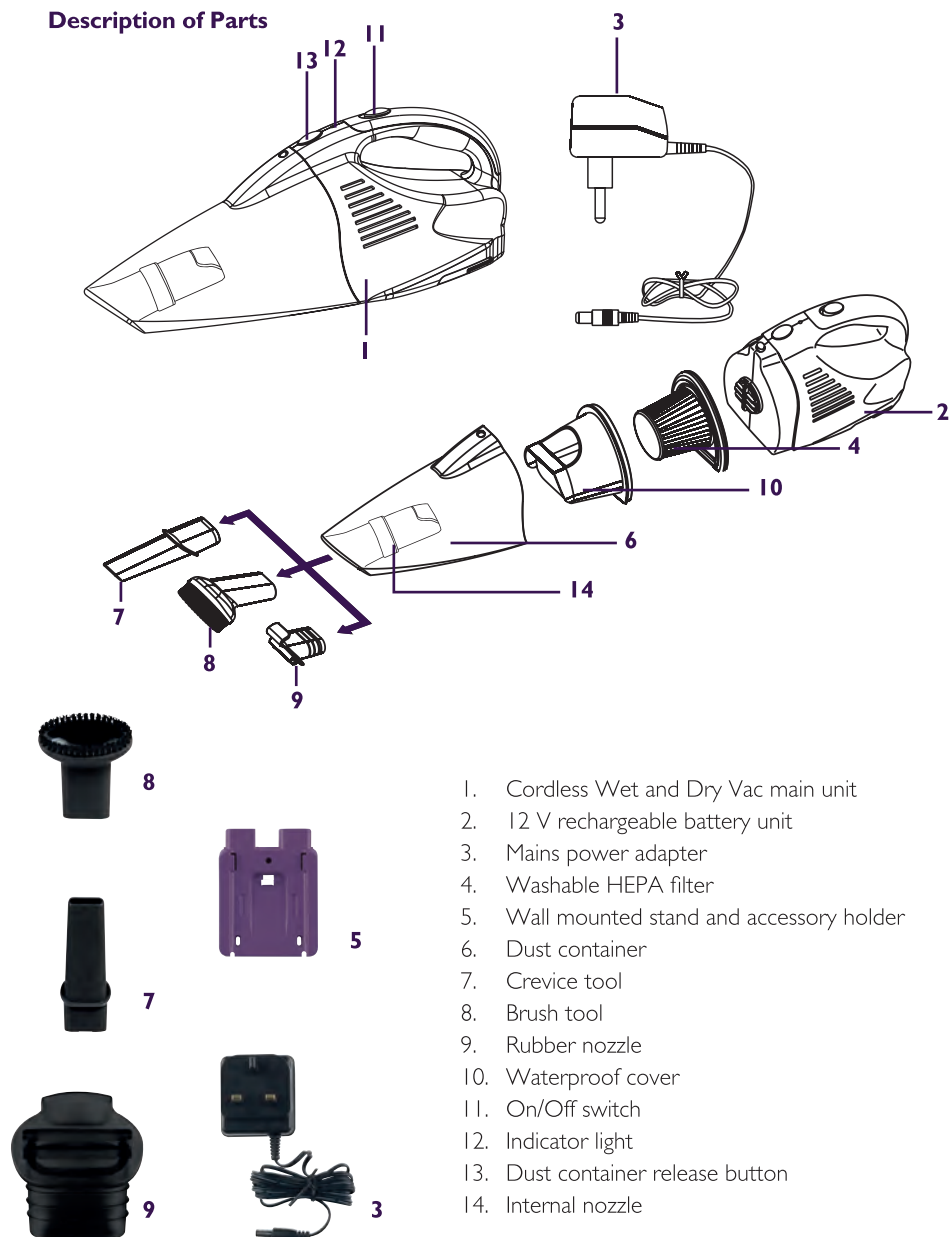

1. Cordless Wet and Dry Vac main unit
2. 12 V rechargeable battery unit
3. Mains power adapter
4. Washable HEPA filter
5. Wall mounted stand and accessory holder
6. Dust container
7. Crevice tool
8. Brush tool
9. Rubber nozzle
10. Waterproof cover
11. On/Off switch
12. Indicator light
13. Dust container release button
14. Internal nozzle

## Instructions for Use

### Installing the Wall Mounted Stand with Accessory Holder

The wall mounted stand with accessory holder should be located close to a mains power supply, so that it is within reach of the mains power adapter.

**STEP 1:** Hold the wall mounted stand against the wall that it will be fixed to and using a pencil, mark the positions of the screw holes onto the wall.

**STEP 2:** Drill where the holes have been marked and insert the wall mount fixings provided (or suitable wall fixings depending upon the structure of the wall). If in any doubt, consult a qualified professional.

**STEP 3:** Fix the wall mounted stand with accessory holder into position using the wall mount screws included.

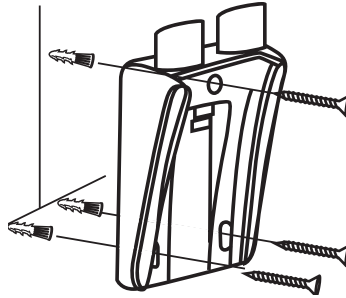

**STEP 4:** Store the attachments on the accessory holder and slide the Cordless Wet and Dry Vac onto the wall mounted stand, ensuring that it engages with the supporting ribs.



**STEP 5:** Connect the lead from the mains power adapter to the rear of the Cordless Wet and Dry Vac.

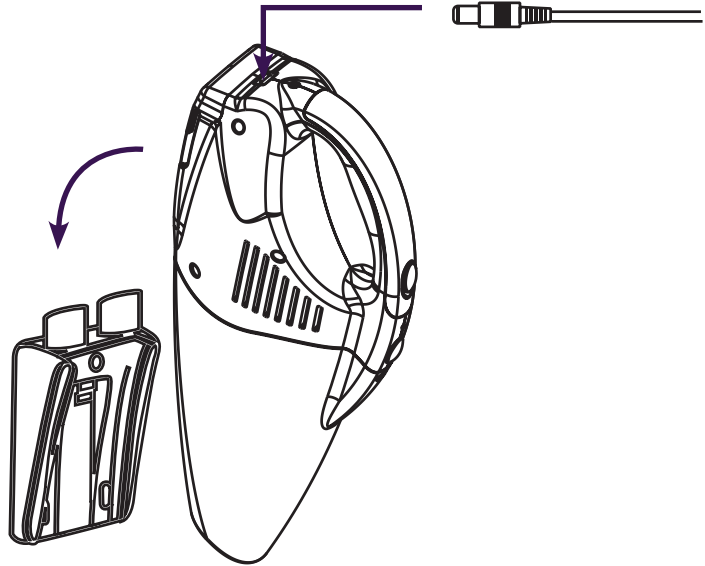

**Caution:** Ensure that there are no electrical, plumbing or gas supplies buried beneath the wall's surface. These services normally run vertically or horizontally behind the wall and the electrical wiring will radiate from the socket, possibly in more than one direction. Testers are available from good DIY stores. If in any doubt, consult a qualified professional.

### Charging the Cordless Wet and Dry Vac

Before first use, the Cordless Wet and Dry Vac must be charged for approximately 24 hours. Subsequent charging times will vary dependant upon use. If the Cordless Wet and Dry Vac runs down completely during use, it may take up to 12 hours to fully recharge the battery.

**STEP 1:** Clip the Cordless Wet and Dry Vac onto the wall mounted stand with accessory holder and connect the mains power adapter.

**STEP 2:** Plug the mains power adaptor into the mains power supply; the indicator light will illuminate red to confirm that the battery is charging. Once the battery is fully charged, the indicator light will illuminate green.

**Note:** Whilst charging, the Cordless Wet and Dry Vac may become warm.

## Using the Cordless Wet and Dry Vac

**STEP 1:** To use the Cordless Wet and Dry Vac, first remove the mains power adapter from the rear and then detach it from the wall mounted stand with accessory holder.

**STEP 2:** Flick the 'On/Off' switch forward to turn on the Cordless Wet and Dry Vac.

**Note:** Do not use the Cordless Wet and Dry Vac without the HEPA filter or dust container in position.

**Note:** Ensure that the HEPA filter is regularly cleaned to preserve the suction of the Cordless Wet and Dry Vac.

**Note:** When using the Cordless Wet and Dry Vac to pick up spillages such as water or tea, ensure that the liquid is emptied as soon as possible.

**Caution:** Do not use the Cordless Wet and Dry Vac to pick up flammable liquid.

**Caution:** Do not mix wet and dry functions; ensure that the dust container is empty of any debris before attempting to clean up liquid and thoroughly dried before dry vacuuming.

## Selecting the Correct Attachment

Attachment	Function
Crevice tool	Ideal for vacuuming up fine dust particles or for cleaning narrow openings.
Brush tool	Best for use on upholstery, where dirt is likely to be harder to remove through suction alone.
Rubber nozzle	Suitable for vacuuming up wet spills. <b>Note:</b> When using the Cordless Wet and Dry Vac to clean up spillages, ensure that the liquid is emptied from the unit as soon as possible after cleaning. <b>Caution:</b> Do not clean up flammable liquids.

## Installing the Attachments

All of the attachments can be easily installed onto the Cordless Wet and Dry Vac by firmly inserting them onto the dust container opening.

The internal nozzle should only be removed for cleaning purposes.

## Mixing Wet and Dry Functions

To preserve the life of the Cordless Wet and Dry Vac and to ensure optimum performance, **do not mix** wet and dry functions.

Ensure that the dust container has been emptied and is clear of any debris or dust and that it is completely dry before attempting to vacuum liquid.

Do not allow liquid to flow into the opening of the waterproof cover. Never tilt the Cordless Wet and Dry Vac backwards; this will cause water to enter the waterproof cover.



## Emptying the Dust Container

The dust container must be emptied regularly to maintain performance.

The dust container should also be emptied if there is a reduction in suction power or the dust level has reached the Max. mark, indicated on the dust container.

**STEP 1:** Hold the Cordless Wet and Dry Vac with the dust container facing downwards. Press the dust container release button and carefully remove the dust container from the Cordless Wet and Dry Vac main unit.

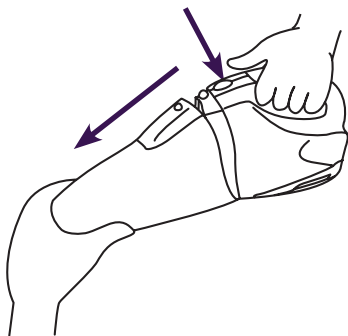

**STEP 2:** Remove the HEPA filter and the waterproof cover.

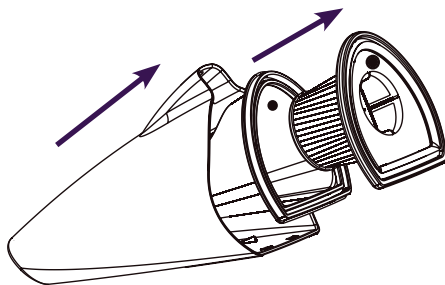

**STEP 3:** Empty the dust container slowly and carefully to reduce the amount of dust released back into the atmosphere.

**STEP 4:** If necessary, clean the individual parts with a soft, damp cloth and dry thoroughly before replacing.

**STEP 5:** Refit the HEPA filter and the waterproof cover.

**Note:** It is recommended that the dust container is emptied outdoors.

**Note:** It is recommended that the HEPA filter and dust container are thoroughly cleaned at least once a month. This can be done by rinsing them in cold, detergent-free water.

**Do's and Don'ts**

- DO** check that the HEPA filter is kept clear of obstruction.
- DO** make sure that the HEPA filter is regularly cleaned to preserve the suction of the Cordless Wet and Dry Vac.
- DO** ensure that any liquid is emptied immediately after picking up spillages.
- DO** clean the dust container and HEPA filter at least once a month.
- DON'T** use the Cordless Wet and Dry Vac without the HEPA filter or dust container in position
- DON'T** use the Cordless Wet and Dry Vac to pick up flammable liquid.
- DON'T** empty the dust container indoors.
- DON'T** remove the internal nozzle, unless it is for cleaning purposes.

**Cleaning and Maintenance**

Always unplug the Cordless Wet and Dry Vac from the mains power supply before attempting any cleaning or maintenance.

Wipe the Cordless Wet and Dry Vac main unit with a soft, damp cloth and dry thoroughly.

Do not immerse the Cordless Wet and Dry Vac main unit in water or any other liquid.

The dust container, waterproof cover and HEPA filter can be cleaned by rinsing with cold water and drying thoroughly.

Do not use harsh or abrasive cleaning detergents or scourers.

**Storage**

Ensure that the Cordless Wet and Dry Vac is cool, clean and dry.

Store in a cool, dry place.

**Troubleshooting**

Symptom	Possible Cause	Solution
The Cordless Wet and Dry Vac will not charge.	The mains power adapter is not connected.	Ensure that the mains power adapter is inserted correctly into the Cordless Wet and Dry Vac and that it is switched on at the mains power supply.
The Cordless Wet and Dry Vac's suction is reduced.	The nozzle or attachment is blocked. The dust container is full. The HEPA filter is blocked.	Remove the nozzle or attachment and clear any obstructions. Empty the dust container. Clean the HEPA filter.

## **Battery Removal and Disposal**

The Cordless Wet and Dry Vac is fitted with a sealed, lead acid battery, which must be disposed of at the end of the appliances life.

To remove the battery from the Cordless Wet and Dry Vac, unfasten the screws on the battery compartment and then carefully slide off the cover on the base of the appliance to give access to the battery.

Withdraw the battery and unclip the live and neutral terminal connections.

To dispose of the exhausted battery unit, take it to your local recycling station. Contact your local government offices for further details.

## **Specification**

Product Code: BEL0154

Power: 90 W

Mains supply: 230 V 50 Hz

Battery: 12 V 2.6 mAh Sealed Lead Acid

## UP Global Sourcing

Victoria Street, Manchester OL9 0DD. UK.

If this product does not reach you in an acceptable condition please contact our Customer Services Department by one of the following methods:

Telephone: +44 (0)333 577 9820\*

\*Telephone lines are open Monday – Friday, 9 am–5 pm (Closed Bank Holidays)

Email: [customersupport@beldray.co.uk](mailto:customersupport@beldray.co.uk)

Fax: 0161 628 2126

Please have your delivery note to hand as details from it will be required.

If you wish to return this product please return it to the retailer from where it was purchased with your receipt (subject to their terms and conditions).

## Guarantee

This product is guaranteed for a period of 1 year from the date of purchase against mechanical and electrical defects.

This guarantee is only valid if the appliance is used solely for domestic purposes in accordance with the instructions and provided that it is not connected to an unsuitable electricity supply or dismantled or interfered with in any way or damaged through misuse. Under this guarantee we undertake to repair or replace free of charge any parts found to be defective. Reasonable proof of purchase must be provided.

Nothing in this guarantee or in the instructions relating to this product excludes, restricts or otherwise affects your statutory rights.

In line with our policy of continuous development we reserve the right to change this product, packaging and documentation specification without notice.

Consumables are not guaranteed i.e. plug and fuse.

The crossed out wheellie bin symbol on this item indicates that this appliance needs to be disposed of in an environmentally friendly way when it becomes of no further use or has worn out. Contact your local authority for details of where to take the item for recycling.



Disposal	
 CARD PACKAGING widely recycled	 PLASTIC PACKING not currently recycled

Distributed by:  
UP Global Sourcing,  
Victoria Street, Manchester, OL9 0DD.  
+44 (0) 333 577 9820  
[customersupport@beldray.co.uk](mailto:customersupport@beldray.co.uk)

© 2014 Beldray Trademark. All rights reserved.

Please retain all instructions for future reference.  
Made in China.  
CD170912/MD081014/V6