

Beldray

Est 1872

Nobody Does It Better

1500W Steam Mop Instruction Manual



THE **SCIENCE**
BEHIND CLEAN

Please read all instructions carefully and retain for future reference.

Getting Started

Remove the appliance from the box.

Remove any packaging from the product.

Place the packaging inside the box and either store or dispose of safely.

In the Box

Steam Mop Body

Long Tube

Short Tube with Connector

Handle

2 x Mop Pads

Water Cup and Funnel

Instruction Manual

Features

High temperature steam cleaning freshens carpets and clean tiles, vinyl and hardwood floors

Quick start-up

Lightweight

Transparent tank allows monitoring of water level

Safety Instructions

When using electrical appliances, basic safety precautions should always be followed.

Check that the voltage indicated on the rating plate corresponds with that of the local network before connecting the appliance to the mains power supply.

This appliance is not intended for use by persons (including children) with reduced physical, sensory or mental capabilities or lack of experience or knowledge. They should be given supervision and instruction in the use of the appliance by a person responsible for their safety.

Children should be supervised to ensure they do not play with the appliance.

If the supply cord is damaged, it must be replaced by a qualified engineer in order to avoid a hazard.

Do not overfill the tank.

Use de-mineralised water rather than normal tap water.

Never point the steam outlet at another person or animal.

When adding water to the tank, ensure the cleaner is disconnected from the supply and the steam control is in the closed position.

Do not immerse the appliance in water or any other liquids.

This appliance contains no user serviceable parts. All repairs should only be carried out by a qualified engineer. Improper repairs may place the user at serious risk of harm.

Do not operate the appliance after a malfunction or if it has been dropped or damaged in any way.

Do not leave the appliance unattended whilst connected to the mains power supply.

The appliance must be unplugged from the power supply after use and whilst any maintenance such as cleaning is carried out.

Do not use the appliance for any purpose other than that for which it is designed.

Ensure the supply cord is kept away from heat or sharp edges that could cause damage.

This appliance is intended for household use only. It should not be used for commercial purposes.

Do not put any objects into openings. Do not use the appliance with any of the openings blocked.

Do not add cleaning solutions, scented perfumes, oils or any other chemicals to the water used in this appliance as this may damage the unit.

Allow the unit to cool before storing.

Functions

This appliance creates steam at extreme temperatures to provide cleaning of both hard floors and carpets.

The design and high efficiency of the boiler ensures a fast heat-up and powerful steam output.

Description of Parts

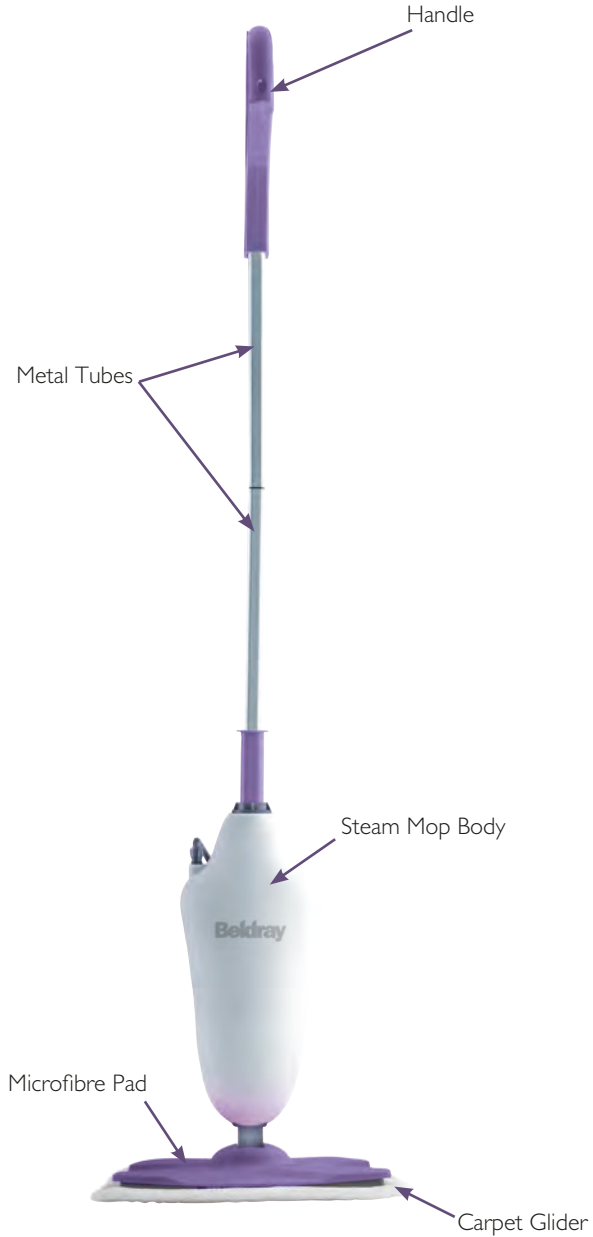

Instructions for Use

Assembly

Push the tube with the rectangular hole into the handle then place this assembly to one side.

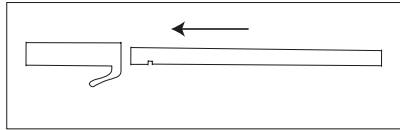

Position the remaining tube in the base section.

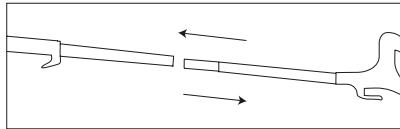

Push both assemblies together.

Note: the cable hooks should align with one another.

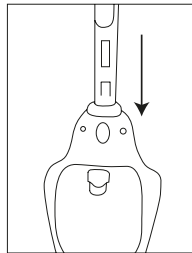

Insert the complete handle assembly into the steam mop body until it clicks into position.

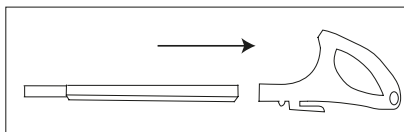

Preparation for Use

Sweep or vacuum your flooring before using the steam mop.

To fit the microfibre pad, align the Velcro fastening strips correctly and press firmly into place.

To use the steam mop on carpets, fit the carpet glider over the mop pad so that it clips to the edge of the steam mop base.

Ensure the steam mop is not connected to the mains power supply. Unscrew the lid at the top of the tank and fill with de-mineralised water.

In hard water areas, it is advisable to use de-mineralised water in order to prolong the life of the product.

Screw the lid back into position.

Unwrap the mains cord fully and plug into the mains power supply. The steam mop is ready for use when the indicator light changes from red to green.

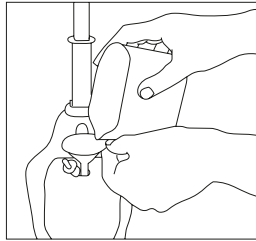

Cleaning

Caution: always test an inconspicuous area to ensure the floor surface will not be harmed by the steam from this appliance.

This appliance is not intended for use on unsealed floors.

Using the mop on waxed floors and some unwaxed floors may result in a diminished shine.

Storage of the mop with a wet mop pad may result in white marks on the floor; to remove these, clean the area with a vinegar solution.

To clean an area of the floor, press the unit/handle downwards and leave the steam mop over the area for a minimum of 5 seconds but no more than 15 seconds.

The steam mop will only produce steam when the unit is engaged by pushing the handle/unit downwards. This will happen as the mop is moved backwards and forwards.

When the steam mop stops producing steam, the water tank will require filling.

Disconnect the steam mop from the supply and add de-mineralised water, then reconnect to the supply.

After use

Remove the plug from the mains power supply and allow the steam mop to cool.

Wrap the mains cord around the cord wrap on the steam mop.

Empty the water tank and remove the mop pad. The mop pad can be machine washed in hot water and tumbled dry.

Wipe all the surfaces down with a dry cloth.

Store the steam mop upright in a dry area or hang by the handle.

The handle assembly can be removed by pressing the release button on the boiler section.

Cleaning and Maintenance

The steam mop should be wiped down using a soft cloth.

The mop pad can be machine washed in hot water then tumble dried.

Specification

Supply: 220-240V AC

Power: 1500W

Text

Connection to the mains

Please check that the voltage indicated on the product corresponds with your supply voltage.

Important

As the colours in the mains lead of this appliance may not correspond with the coloured markings identifying the terminals in your plug, please proceed as follows:

The wires in the mains lead are coloured in accordance with the following code:

Blue Neutral (N)

Brown Live (L)

Green/Yellow Earth (\perp)

FOR UK USE ONLY - Plug fitting details (where applicable).

The wire coloured BLUE is the NEUTRAL and must be connected to the terminal marked N or coloured BLACK.

The wire coloured BROWN is the LIVE wire and must be connected to the terminal marked L or coloured RED.

The wire coloured GREEN/YELLOW must be connected to the terminal marked with the letter E or marked \perp .

On no account must either the BROWN or the BLUE wire be connected to the EARTH terminal (\perp).

Always ensure that the cord grip is fastened correctly.

The plug must be fitted with a fuse of the same rating already fitted and conforming to BS 1362 and be ASTA approved.

If in doubt consult a qualified electrician who will be pleased to do this for you.

Non-rewireable mains plug

If your appliance is supplied with a non-rewireable plug fitted to the mains lead and should the fuse need replacing, you must use an ASTA approved one (conforming to BS 1362 of the same rating).

If in doubt, consult a qualified electrician who will be pleased to do this for you.

If you need to remove the plug - DISCONNECT IT FROM THE MAINS and then cut it off the mains lead and immediately dispose of it safely. Never attempt to re-use the plug or insert it into a socket outlet as there is a danger of an electric shock.

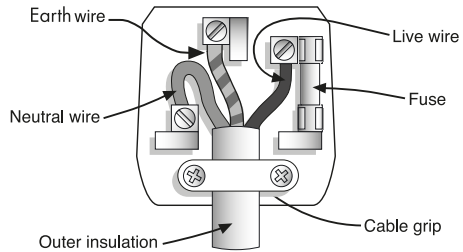

Ultimate Products Ltd.

Manor Mill, Victoria Street, Chadderton, Oldham, OL9 0DD

If this product does not reach you in an acceptable condition please contact our Customer Services Department by one of the following methods:

Telephone: +44 (0)333 577 9820*

*Telephone lines are open Monday – Friday, 9am – 5pm (Closed Bank Holidays)

Email: customersupport@beldray.co.uk

Fax: 0161 628 2126

Please have your delivery note to hand as details from it will be required.

If you wish to return this product please return it to the retailer from where it was purchased with your receipt (subject to their terms and conditions).

Guarantee

This product is guaranteed for a period of 1 year from the date of purchase against mechanical and electrical defects.

This guarantee is only valid if the appliance is used solely for domestic purposes in accordance with the instructions and provided that it is not connected to an unsuitable electricity supply or dismantled or interfered with in any way or damaged through misuse. Under this guarantee we undertake to repair or replace free of charge any parts found to be defective. Reasonable proof of purchase must be provided.

Nothing in this guarantee or in the instructions relating to this product excludes, restricts or otherwise affects your statutory rights.

In line with our policy of continuous development we reserve the right to change this product, packaging and documentation specification without notice.

Consumables are not guaranteed i.e. plug and fuse.

The crossed out wheelee bin symbol on this item indicates that this appliance needs to be disposed of in an environmentally friendly way when it becomes of no further use or has worn out. Contact your local authority for details of where to take the item for recycling.



Imported and Distributed by:

Ultimate Products Ltd.

Manor Mill

Victoria Street

Chadderton

Oldham OL9 0DD

+44 (0)333 577 9820

customersupport@beldray.co.uk

Please retain all instructions for future reference.

Made in China.

CD040412/MD040412/V1