

Beldray

Est. 1872

Nobody Does It Better

1300W Steam Mop

Instruction Manual



THE **SCIENCE**
BEHIND CLEAN

Getting Started

Remove the appliance from the box.

Remove any packaging from the appliance.

Place the packaging inside the box and store for future reference.

In the Box

Handle with cord clip

Tubes

Water tank

Measuring cup

Main body

Triangular mop head

2 x micro-fibre pads

Carpet glider

Cleaning needle

Instruction manual

Features

Removable water tank

Ready in 25 seconds

Continuous steam output

Red and blue indicator lights

Pressure relief protection

Flexible steam head mop for mobility

Self-standing unit

Quick release cord wrap clips

Safety instructions

When using electrical appliances, basic safety precautions should always be followed. Check that the voltage indicated on the rating plate corresponds with that of the local network before connecting the appliance to the mains power supply.

This appliance can be used by persons with reduced physical, sensory or mental capabilities or lack of experience and knowledge if they have been given supervision or instruction concerning use of the appliance in a safe way and understand the hazards involved. Children shall not play with the appliance. Cleaning and user maintenance shall not be made by children without supervision.

This appliance contains no user serviceable parts. Only a qualified electrician should attempt repairs. Improper repairs may place the user at risk of harm.

If the supply cord or plug is damaged or broken in any way, do not use the appliance until it has been inspected and repaired by a qualified electrician.

Keep the supply cord away from heat or sharp edges that could cause damage.

Keep the supply cord out of reach of children.

Never pull the power cord to disconnect the appliance from the mains power socket.

This appliance should not be operated by means of an external timer or separate remote control system.

Do not immerse the appliance in water or any other liquid.

Do not use the appliance after a malfunction or if it has been dropped or damaged in any way.

Do not leave the appliance unattended whilst connected to the mains power supply.

Do not leave the appliance unattended. Keep children away from unit whilst in use.

Do not use the appliance for anything other than its intended use.

Do not use outdoors.

This appliance is intended for domestic use only. It should not be used for commercial purposes.

Do not direct steam at people, animals, electrical appliances or electrical outlets.

Do not expose the appliance to rain.

Do not handle the appliance with wet hands.

Do not pull or carry the appliance by its supply cord.

Do not use the appliance in an enclosed space filled with vapour given off by oil-based paint thinners, some mothproofing substances, flammable dust or other explosive or toxic vapours.

Do not use on leather, wax polished furniture or floors, synthetic fabrics, velvet or other delicate, steam-sensitive materials.

Do not touch any parts of the appliance that may become hot during use.

Do not use the appliance if the micro-fibre cleaning pad is not installed correctly.

Do not use on any unsealed hard floor surfaces or surfaces that have been treated with wax as the sheen may be removed by the heat and steam action.

It is always recommended to test an isolated area of the surface to be cleaned before proceeding. Never add de-scaling, aromatic, alcoholic or detergent products into the appliance, as this may damage the appliance or make it unsafe for use.

The appliance emits very hot steam; always exercise extreme caution during use.

Caution: Always wear suitable shoes when using the appliance and when changing the accessories. Do not wear slippers or open-toed footwear.

Always unplug the appliance after use and before any cleaning or maintenance.

Ensure that the appliance has cooled fully after use, before cleaning or storing away.

Do not direct the steam towards equipment containing electrical components, such as the interior of ovens.

Do not use if it has been dropped, or if there are visible signs of damage or if it is leaking.

Keep out of reach of children when it is heating up or cooling down.

Additional Risks

Additional risks may arise when using this appliance, which may not be stated in the previous safety instructions. These risks can arise from misuse or prolonged operation of the appliance. Even when following the basic safety instructions highlighted in this manual, some risks cannot be avoided. These include injury from touching hot surfaces, changing accessories or using the appliance for a long period of time. It is recommended that you take regular breaks during prolonged use of the appliance.

Description of Parts



Carpet glider enables the cleaning of carpets and rugs

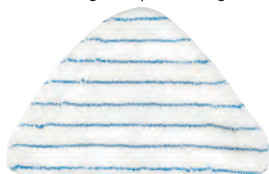

2 x microfibre cloths locks in dirt



Cord storage conveniently stores the 4.8m power cord



Removable handle for easy storage



1300W power for fast heat up and steam power



350ml easy fill water tank for continuous fill during operation



High performance mop head enables optimum steam distribution

Instructions for Use

Before First Use

Before using the steam mop for the first time, ensure that it is switched off and unplugged from the mains power supply.

Clean the exterior surface of the steam mop with a soft, damp cloth and dry thoroughly.

Assembly

Slide the Tube (B.) into the Handle (A.) until it clicks into place.

Slide the Tube (C.) into the Tube (B.) until it clicks into place.

Slide the Tube (C.) into slot of main body (D.), until it clicks into place.

Note: The handle can be removed from the steam mop body for easy storage by pressing the handle release button(s).

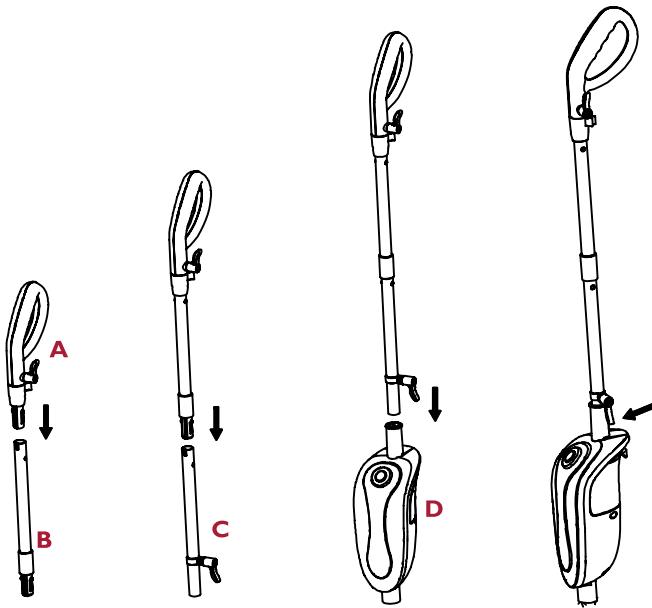

Attaching the Steam Head

Slide the bottom end of the steam mop body onto the triangular mop head until the triangular mop head spindle clicks into place. Hold both parts of the unit and gently push the clip into the handle. This will lock the two parts into position.

Warning: Never force the steam mop body onto the triangular mop head, as this could potentially damage the steam mop. Always attach the triangular mop head using both hands, ensuring it clicks into place correctly.

The triangular steam head can be removed from the main body by pressing the button on the triangular steam head spindle.

Attaching a Micro-Fibre Pad

Place the micro-fibre pad (F.) in between the steam head (E.) and the carpet glider (G.) and press down firmly. This will hold the micro-fibre pad in place due to the design of the steam mop head.



Filling the Water Tank

Remove the water tank from main body, open the water tank cup anticlockwise, fill the water tank from the tap and close. Install the water tank back onto the main body (D.) until it clicks into place.

Operation

Plug the steam mop into the mains power supply. When it turns on the indicator light will turn red to show that it is heating up.

The steam mop will take approximately 25 seconds to warm up. Once it has reached the correct temperature, the indicator light will change to blue; the steam mop is now ready to use.

Never allow the water in the tank to drop below the minimum level mark.

Cleaning and Maintenance

Before attempting any cleaning or maintenance, always unplug the steam mop from the mains power supply and allow it to cool sufficiently.

Drain the remaining water from the tank and clean after every use.

Clean the steam mop in warm, soapy water and dry thoroughly. Wipe it clean with a soft, dry cloth. Never immerse the electrical components in water or any other liquid.

The steam mop is not suitable for dishwasher use.

Do not use harsh or abrasive cleaners or detergents.

The micro-fibre pad is machine washable on a 'warm' setting. Always use a mild detergent and lay it flat to dry. Never use bleach or fabric softener when washing the micro-fibre pad.

To clean the calcium deposits that build up inside the water tank, add one or two tablespoons of white vinegar to a full water tank and close it. Shake the contents, then rinse thoroughly.

Note: Do not turn on the steam mop during cleaning.

Remove Limescale

If the steam mop begins to produce steam slower than usual or stops producing steam completely, you may need to remove limescale. Limescale can develop over time on the metal parts and greatly affects performance.

It is necessary to remove limescale on a regular basis, every 25-50 times you use a full tank of water or at least once a month, especially in areas with hard water.

The frequency of limescale removal depends upon the hardness of your tap water and usage.

To remove the limescale, prepare a solution of white vinegar and tap water and add it to the water tank.

Calcium deposits may be emitted with the steam. Please descale in a sink, bucket or towel to protect carpets etc.

Secure and position the steam mop to ensure that the steam released is aimed away from the floor or surrounding objects and surfaces.

Plug the steam mop into the mains power supply and turn it on; allow it to produce steam until all of the solution is used.

Repeat the above procedure as often as necessary, then fill the tank with fresh water and rinse. Fill the tank to the maximum level with fresh water, switch it on and release steam until the water tank is empty.

Warning: Do not leave the steam mop unattended during the limescale removal process or during use.

If there is a blockage in the steam nozzle, use the cleaning needle to clean the blockage along with the descaling solution. Insert the cleaning needle into the steam nozzle hole to clear the blockage, as shown in the image below.

Note: Ensure that the steam mop is switched off and has cooled fully.

After using the cleaning needle, add the descaling solution to the tank and follow the steps above.

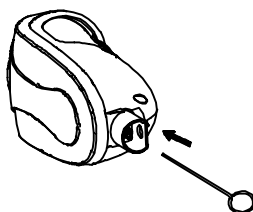

Troubleshooting

Problem	Cause	Solution
Reduced steam or no steam.	<p>The water tank may be empty.</p> <p>The steam nozzle may be blocked.</p> <p>There is no power to the steam mop.</p> <p>There may be a limescale build up.</p>	<p>Add water to refill the water tank.</p> <p>Clean the steam mop's nozzle.</p> <p>Make sure the steam mop is plugged in to the mains power supply.</p> <p>Descal the steam mop using the instructions in the 'Remove Limescale' section.</p>
Does not turn on.	<p>Blown fuse or breaker.</p> <p>The power cord is not plugged in.</p> <p>The internal fuse is blown.</p>	<p>Check the fuse by replacement or reset the breaker.</p> <p>Plug the power cord into a working mains power supply.</p> <p>Contact customer service for further advice.</p>

Storage

Before storing the steam mop, ensure that it has cooled and dried fully.

Ensure that the water tank is empty.

Remove the micro-fibre pad and wash ready for next use.

Store in a clean, dry place.

Specifications

Rated voltage: 220-240V~ 50Hz

Output power: 1300W

Water tank capacity: 350ml

Waterproof level: IPX4



Connection to the mains

Please check that the voltage indicated on the product corresponds with your supply voltage.

Important

As the colours in the mains lead of this appliance may not correspond with the coloured markings identifying the terminals in your plug, please proceed as follows:

The wires in the mains lead are coloured in accordance with the following code:

Blue Neutral (N)

Brown Live (L)

Green/Yellow Earth (\perp)

FOR UK USE ONLY - Plug fitting details (where applicable).

The wire coloured BLUE is the NEUTRAL and must be connected to the terminal marked N or coloured BLACK.

The wire coloured BROWN is the LIVE wire and must be connected to the terminal marked L or coloured RED.

The wire coloured GREEN/YELLOW must be connected to the terminal marked with the letter E or marked \perp .

On no account must either the BROWN or the BLUE wire be connected to the EARTH terminal (\perp).

Always ensure that the cord grip is fastened correctly.

The plug must be fitted with a fuse of the same rating already fitted and conforming to BS 1362 and be ASTA approved.

If in doubt consult a qualified electrician who will be pleased to do this for you.

Non-rewireable mains plug

If your appliance is supplied with a non-rewireable plug fitted to the mains lead and should the fuse need replacing, you must use an ASTA approved one (conforming to BS 1362 of the same rating).

If in doubt, consult a qualified electrician who will be pleased to do this for you.

If you need to remove the plug - DISCONNECT IT FROM THE MAINS and then cut it off the mains lead and immediately dispose of it safely. Never attempt to re-use the plug or insert it into a socket outlet as there is a danger of an electric shock.

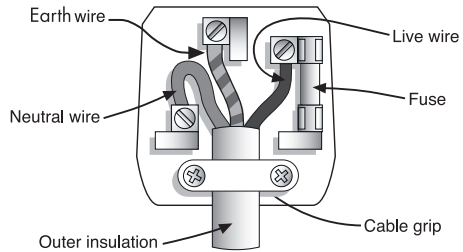

UP Global Sourcing

Manchester, OL9 0DD.

If this product does not reach you in an acceptable condition please contact our Customer Services Department by one of the following methods:

Telephone: +44 (0)333 577 9820*

*Telephone lines are open Monday – Friday, 9am – 5pm (Closed Bank Holidays)

Email: customersupport@beldray.co.uk

Fax: 0161 628 2126

Please have your delivery note to hand as details from it will be required.

If you wish to return this product please return it to the retailer from where it was purchased with your receipt (subject to their terms and conditions).

Guarantee

This product is guaranteed for a period of 1 year from the date of purchase against mechanical and electrical defects.

This guarantee is only valid if the appliance is used solely for domestic purposes in accordance with the instructions and provided that it is not connected to an unsuitable electricity supply or dismantled or interfered with in any way or damaged through misuse. Under this guarantee we undertake to repair or replace free of charge any parts found to be defective. Reasonable proof of purchase must be provided.

Nothing in this guarantee or in the instructions relating to this product excludes, restricts or otherwise affects your statutory rights.

In line with our policy of continuous development we reserve the right to change this product, packaging and documentation specification without notice.

Consumables are not guaranteed i.e. plug and fuse.

The crossed out wheelie bin symbol on this item indicates that this appliance needs to be disposed of in an environmentally friendly way when it becomes of no further use or has worn out. Contact your local authority for details of where to take the item for recycling.



Imported and Distributed by:
UP Global Sourcing,
Manchester, OL9 0DD.
+44 (0)333 577 9820
customersupport@beldray.co.uk

Please retain all instructions for future reference.
Made in China.
CD090713/MD000000/V1