

Beldray[®]

Est 1872

Nobody Does It Better

2 in 1 Multifunctional Vacuum Cleaner

Instruction Manual



Upright vacuum cleaner



Handheld vacuum cleaner



THE **SCIENCE**
BEHIND CLEAN



www.beldray.com

Please read all of the instructions carefully and retain for future reference.

Safety Instructions

When using electrical appliances, basic safety precautions should always be followed.

Check that the voltage indicated on the rating plate corresponds with that of the local network before connecting the appliance to the mains power supply.

Children aged from 8 years and people with reduced physical, sensory or mental capabilities or lack of experience and knowledge can use this appliance, only if they have been given supervision or instruction concerning use of the appliance in a safe way and understand the hazards involved.

Children should be supervised to ensure that they do not play with the appliance.

Unless they are older than 8 and supervised, children should not perform cleaning or user maintenance.

This appliance is not a toy.

This appliance contains no user serviceable parts. If the power supply cord, plug or any part of the appliance is malfunctioning or if it has been dropped or damaged, only a qualified electrician should carry out repairs. Improper repairs may place the user at risk of harm.

Keep the appliance out of the reach of children.

Keep the appliance and its supply cord away from heat or sharp edges that could cause damage.

Keep the appliance free of dust, lint, hair or anything that may reduce the airflow of the appliance.

Do not use the appliance with wet hands.

Do not use this appliance if any of the openings are blocked.

Do not use the appliance to pick up flammable liquid, matches, cigarette ends, hot ashes or any hot, burning or smoking objects.

Do not use this appliance to pick up hard, sharp objects such as glass or nails etc.

Do not use any accessories other than those supplied.

Do not fit any parts/accessories other than the parts supplied with this appliance, as this may cause damage.

Do not use the appliance to pick up water or any other liquid, as this poses risk of an electric shock.

Do not immerse the appliance in water or any other liquid.

Do not use the appliance for anything other than its intended use.

Do not use this appliance outdoors.

Do not leave the appliance unattended whilst connected to the mains power supply.

Do not remove from the mains power supply by pulling the cord; switch off and remove the plug by hand.

Do not store the appliance in direct sunlight or in high humidity conditions.

Always unplug the appliance after use and before any cleaning or maintenance.

Use of an extension cord with the appliance is not recommended.

This appliance should not be operated by means of an external timer or separate remote control system.

This appliance is intended for domestic use only. It should not be used for commercial purposes.



This appliance is fitted with a thermal cut-out device, which will activate if the motor overheats due to blocked air inlets. If the vacuum cleaner cuts out, allow it to cool for 1 hour, then empty the dust container and clean all of the filters.

Getting Started

Remove the appliance from the box.

Remove any packaging from the appliance.

Place the packaging inside the box and either store or dispose of safely.

In the Box

2 in 1 Multifunctional Vacuum Cleaner

Extension handle tube

Removable floor head

Crevice tool

Crevice tool storage stand

Instruction manual

Features

600 W power

Easily converts to a handheld unit

Washable fabric filter

0.5 L bagless dust container

5 m power cord

Includes crevice tool with storage stand

Description of Parts



- | | |
|----------------------------|----------------------------------|
| 1. Quick-release cord hook | 7. Dust container release button |
| 2. Extension tube handle | 8. Removable floor head |
| 3. Extension tube | 9. Bagless dust container |
| 4. Handheld vac handle | 10. Crevice tool |
| 5. Lower cord hook | 11. Fabric filter |
| 6. On/Off power switch | 12. Suction nozzle |

Assembling the 2 in 1 Multifunctional Vacuum Cleaner

STEP 1: Insert the extension tube into the main body.

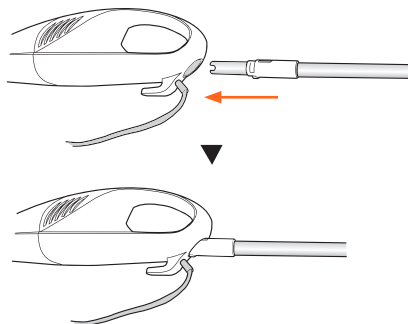

STEP 2: Attach the floor brush or the crevice tool to the 2 in 1 Multifunctional Vacuum Cleaner by slotting the selected tool into the suction nozzle.

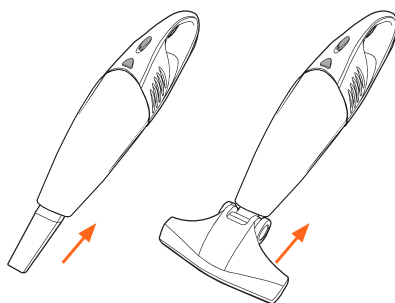

Using the 2 in 1 Multifunctional Vacuum Cleaner

Plug the 2 in 1 Multifunctional Vacuum Cleaner into the mains power supply.

To start the 2 in 1 Multifunctional Vacuum Cleaner, press the 'On/Off' power switch.

Ensure that the correct tool has been installed for the intended use (see 'Step 2' of 'Assembling the 2 in 1 Multifunctional Vacuum Cleaner'). The floor brush is ideal for vacuuming carpets, whilst the crevice tool is intended for use on harder surfaces and those which are awkward to clean, such as on radiators, in corners and between sofa cushions.

Note: Do not use the 2 in 1 Multifunctional Vacuum Cleaner without the fabric filter or dust container in position.

Note: Ensure that the fabric filter is regularly cleaned to preserve the suction of the 2 in 1 Multifunctional Vacuum Cleaner.

Winding and Unwinding the Power Cord

The 2 in 1 Multifunctional Vacuum Cleaner is equipped with a handy cord storage system. To use it, simply wind the power cord around the quick-release cord hook and the lower cord hook. To unwind the power cord, twist the quick-release cord hook either to the left or the right in order to release the cord from the stored position.

Using the Dust Filters

Once dust enters the dust container, the suction system keeps it moving in a swirling motion, in order to avoid reducing the suction. It is then filtered by the fabric filter.

Note: Dirty or worn fabric filters may cause damage to the motor.

Caution: The 2 in 1 Multifunctional Vacuum Cleaner should never be used without the fabric filter in place.

Emptying the Dust Container

STEP 1: Turn the 2 in 1 Multifunctional Vacuum Cleaner off and unplug it from the mains power supply.

STEP 2: Grasp the dust container firmly and then press the dust container release button to separate the dust container from the main unit.

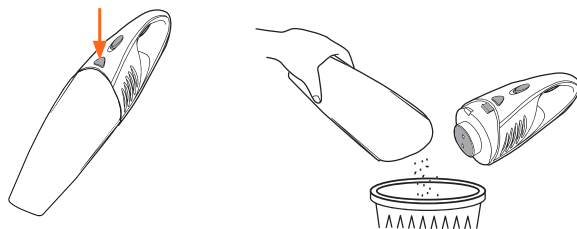

STEP 3: Carefully remove the fabric filter from the dust container and empty it, disposing of any dust. If there is any dust or other residue remaining on the fabric filter surface, clean according to the instructions provided (see 'Cleaning the Dust Container Fabric Filter').

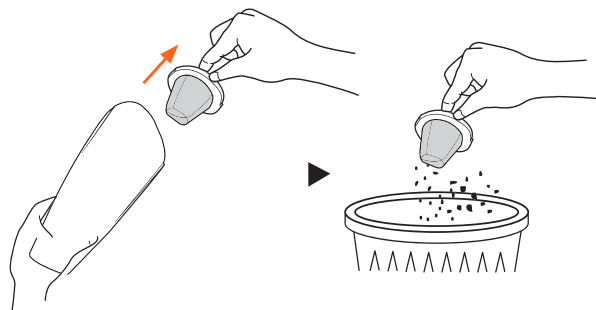

STEP 4: Carefully place the fabric filter back into the dust container and then refit the dust container to the 2 in 1 Multifunctional Vacuum Cleaner main body. To do this, hold the dust container at a slight angle and push it towards the main body, top first. An audible click will sound once the dust container is back in the correct position and is secure.

Cleaning the Dust Container Fabric Filter

To clean the dust container fabric filter, hold it over a waste bin, preferably outdoors, and then gently shake out any dust and dirt. Once the majority of the dust and dirt have been removed, rinse away any residue by running the fabric filter under cold water. Allow to dry thoroughly. Do not dry the fabric filter using any source of direct heat, such as radiators. Allow to dry naturally. Do not use any detergents or harsh cleaning agents to clean the fabric filter. Refit the fabric filter and dust container as described in the section entitled 'Emptying the Dust Container'.

It is recommended that the fabric filter be cleaned at least once a month with clean water to keep the 2 in 1 Multifunctional Vacuum Cleaner performing at its best.

Care and Maintenance

Wipe the external surface of the 2 in 1 Multifunctional Vacuum Cleaner with a soft, damp cloth and allow to dry thoroughly.

Do not use any detergents or harsh cleaning agents to clean any part of the 2 in 1 Multifunctional Vacuum Cleaner.

Ensure that the fabric filter is kept clean and is replaced when it becomes worn.

Troubleshooting

Symptom	Possible Cause	Solution
The suction is poor.	The hose/tube/suction nozzle is blocked. The dust container is almost full. The fabric filter is blocked.	Disconnect the accessories and remove the blockage. Empty the dust container. Clean the fabric filter.
The 2 in 1 Multifunctional Vacuum Cleaner has cut-out.	The thermal cut-out device is has actuated due to restricted airflow.	Unplug the 2 in 1 Multifunctional Vacuum Cleaner from the mains power supply and allow it to cool for 1 hour. Empty the dust container and clean the fabric filter.

Storage

The 2 in 1 Multifunctional Vacuum Cleaner can be lifted and transported easily using the carry handle. Never pull or lift the 2 in 1 Multifunctional Vacuum Cleaner by its power supply cord. Ensure that the 2 in 1 Multifunctional Vacuum Cleaner is cool, clean and dry. Store in a cool, dry place.

Specification

Rated Voltage: 220–240 V AC

Rated Wattage: 600 W nom. 700 W Max.

Frequency: 50 Hz

Connection to the mains

Please check that the voltage indicated on the product corresponds with your supply voltage.

Important

As the colours in the mains lead of this appliance may not correspond with the coloured markings identifying the terminals in your plug, please proceed as follows:

The wires in the mains lead are coloured in accordance with the following code:

Blue Neutral (N)

Brown Live (L)

FOR UK USE ONLY - Plug fitting details
(where applicable).

The wire coloured BLUE is the NEUTRAL and must be connected to the terminal marked N or coloured BLACK.

The wire coloured BROWN is the LIVE wire and must be connected to the terminal marked L or coloured RED.

On no account must either the BROWN or the BLUE wire be connected to the EARTH terminal (.

Always ensure that the cord grip is fastened correctly.

The plug must be fitted with a fuse of the same rating already fitted and conforming to BS 1362 and be ASTA approved.

If in doubt consult a qualified electrician who will be pleased to do this for you.

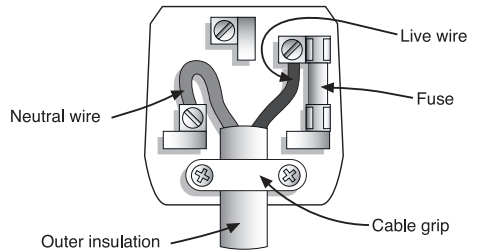

Non-rewireable mains plug

If your appliance is supplied with a non-rewireable plug fitted to the mains lead and should the fuse need replacing, you must use an ASTA approved one (conforming to BS 1362 of the same rating).

If in doubt, consult a qualified electrician who will be pleased to do this for you.

If you need to remove the plug - DISCONNECT IT FROM THE MAINS and then cut it off the mains lead and immediately dispose of it safely. Never attempt to reuse the plug or insert it into a socket outlet as there is a danger of an electric shock.

UP Global Sourcing

Victoria Street, Manchester OL9 0DD. UK.

If this product does not reach you in an acceptable condition please contact our Customer Services Department by one of the following methods:

Telephone: +44 (0)333 577 9820*

*Telephone lines are open Monday – Friday, 9 am–5 pm (Closed Bank Holidays)

Email: customersupport@beldray.co.uk

Fax: 0161 628 2126

Please have your delivery note to hand as details from it will be required.

If you wish to return this product please return it to the retailer from where it was purchased with your receipt (subject to their terms and conditions).

Guarantee

This product is guaranteed for a period of 1 year from the date of purchase against mechanical and electrical defects.

This guarantee is only valid if the appliance is used solely for domestic purposes in accordance with the instructions and provided that it is not connected to an unsuitable electricity supply or dismantled or interfered with in any way or damaged through misuse. Under this guarantee we undertake to repair or replace free of charge any parts found to be defective. Reasonable proof of purchase must be provided.

Nothing in this guarantee or in the instructions relating to this product excludes, restricts or otherwise affects your statutory rights.

In line with our policy of continuous development we reserve the right to change this product, packaging and documentation specification without notice.

Consumables are not guaranteed i.e. plug and fuse.

The crossed out wheelie bin symbol on this item indicates that this appliance needs to be disposed of in an environmentally friendly way when it becomes of no further use or has worn out. Contact your local authority for details of where to take the item for recycling.



