

Beldray[®] Est 1872

Nobody Does It Better

Turbo Plus⁺ Cordless Vacuum Cleaner

Instruction Manual



RECHARGES
UP TO
3X FASTER
RETAINS
BATTERY
POWER FOR
LONGER

THE **SCIENCE**
BEHIND CLEAN



www.beldray.com

Please read all of the instructions carefully and retain for future reference.

Safety Instructions

When using electrical appliances, basic safety precautions should always be followed.

Check that the voltage indicated on the rating plate corresponds with that of the local network before connecting the appliance to the mains power supply.

Children aged from 8 years and people with reduced physical, sensory or mental capabilities or lack of experience and knowledge can use this appliance, only if they have been given supervision or instruction concerning use of the appliance in a safe way and understand the hazards involved.

Children should be supervised to ensure that they do not play with the appliance.

Unless they are older than 8 and supervised, children should not perform cleaning or user maintenance.

This appliance is not a toy.

This appliance contains no user serviceable parts. If the power supply cord, plug or any part of the appliance is malfunctioning or if it has been dropped or damaged, only a qualified electrician should carry out repairs. Improper repairs may place the user at risk of harm.

Keep the appliance out of the reach of children.

Keep the appliance and its power supply cord away from heat or sharp edges that could cause damage.

Keep the appliance free from dust, lint, hair or anything that may reduce the airflow of the appliance.

Do not use the appliance with wet hands.

Do not use this appliance if any of the openings are blocked.

Do not use the appliance to pick up flammable liquid, matches, cigarette ends, hot ashes or any hot, burning or smoking objects.

Do not use this appliance to pick up hard, sharp objects such as glass or nails etc.

Do not use any accessories other than those supplied.

Do not fit any parts/accessories other than the parts supplied with this appliance, as this may cause damage.

Do not use the appliance to pick up water or any other liquid, as this poses risk of an electric shock.

Do not immerse the appliance in water or any other liquid.
Do not use the appliance for anything other than its intended use.
Do not use this appliance outdoors.
Do not leave the appliance unattended whilst connected to the mains power supply.
Do not remove from the mains power supply by pulling the cord; switch off and remove the plug by hand.
Do not store the appliance in direct sunlight or in high humidity conditions. Always unplug the appliance after use and before any cleaning or maintenance.
Use of an extension cord with the appliance is not recommended.
This appliance should not be operated by means of an external timer or separate remote control system.
This appliance is intended for domestic use only. It should not be used for commercial purposes.

Battery Safety

The battery unit should not be placed near excessive heat sources, such as fire.
The supply terminals are not to be short-circuited.
If the battery pack becomes exhausted, it should be removed from the appliance to avoid leakage.
In the event of the battery pack leaking, do not allow any liquid to come into contact with the skin or eyes.
If contact has been made, wash the affected area with copious amounts of water and seek medical advice.
Keep the battery pack out of reach of children.
Avoid storing the battery pack in direct sunlight.
Do not dispose of the battery pack in a fire.
Do not crush, puncture, dismantle or otherwise damage the battery pack.
Do not store above 60 °C.
Do not expose the battery pack to heat or fire as it may explode.
Do not subject the battery pack to mechanical shock.
Do not dispose of the exhausted battery pack in household waste.
To dispose of the exhausted battery pack, take it to a local recycling station. Contact the local government offices for further details.
This appliance is fitted with a 22.2 V 2150 mAh Li-ion battery (non-removable).

Getting Started

Remove the appliance from the box.

Remove any packaging from the appliance.

Place the packaging inside the box and either store or dispose of safely.

In the Box

Turbo Plus+ Cordless Vacuum Cleaner

Battery charging station

Mains power adaptor

Electric floor brush

Crevice tool

Brush tool

Instruction manual

Features

22.2 V rechargeable lithium-ion battery

Multifunctional – handheld and upright

Multidirectional swivel head

Powerful suction

Foldable handle

300 ml dust container

25–35 minutes operating time

Electric floor brush

Lightweight: 2 kg

Description of Parts



12.



16.



18.



19.



- | | |
|--|---|
| 1. Turbo Plus+ Cordless Vacuum Cleaner main body | 10. Dust container |
| 2. Main body handheld cradle | 11. Dust container release button |
| 3. Upright power button | 12. HEPA filter |
| 4. Foldable handle | 13. Indicator light |
| 5. Foldable handle release button | 14. Electric floor brush |
| 6. Handheld vac unit | 15. Electric floor brush release button |
| 7. Handheld vac handle | 16. Battery charging station |
| 8. Handheld vac release button | 17. Battery charging socket |
| 9. Handheld power button | 18. Brush tool |
| | 19. Crevice tool |

Instructions for Use

Assembling the Turbo Plus+ Cordless Vacuum Cleaner

STEP 1: Ensure that the Turbo Plus+ Cordless Vacuum Cleaner is unplugged from the mains power supply.

STEP 2: Fit the handheld vac unit by inserting the suction nozzle end into the main body handheld cradle and then push the handheld vac handle in towards the Turbo Plus+ Cordless Vacuum Cleaner main body until it locks into position.

STEP 3: Insert the upright vac suction nozzle at the bottom of the Turbo Plus+ Cordless Vacuum Cleaner main body into the electric floor brush, ensuring that the locking tab and pins are aligned, then push together until it locks into position.

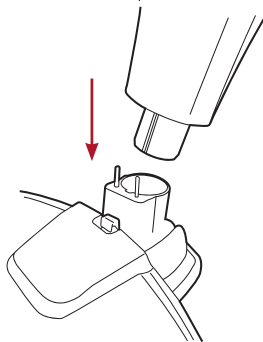

STEP 4: Open out the foldable handle by lifting it away from the Turbo Plus+ Cordless Vacuum Cleaner main body, until it locks into the upright position.

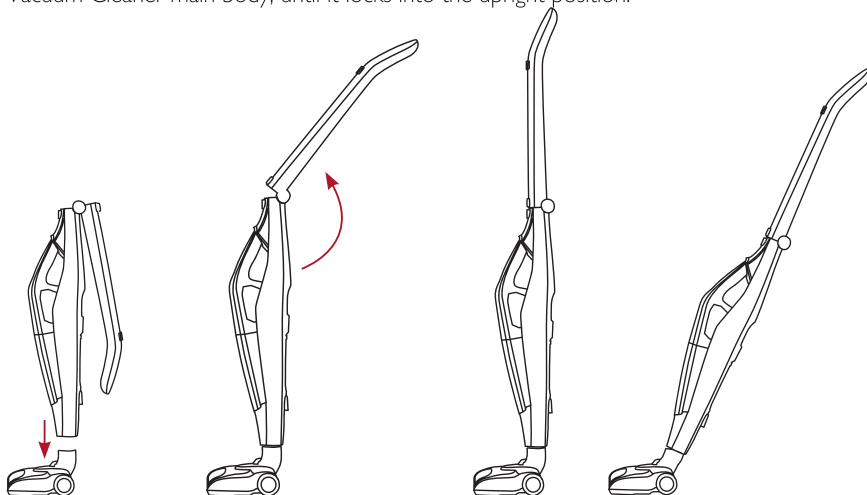

Assembling the Battery Charging Station

STEP 1: Position the battery charging station where it will be within reach of a mains power supply.

STEP 2: Insert the accessory holder into the base of the battery charging station.

STEP 3: Store the attachments on the accessory holder and slide the Turbo Plus+ Cordless Vacuum Cleaner onto the battery charging station, ensuring that it fully engages with the battery charging socket.

STEP 4: Connect the lead from the mains power adaptor to the back of the battery charging station.

Charging the Turbo Plus+ Cordless Vacuum Cleaner

Before first use, the Turbo Plus+ Cordless Vacuum Cleaner must be charged for approximately 3–4 hours. Subsequent charging times will vary dependant upon use. If the Turbo Plus+ Cordless Vacuum Cleaner runs down completely during use, it may take up to 3–4 hours to fully recharge the battery.

Using the Battery Charging Station

STEP 1: Slide the Turbo Plus+ Cordless Vacuum Cleaner onto the battery charging station.

STEP 2: Connect the mains power adaptor to the back of the battery charging station, ensuring that the slot on the reverse of the unit aligns with the socket on the upright section of the charging station.

STEP 3: Plug the mains power adaptor into the mains power supply; the indicator light will flash red to confirm that the battery is charging. Once the battery is fully charged, the indicator light will illuminate red and the battery charging station will automatically stop charging, to preserve the lifespan of the battery.

Note: If the indicator light begins to flash rapidly, there has been a malfunction whilst charging. Remove the Turbo Plus+ Cordless Vacuum Cleaner from the battery charging station and then repeat steps 1–3.

Using the Turbo Plus+ Cordless Vacuum Cleaner

The operation time of the Turbo Plus+ Cordless Vacuum Cleaner will vary depending upon the speed setting used. The Turbo Plus+ Vacuum Cleaner will run for approximately 25 minutes when used on a higher speed setting and approximately 35 minutes when used on a normal speed setting.

As an Upright Vac

STEP 1: Ensure that the Turbo Plus+ Cordless Vacuum Cleaner is unplugged from the mains power supply and then detach it from the battery charging station.

STEP 2: Install the electric floor brush following the instructions in the section entitled 'Assembling the Turbo Plus+ Cordless Vacuum Cleaner'.

STEP 3: To turn on the Turbo Plus+ Cordless Vacuum Cleaner, press the 'Power' button. The

indicator light will illuminate red to signal that the Turbo Plus+ Cordless Vacuum Cleaner has powered on.

STEP 4: If a higher speed is required, press the 'Power' button a second time.

STEP 5: Turn off the Turbo Plus+ Cordless Vacuum Cleaner by pressing the 'Power' button once more.

As a Handheld Vac

STEP 1: Ensure that the Turbo Plus+ Cordless Vacuum Cleaner is unplugged from the mains power supply and then detach it from the battery charging station if necessary.

STEP 2: Press and hold the handheld vac release button and then using the handheld vac handle, carefully pull the handheld vac unit away from the Turbo Plus+ Cordless Vacuum Cleaner main body.

STEP 3: Install the required attachment by inserting it into the handheld vac suction nozzle. The brush tool is great for use on upholstery, whilst the crevice tool is ideal for those awkward to clean areas.

STEP 4: To turn on the Turbo Plus+ Cordless Vacuum Cleaner, press the 'Power' button.

STEP 5: If a higher speed is required, press the 'Power' button.

STEP 6: Turn off the Turbo Plus+ Cordless Vacuum Cleaner by pressing the 'Power' button once more.

Emptying the Dust Container

It is important to empty the dust container regularly. This will help to preserve suction and prolong the life of the Turbo Plus+ Cordless Vacuum Cleaner.

STEP 1: Turn off the Turbo Plus+ Cordless Vacuum Cleaner and unplug it from the mains power supply.

STEP 2: Press and hold the handheld vac release button and then using the handheld vac handle, carefully pull the handheld vac unit away from the Turbo Plus+ Cordless Vacuum Cleaner main body.

STEP 3: If the Turbo Plus+ Cordless Vacuum Cleaner has been used as a handheld unit, remove the attachment by carefully pulling it out of the suction nozzle.

STEP 4: Hold the handheld vac unit with the dust container facing downwards. Press the dust container release button (1) and carefully remove the dust container from the handheld vac unit (2).

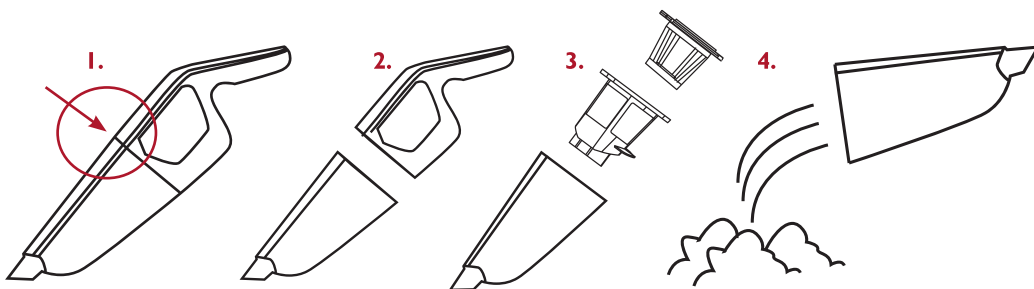

STEP 5: Carefully remove the HEPA filter from the dust container (3). If there is any dust or other residue remaining on the HEPA filter surface, clean it according to the instructions provided (see the section entitled 'Cleaning the HEPA filter').

STEP 6: Empty the dust container over a bin slowly and carefully to reduce the amount of dust released back into the atmosphere (4).

STEP 7: Reinsert the HEPA filter into the dust container and then refit the dust container to the handheld unit, ensuring that the locking tab and button are aligned with the corresponding slots.

Cleaning the HEPA Filter

It is important to keep the HEPA filter free from dust and dirt, to allow air to flow freely around the Turbo Plus+ Cordless Vacuum Cleaner. This will help to preserve suction and prolong the life of the Turbo Plus+ Cordless Vacuum Cleaner.

STEP 1: To clean the HEPA filter, hold it over a waste bin, preferably outdoors, and gently shake off any dust and dirt. Once the majority of the dust and dirt has been removed, rinse away any residue by running the HEPA filter under cold water. Do not use any detergents or harsh cleaning agents to clean the HEPA filter.

STEP 2: Do not dry the HEPA filter using any source of direct heat, such as radiators. Allow it to dry naturally.

STEP 3: Once the HEPA filter has fully dried, refit it, along with the dust container following the instructions in the section entitled 'Emptying the Dust Container'.

Note: It is recommended that the HEPA filter be cleaned at least once a month with clean water to keep the Turbo Plus+ Cordless Vacuum Cleaner performing at its best.

Cleaning the Airflow Chamber

STEP 1: Remove the filter following the instructions in the section entitled 'Emptying the Dust Container'.

STEP 2: To detach the airflow chamber, pull it away from the HEPA filter.

STEP 3: Rinse away any residue by running the airflow chamber under cold water. Allow it to dry thoroughly.

STEP 4: Refit the airflow chamber by positioning it over the HEPA filter, until it locks into position.

Cleaning the Electric Floor Brush

It is important to clean the electric floor brush on a regular basis, as this will help to ensure optimum cleaning performance.

The electric floor brush can be removed from the Turbo Plus+ Cordless Vacuum Cleaner main body for easy cleaning. Always ensure that the electric floor brush is replaced correctly.

STEP 1: Remove the electric floor brush from the Turbo Plus+ Cordless Vacuum Cleaner main unit by pressing the electric floor brush release button and gently pulling the main unit away from the electric floor brush.

STEP 2: Remove the locking tab from the base of the electric floor brush by using a flat head screwdriver (not included) to turn the lock to the 'unlocked' position.

STEP 3: Lift the brush unit out of the electric floor brush.

STEP 4: Using a thin tool, remove any built-up debris from the brush bar, inside the electric floor brush and the air inlet on the top of the floor brush.

STEP 5: After cleaning, replace the brush unit, ensuring that the ends are correctly aligned with the corresponding slots in the electric floor brush. Reinsert the locking tab and turn it to the 'locked' position using a flat head screwdriver (not included).

Step 6: Insert the upright vac suction nozzle at the bottom of the Turbo Plus+ Cordless Vacuum Cleaner main body into the electric floor brush, ensuring that the locking tab and pins are aligned, then push together until it locks into position.

Note: Do not immerse the electric floor brush in water or any other liquid.

Dos and Don'ts

Do:

Check that the HEPA filter is kept clear of obstruction.

Make sure that the dust container and HEPA filter are cleaned regularly to preserve the suction and to prolong the life of the Turbo Plus+ Cordless Vacuum Cleaner.

Ensure that the electric floor brush is kept free from a build-up of dust and dirt.

Clean the brush bar on a regular basis.

Don't:

Use the Turbo Plus+ Cordless Vacuum Cleaner without the HEPA filter or dust container in position.

Use the Turbo Plus+ Cordless Vacuum Cleaner to pick up liquid, matches, cigarette ends, hot ashes or any hot, burning or smoking objects.

Empty the dust container indoors.

Care and Maintenance

Always unplug the Turbo Plus+ Cordless Vacuum Cleaner from the mains power supply before attempting any cleaning or maintenance.

Wipe the external surface of the Turbo Plus+ Cordless Vacuum Cleaner with a soft, damp cloth and allow to dry thoroughly.

Do not use harsh or abrasive cleaning detergents or scourers to clean any part of the Turbo Plus+ Cordless Vacuum Cleaner.

Ensure that the HEPA filter is kept clean and is replaced when it becomes worn.

Storage

Ensure that the Turbo Plus+ Cordless Vacuum Cleaner is cool, clean and dry.

The Turbo Plus+ Cordless Vacuum Cleaner can be stored with ease by using the foldable handle; simply press the foldable handle release button and carefully push the foldable handle down towards the back of the Turbo Plus+ Cordless Vacuum Cleaner main unit.

Store in a cool, dry place.

Troubleshooting

Symptom	Possible Cause	Solution
The Turbo Plus+ Cordless Vacuum Cleaner will not charge.	The mains power adaptor lead is not securely connected.	Plug the mains power adaptor into the mains power supply, ensuring that it is switched on and then follow the instructions in the section entitled 'Charging the Turbo Plus+ Cordless Vacuum Cleaner'.
The suction is poor.	<p>The suction nozzle is blocked.</p> <p>The dust container is almost full.</p> <p>The HEPA filter is blocked.</p> <p>The electric floor brush and brush bar have a build-up of debris.</p>	<p>Disconnect the attachment from the suction nozzle and remove the blockage.</p> <p>Empty the dust container following the instructions in the section entitled 'Emptying the Dust Container'.</p> <p>Clean the HEPA filter following the instructions in the section entitled 'Cleaning the HEPA Filter'.</p> <p>Clean the electric floor brush and brush bar following the instructions in the section entitled 'Cleaning the Electric Floor Brush'.</p>

The indicator light on the Turbo Plus+ Cordless Vacuum Cleaner is flashing rapidly.	There has been a malfunction whilst charging.	Remove the Turbo Plus+ Cordless Vacuum Cleaner from the battery charging station and then repeat steps 1–3 from the section entitled 'Using the Battery Charging Station'.
---	---	--

Battery Removal and Disposal

The Turbo Plus+ Cordless Vacuum Cleaner is fitted with a 22.2 V 2150 mAh Li-ion battery, which must be disposed of at the end of the appliances life.

To remove the battery from the Turbo Plus+ Cordless Vacuum Cleaner, unfasten the screws and dismantle the product to gain access to the battery. This will require a crosshead screwdriver (not included).

Withdraw the battery and unclip the live and neutral terminal connections.

To dispose of the exhausted battery unit, take it to a local recycling station. Contact the local government offices for further details.

Specification

Product code: BEL0502

Battery: 22.2 V 2150 mAh Li-ion (included)

28 V DC charger (included)

Dust tank capacity: 300 ml

UP Global Sourcing

Victoria Street, Manchester OL9 0DD. UK.

If this product does not reach you in an acceptable condition please contact our Customer Services Department by one of the following methods:

Telephone: +44 (0)333 577 9820*

*Telephone lines are open Monday–Friday, 9 am–5 pm (Closed Bank Holidays)

Email: customersupport@beldray.co.uk

Fax: 0161 628 2126

Please have your delivery note to hand as details from it will be required.

If you wish to return this product please return it to the retailer from where it was purchased with your receipt (subject to their terms and conditions).

Guarantee

This product is guaranteed for a period of 1 year from the date of purchase against mechanical and electrical defects.

This guarantee is only valid if the appliance is used solely for domestic purposes in accordance with the instructions and provided that it is not connected to an unsuitable electricity supply or dismantled or interfered with in any way or damaged through misuse. Under this guarantee we undertake to repair or replace free of charge any parts found to be defective. Reasonable proof of purchase must be provided.

Nothing in this guarantee or in the instructions relating to this product excludes, restricts or otherwise affects your statutory rights.

In line with our policy of continuous development we reserve the right to change this product, packaging and documentation specification without notice.

Consumables are not guaranteed i.e. plug and fuse.

The crossed out wheelie bin symbol on this item indicates that this appliance needs to be disposed of in an environmentally friendly way when it becomes of no further use or has worn out. Contact your local authority for details of where to take the item for recycling.



Disposal	
 CARD PACKAGING widely recycled	 PLASTIC PACKAGING not currently recycled

Manufactured and distributed by:
UP Global Sourcing,
Victoria Street, Manchester OL9 0DD, UK
+44 (0)333 577 9820
customersupport@beldray.co.uk

©Beldray Trademark. All rights reserved.

Please retain all instructions for future reference.
Made in China.
CD210715/MD090816/V3