

Beldray[®]

Est 1872

Nobody Does It Better

2 in 1 Multi Vac Instruction Manual

COMPACT
AND LIGHT
ONLY
2.3 KG



THE **SCIENCE**
BEHIND CLEAN



www.beldray.com

Please read all of the instructions carefully and retain for future reference.

Safety Instructions

When using electrical appliances, basic safety precautions should always be followed.

Check that the voltage indicated on the rating plate corresponds with that of the local network before connecting the appliance to the mains power supply.

Children aged from 8 years and people with reduced physical, sensory or mental capabilities or lack of experience and knowledge can use this appliance, only if they have been given supervision or instruction concerning use of the appliance in a safe way and understand the hazards involved.

Children should be supervised to ensure that they do not play with the appliance.

Unless they are older than 8 and supervised, children should not perform cleaning or user maintenance.

This appliance is not a toy.

This appliance contains no user serviceable parts. If the power supply cord, plug or any part of the appliance is malfunctioning or if it has been dropped or damaged, only a qualified electrician should carry out repairs. Improper repairs may place the user at risk of harm.

Keep the appliance and its power supply cord out of the reach of children. Keep the appliance out of the reach of children when it is switched on or cooling down.

Keep the appliance and its power supply cord away from heat or sharp edges that could cause damage.

Keep the appliance away from other heat emitting appliances.

Keep the appliance free from dust, lint, hair or anything that may reduce the airflow of the appliance.

Do not immerse the appliance in water or any other liquid.

Do not operate the appliance with wet hands.

Do not expose the appliance to rain.

Do not leave the appliance unattended whilst connected to the mains power supply.

Do not remove from the mains power supply by pulling the cord; switch off and remove the plug by hand.

Do not pull or carry the appliance by its power supply cord.

Do not use the appliance if it has been dropped or if there are visible signs of damage.

Do not use the appliance for anything other than its intended use.

Do not use any parts/accessories other than those supplied with this appliance, as this may cause damage.

Do not use any damaged accessories.

Do not use this appliance outdoors.

Do not store the appliance in direct sunlight or in high humidity conditions.

Do not use this appliance if any of the openings are blocked.

Do not use the appliance to pick up flammable liquid, matches, cigarette ends, hot ashes or any hot, burning or smoking objects.

Do not use this appliance to pick up hard, sharp objects such as glass or nails etc.

Do not use the appliance to pick up water or any other liquid, as this poses risk of an electric shock.

Take care when equipping accessories with rotating parts as this could cause entrapment.

Switch off the appliance and disconnect it from the mains power supply before changing or fitting accessories.

Always unplug the appliance after use and before any cleaning or maintenance.

Always ensure that the appliance has cooled fully after use before performing any cleaning or user maintenance.

Use of an extension cord with the appliance is not recommended.

Only use the appliance with the power supply unit provided.

This appliance should not be operated by means of an external timer or separate remote control system.

This appliance is intended for domestic use only. It should not be used for commercial purposes.

Thermal Cut-out Device

If the dust container and filters are not cleaned on a regular basis, the vacuum cleaner may overheat, which will cause the thermal cut-out device to activate due to restricted flow of air around the unit. If the vacuum cleaner cuts out, press the power switch to turn it off and unplug it from the mains power supply. Proceed to empty the dust container, clean all of the filters and allow the vacuum cleaner to cool for approx. 1 hour.

Dos and Don'ts

Do:

Check that the HEPA filter is kept clear of obstruction.

Make sure that the dust container and HEPA filter are cleaned regularly to preserve suction and prolong the life of the vacuum cleaner.

Clean the dust container and HEPA filter at least every three weeks with clean water to keep the vacuum cleaner working efficiently.

Don't:

Use the vacuum cleaner without the HEPA filter or dust container in position.

Use the vacuum cleaner to pick up flammable liquid, matches, cigarette ends, hot ashes or any hot, burning or smoking objects.

Use the vacuum cleaner to pick up water or any other liquid, as this poses risk of an electric shock.

Care and Maintenance

Wipe the external surface of the vacuum cleaner with a soft, damp cloth and allow to dry thoroughly.

Do not use any harsh or abrasive detergents cleaning agents to clean any part of the vacuum cleaner.

Keep the HEPA filter clean and replace when it becomes worn.

Getting Started

Remove the appliance from the box.

Remove any packaging from the appliance.

Place the packaging inside the box and either store or dispose of safely.

In the Box

2 in 1 Multi Vac

Floor brush

Crevice tool

Brush tool

Instruction manual

Features

600 W power

Multifunctional – handheld and upright

Powerful suction

Foldable handle

500 ml dust container

Washable HEPA filter

Lightweight: only 2.3 kg

Includes crevice tool and brush tool

5 m power cord

Description of Parts

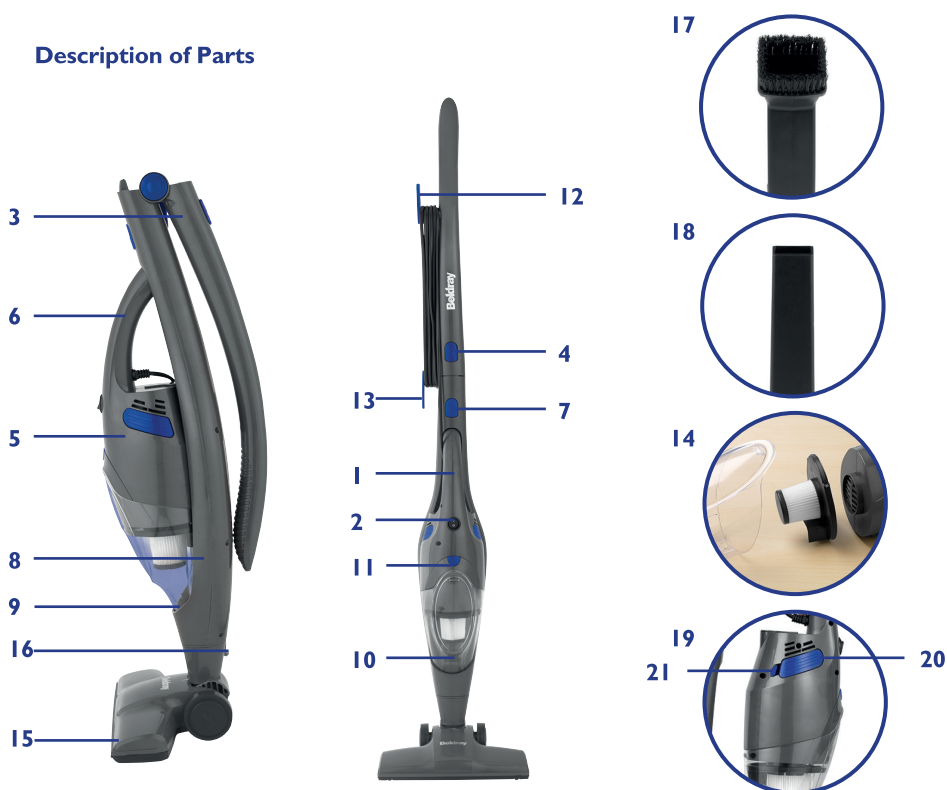

1. 2 in 1 Multi Vac
2. 'On/Off' switch
3. Foldable handle
4. Foldable handle release button
5. Handheld vac unit
6. Handheld vac handle
7. Handheld vac release button
8. Handheld vac cradle
9. Handheld vac suction nozzle
10. Dust container
11. Dust container release button

12. Upper cord storage hook
13. Lower cord storage hook
14. HEPA filter
15. Floor brush
16. Floor brush release button
17. Brush tool
18. Crevice tool
19. Exhaust filter
20. Exhaust filter cover (houses exhaust filter sponge and sponge holder)
21. Exhaust filter tab

Instructions for Use

Assembling the 2 in 1 Multi Vac

STEP 1: Before connecting to the mains power supply, fit the handheld vac unit into the handheld vac cradle by inserting at the suction nozzle end. Push the handheld vac handle in towards the vacuum cleaner main body, until it locks into position.

STEP 2: Insert the upright vac suction nozzle at the bottom of the vacuum cleaner main body into the floor brush, and then push together until it locks into position.

STEP 3: Open out the foldable handle by lifting it away from the vacuum cleaner main body, until it locks into the upright position.

Using the 2 in 1 Multi Vac

As an Upright Vac

STEP 1: Before connecting to the mains power supply, assemble the vacuum cleaner following the instructions in the section entitled 'Assembling the 2 in 1 Multi Vac'.

STEP 2: To turn on the vacuum cleaner, press the 'On/Off' switch to the 'On' position.

STEP 3: Turn off the vacuum cleaner by pressing the 'On/Off' switch to the 'Off' position.

As a Handheld Vac

STEP 1: Before connecting to the mains power supply, press and hold the handheld vac release button and pull the handheld vac unit away from the vacuum cleaner main body using the handheld vac handle.

STEP 2: Install the required attachment by inserting it into the handheld vac suction nozzle. The brush tool is great for use on upholstery, whilst the crevice tool is ideal for those awkward-to-clean areas.

STEP 3: To turn on the vacuum cleaner, press the 'On/Off' switch to the 'On' position.

STEP 4: Turn off the vacuum cleaner by pressing the 'On/Off' switch to the 'Off' position.

Emptying the Dust Container

Before emptying the dust container, check that the vacuum cleaner is switched off and any attachments have been removed.

It is recommended to empty the dust container outdoors.

It is important to empty the dust container regularly. This will help to preserve suction and prolong the life of the vacuum cleaner.

STEP 1: Whilst securely holding the handheld vac handle, press the handheld vac release button and pull the handheld vac unit away from the vacuum cleaner main body. If the vacuum cleaner has been used as a handheld vac, remove the attachment by carefully pulling it away from the handheld vac suction nozzle.

STEP 2: Hold the handheld vac unit with the dust container facing downwards. Push the dust container release button (1) and carefully remove the dust container from the handheld vac unit (2).

STEP 3: Carefully remove the HEPA filter from the dust container (3) and empty it, disposing of any dust. If there is any dust or other residue remaining on the HEPA filter surface, clean it according to the instructions provided in the section entitled 'Cleaning the HEPA Filter'.

STEP 4: Empty the dust container over a bin, slowly and carefully to reduce the amount of dust released back into the atmosphere (4).

STEP 5: Reinsert the HEPA filter into the dust container and then refit the dust container to the handheld vac unit, making sure that the locking clip is aligned.

Note: Always close the dust container base before using the vacuum cleaner.

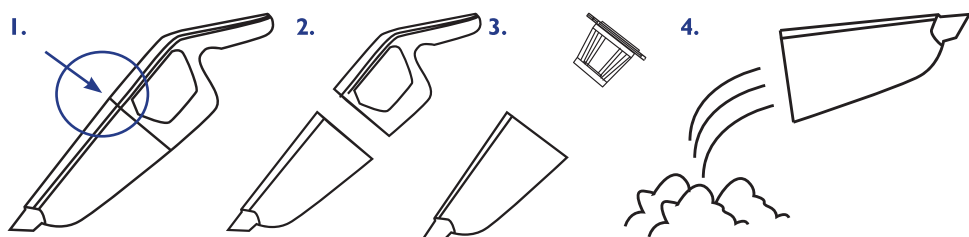

Cleaning the HEPA Filter

It is important to keep the HEPA filter free from dust and dirt, to allow air to flow freely around the vacuum cleaner. This will help to preserve suction and prolong the life of the vacuum cleaner. The HEPA filter can only be accessed when the dust container is open.

STEP 1: Open and empty the dust container following the instructions in the section entitled 'Emptying the Dust Container'.

STEP 2: To clean the HEPA filter, hold it over a waste bin, preferably outdoors and gently shake off any dust and dirt. Once the majority of the dust and dirt has been removed, rinse away any residue by running the HEPA filter under cold water. Allow it to dry thoroughly.

STEP 3: Once the HEPA filter has fully dried, refit it, along with the dust container following the instructions in the section entitled 'Emptying the Dust Container'.

Note: It is recommended that the HEPA filter be cleaned at least once a month with clean water to keep the vacuum cleaner performing at its best. Do not clean the HEPA filter using detergents or use external heat sources such as radiators to dry it.

Warning: Do not reassemble or use the vacuum cleaner until the HEPA filter is fully dry, as this could cause damage.

Cleaning the Exhaust Filter

STEP 1: Before cleaning the exhaust filter, check that the vacuum cleaner is switched off and unplugged from the mains power supply.

STEP 2: Remove the exhaust filter cover by pushing the tab in and lifting it away from the vacuum cleaner main body.

STEP 3: Slide the exhaust filter sponge and the exhaust filter holder out from the vacuum cleaner main body.

STEP 4: Separate the exhaust filter sponge and the exhaust filter holder. Clean the exhaust filter sponge by running it under cold water. Allow it to dry thoroughly.

STEP 5: Once the exhaust filter sponge has fully dried, put it back into the exhaust filter holder and slide it into the vacuum cleaner main body. Replace the exhaust filter cover.

Note: Do not wring the exhaust filter sponge.

Storage

The vacuum cleaner can be stored with ease by using the foldable handle; simply press the foldable handle release button and carefully push the foldable handle down towards the back of the vacuum cleaner main body.

Check that the vacuum cleaner is cool, clean and dry before storing in a cool, dry place.

The cord can be wrapped around the upper and lower cord storage hooks for storage.

Troubleshooting

Symptom	Possible Cause	Solution
The suction is poor.	The suction nozzle is blocked.	Disconnect the attachment from the suction nozzle and remove the blockage.
	The dust container is almost full.	Empty the dust container following the instructions in the section entitled 'Emptying the Dust Container'.
	The HEPA filter is blocked.	Clean the HEPA filter following the instructions in the section entitled 'Cleaning the HEPA Filter'.
The vacuum cleaner has cut out.	The thermal cut-out device has activated due to restricted airflow around the unit and has cut power to the motor to protect the vacuum cleaner.	Switch off and unplug the vacuum cleaner from the mains power supply. Empty the dust container and clean the HEPA filter following the instructions in the section entitled 'Cleaning the Dust Container and HEPA Filter'. Allow the vacuum cleaner to cool for approx. 1 hour.

Specifications

Product code: BEL0811

Input: 220–240 V ~ 50–60 Hz

Output: 600 W

Connection to the mains

Please check that the voltage indicated on the product corresponds with your supply voltage.

Important

As the colours in the mains lead of this appliance may not correspond with the coloured markings identifying the terminals in your plug, please proceed as follows:

The wires in the mains lead are coloured in accordance with the following code:

Blue Neutral (N)

Brown Live (L)

FOR UK USE ONLY - Plug fitting details
(where applicable).

The wire coloured BLUE is the NEUTRAL and must be connected to the terminal marked N or coloured BLACK.

The wire coloured BROWN is the LIVE wire and must be connected to the terminal marked L or coloured RED.

On no account must either the BROWN or the BLUE wire be connected to the EARTH terminal (\perp).

Always ensure that the cord grip is fastened correctly.

The plug must be fitted with a fuse of the same rating already fitted and conforming to BS 1362 and be ASTA approved.

If in doubt consult a qualified electrician who will be pleased to do this for you.

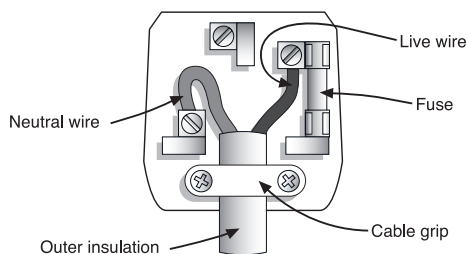

Non-rewireable mains plug

If your appliance is supplied with a non-rewireable plug fitted to the mains lead and should the fuse need replacing, you must use an ASTA approved one (conforming to BS 1362 of the same rating).

If in doubt, consult a qualified electrician who will be pleased to do this for you.

If you need to remove the plug - DISCONNECT IT FROM THE MAINS and then cut it off the mains lead and immediately dispose of it safely. Never attempt to reuse the plug or insert it into a socket outlet as there is a danger of an electric shock.

UP Global Sourcing UK Ltd.,

Victoria Street, Manchester OL9 0DD. UK.

If this product does not reach you in an acceptable condition please contact our Customer Services Department by one of the following methods:

Telephone: +44 (0)333 577 9820*

*Telephone lines are open Monday–Friday, 9 am–5 pm (Closed Bank Holidays)

Email: customersupport@beldray.com

Fax: 0161 628 2126

Please have your delivery note to hand as details from it will be required.

If you wish to return this product please return it to the retailer from where it was purchased with your receipt (subject to their terms and conditions).

Guarantee

All products purchased as new carry a manufacturer's guarantee; the time period of the guarantee will vary dependent upon the product. Where reasonable proof of purchase can be provided, Beldray will provide a standard 12 month guarantee with the retailer from the date of purchase. This is only applicable when products have been used as instructed for their intended, domestic use. Any misuse or dismantling of products will invalidate any guarantee.

Under the guarantee, we undertake to repair or replace free of any charge any parts found to be defective. In the event that we cannot provide an exact replacement, a similar product will be offered or the cost refunded. Any damages from daily wear and tear are not covered by this guarantee, nor are consumables such as plugs, fuses etc.

Please note that the above terms and conditions may be updated from time to time and we therefore recommend that you check these each time you revisit the website.

Nothing in this guarantee or in the instructions relating to this product excludes, restricts or otherwise affects your statutory rights.

The crossed out wheelie bin symbol on this item indicates that this appliance needs to be disposed of in an environmentally friendly way when it becomes of no further use or has worn out. Contact your local authority for details of where to take the item for recycling.



3
YEAR
GUARANTEE

* To be eligible for the extended guarantee, go to <http://guarantee.upgs.com/beldray> and register your product within 30 days of purchase.



Find us on 

www.facebook.com/Beldray



Manufactured by:
UP Global Sourcing UK Ltd.,
Victoria Street, Manchester OL9 0DD. UK
+44 (0)333 577 9820
customersupport@beldray.com

©Beldray Trademark. All rights reserved.

Please retain all instructions for future reference.
Made in China.

CDI30718/MD000000/V1

