

Beldray[®]

est 1872

Our powerful,
**compact &
versatile
carpet cleaner**



**CLEAN &
REFRESH**
CARPET CLEANER
INSTRUCTION MANUAL



www.beldray.com

Please read all of the instructions carefully and retain for future reference.

Safety Instructions

When using electrical appliances, basic safety precautions should always be followed.

Check that the voltage indicated on the rating plate corresponds with that of the local network before connecting the appliance to the mains power supply.

Children aged from 8 years and people with reduced physical, sensory or mental capabilities or lack of experience and knowledge can use this appliance, only if they have been given supervision or instruction concerning use of the appliance in a safe way and understand the hazards involved.

Children should be supervised to ensure that they do not play with the appliance.

Unless they are older than 8 and supervised, children should not perform cleaning or user maintenance.

This appliance is not a toy.

This appliance contains no user serviceable parts. If the power supply cord, plug or any part of the appliance is malfunctioning or if it has been dropped or damaged, do not use. Only a qualified electrician should carry out repairs. Improper repairs may place the user at risk of harm.

Keep the appliance and its power supply cord out of the reach of children.

Keep the appliance out of the reach of children when it is switched on or cooling down.

Keep the appliance and its power supply cord away from heat or sharp edges that could cause damage.

Keep the appliance away from other heat emitting appliances.

Keep the appliance free from dust, lint, hair or anything that may reduce the airflow of the appliance.

Do not immerse the appliance in water or any other liquid.

Do not operate the appliance with wet hands.

Do not expose the appliance to rain.

Do not leave the appliance unattended whilst connected to the mains power supply.

Do not remove from the mains power supply by pulling the cord; switch off and remove the plug by hand.

Do not pull or carry the appliance by its power supply cord.

Do not use the appliance if it has been dropped or if there are visible signs of damage.

Do not use the appliance for anything other than its intended use.

Do not use any parts/accessories other than those supplied with this appliance, as this may cause damage.

Do not use any damaged accessories.

Do not use this appliance outdoors.

Do not store the appliance in direct sunlight or in high humidity conditions.

Do not use this appliance if any of the openings are blocked.

Do not use the appliance to pick up flammable liquid, matches, cigarette ends, hot ashes or any hot, burning or smoking objects.

Do not use this appliance to pick up hard, sharp objects such as glass or nails etc.

Take care when equipping accessories with rotating parts as this could cause entrapment.

Switch off the appliance and disconnect it from the mains power supply before changing or fitting accessories and before any cleaning or maintenance.

Always ensure that the appliance has cooled fully after use before performing any cleaning or user maintenance.

Use of an extension cord with the appliance is not recommended.

This appliance should not be operated by means of an external timer or separate remote control system.

This appliance is intended for domestic use only. It should not be used for commercial purposes.

Care and Maintenance

Before attempting any cleaning or maintenance, always switch off and unplug the carpet cleaner from the mains power supply.

Drain any remaining water from the clean and dirty water tanks.

Wipe the carpet cleaner with a soft, damp cloth and dry thoroughly.

Do not immerse the carpet cleaner main body in water or any other liquid.

Do not use harsh or abrasive cleaning detergents or scourers.

Description of Parts

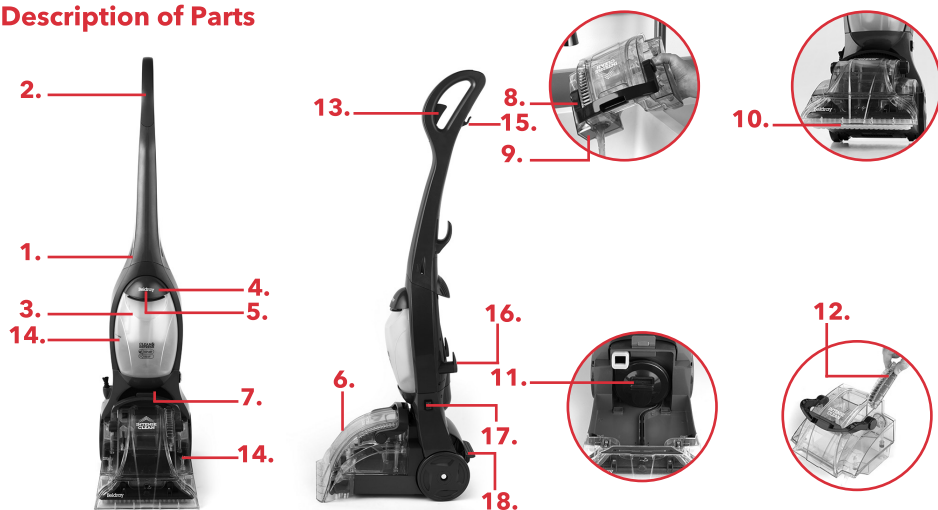

1. Carpet Cleaner main body
2. Handle
3. Clean water tank
4. Clean water tank handle
5. Clean water tank release catch
6. Dirty water tank
7. Dirty water tank release catch
8. Dirty water tank handle
9. Dirty water tank cap
10. Brush bar

11. Pre-motor filter
12. Dirty water tank filter
13. Water/detergent trigger
14. Max. fill mark
15. Cord hook
16. Lower cord hooks
17. Power switch
18. Handle release pedal

Instructions for Use

Assembling the Carpet Cleaner

STEP 1: Stand the carpet cleaner main body upright; remove the fixing screws from the top of the main body.

STEP 2: Place the handle onto the main body with the water/detergent trigger facing backwards.

STEP 3: Using a cross-headed screwdriver (not provided) and the 2 screws, secure the handle into place.

Warning: Do not plug the carpet cleaner in or use it until fully assembled.

Filling the Clean Water Tank

STEP 1: Remove the clean water tank by pressing the clean water tank release button and lifting away from the main body.

STEP 2: Open the clean water tank by unscrewing the cap in an anticlockwise direction. Fill the clean water tank with water or dilute detergent, following the manufacturer's guidelines, checking that the max. fill mark is not exceeded.

STEP 3: Secure the cap back into place by screwing in a clockwise direction, then replace the clean water tank into the main body with the clean water tank cap facing downwards. It should click into place.

Note: Do not use the carpet cleaner without the clean water tank in position. Do not operate product if clean water tank is empty.

Caution: Do not attempt to remove/replace the clean water tank whilst the carpet cleaner is turned on.

Do not press the water/detergent trigger if the clean water tank is empty.

Using the Carpet Cleaner

Before cleaning the carpet, test for colourfastness. Dampen a white cloth with cleaning solution and warm water. In a small hidden area of the carpet, gently rub the surface of the carpet. Wait for 10 minutes then check for colour bleeding. If the cloth remains clean, the carpet should be fine.

STEP 1: Vacuum/sweep the area to be cleaned thoroughly. The carpet cleaner is not designed to be used as a dry vacuum cleaner and pick up debris.

STEP 2: Fill the clean water tank following the instructions in 'Filling the Clean Water Tank'.

STEP 3: Turn on the carpet cleaner by pressing the power switch to the on position.

STEP 4: Lightly step on the handle release pedal to disengage the handle lock, pull the handle backwards and angle the carpet cleaner, as desired.

STEP 5: To begin cleaning, move the carpet cleaner backwards whilst pressing the water/detergent trigger. Release the trigger and push the carpet cleaner forwards to remove the dirty water. Repeat if necessary.

STEP 6: Once finished, turn off the carpet cleaner by pressing the power switch and unplugging it from the mains power supply.

Note: The carpet may be damp after the carpet cleaner has been used. Allow to dry completely before walking on the carpet. This may take up to 4-6 hours depending on air circulation and conditions.

Caution: Do not allow the dirty water tank to exceed the max. fill mark; this will affect the suction of the unit and leave dirty water on the floor.

Emptying the Dirty Water Tank

STEP 1: Make sure that the carpet cleaner is switched off and unplugged from the mains power supply.

STEP 2: Push the dirty water tank release catch and lift the dirty water tank away from the main body.

STEP 3: Rotate the dirty water tank cap anticlockwise to the unlocked position and remove.

STEP 4: Empty the contents of the dirty water tank.

STEP 5: Rinse the dirty water tank under clean running water and replace the dirty water tank cap. Twist clockwise to the locked position to secure in place. Refit the dirty water tank back into the main body of the carpet cleaner; fit the front end of the tank first then click the handle into place.

Note: Make sure that the max. fill mark is not exceeded on the dirty water tank.

Cleaning the Filters

There are two filters in the carpet cleaner that must be cleaned regularly to maintain performance. The dirty water tank filter is located in the top of the dirty water tank. The pre-motor filter is located on top of the air inlet and can be accessed by removing the dirty water tank.

Both filters should be rinsed under warm water and allowed to dry thoroughly before being replaced into the carpet cleaner.

Automatic Shut Off

If the air inlet becomes blocked or the dirty tank is overfilled, the carpet cleaner may overheat, which will cause the thermal cut-out device to activate. If this occurs, turn off and unplug the carpet cleaner from the mains power supply. Proceed to empty the dirty water tank, clean both filters and allow the carpet cleaner to cool for approx. 1 hour.

Storage

Empty the clean water tank and the dirty water tank.

Check that the carpet cleaner is clean and dry before storing in a cool, dry place.

Hints & Tips

1. When cleaning a large area, move the furniture away from the cleaning area. If this is not possible, place aluminium foil under the furniture legs. This will prevent any wood finishes from staining your carpet.
2. Stain removal varies with the type of stain, the time passed before removal and carpet type/material. Heavily soiled areas may have to be pre-treated before using the carpet cleaner.
3. For best cleaning results, use a slow and steady forwards and backwards motion.

Troubleshooting

Symptom	Possible Cause	Solution
The carpet cleaner will not turn on.	The cleaner is not plugged in.	Make sure the carpet cleaner is plugged in and switched on at the mains power supply.
	The cleaner is not switched on.	Press the power switch to the on position.
The carpet cleaner will not suck up water.	The dirty water tank max. fill has been exceeded.	Follow the instructions in the section entitled 'Emptying the Dirty Water Tank'.
	The pre-motor filter is clogged.	Clean the pre-motor filter in warm water.
Solution is not dispensing from the clean water tank.	The clean water tank is not fitted securely.	Follow the instructions in the section entitled 'Filling the Clean Water Tank'.
The carpet is too wet.	Too much water/detergent has been used on the carpet.	Use less water/detergent on the carpet area. Run the carpet cleaner over the carpet, without pressing the trigger, to vacuum excess water.

Specifications

Product code: BEL01040

Input: 220-240 V ~ 50/60 Hz

Output: 600 W

Clean water tank capacity: 1.5 L

Dirty water tank capacity: 1.6 L

IPX4

Connection to the mains

Please check that the voltage indicated on the product corresponds with your supply voltage.

Important

As the colours in the mains lead of this appliance may not correspond with the coloured markings identifying the terminals in your plug, please proceed as follows:

The wires in the mains lead are coloured in accordance with the following code:

Blue Neutral (N)

Brown Live (L)

FOR UK USE ONLY - Plug fitting details
(where applicable).

The wire coloured BLUE is the NEUTRAL and must be connected to the terminal marked N or coloured BLACK.

The wire coloured BROWN is the LIVE wire and must be connected to the terminal marked L or coloured RED.

On no account must either the BROWN or the BLUE wire be connected to the EARTH terminal (\perp).

Always ensure that the cord grip is fastened correctly.

The plug must be fitted with a fuse of the same rating already fitted and conforming to BS 1362 and be ASTA approved.

If in doubt consult a qualified electrician who will be pleased to do this for you.

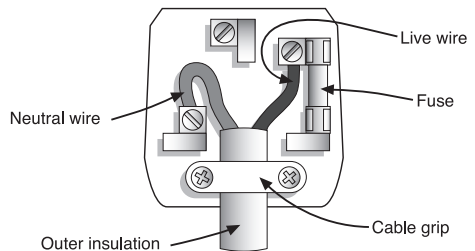

Non-rewireable mains plug

If your appliance is supplied with a non-rewireable plug fitted to the mains lead and should the fuse need replacing, you must use an ASTA approved one (conforming to BS 1362 of the same rating).

If in doubt, consult a qualified electrician who will be pleased to do this for you.

If you need to remove the plug - DISCONNECT IT FROM THE MAINS and then cut it off the mains lead and immediately dispose of it safely. Never attempt to reuse the plug or insert it into a socket outlet as there is a danger of an electric shock.

UP Global Sourcing UK Ltd., Victoria Street, Manchester OL9 0DD. UK.

If this product does not reach you in an acceptable condition please contact our Customer Services Department at **www.beldray.com**

Please have your delivery note to hand as details from it will be required.

If you wish to return this product please return it to the retailer from where it was purchased with your receipt (subject to their terms and conditions).

Guarantee

All products purchased as new carry a manufacturer's guarantee; the time period of the guarantee will vary dependent upon the product. Where reasonable proof of purchase can be provided, Beldray will provide a standard 12 month guarantee with the retailer from the date of purchase. This is only applicable when products have been used as instructed for their intended, domestic use. Any misuse or dismantling of products will invalidate any guarantee.

Under the guarantee, we undertake to repair or replace free of any charge any parts found to be defective. In the event that we cannot provide an exact replacement, a similar product will be offered or the cost refunded. Any damages from daily wear and tear are not covered by this guarantee, nor are consumables such as plugs, fuses etc.

Please note that the above terms and conditions may be updated from time to time and we therefore recommend that you check these each time you revisit the website.

Nothing in this guarantee or in the instructions relating to this product excludes, restricts or otherwise affects your statutory rights.

The crossed out wheelie bin symbol on this item indicates that this appliance needs to be disposed of in an environmentally friendly way when it becomes of no further use or has worn out. Contact your local authority for details of where to take the item for recycling.





*To be eligible for the extended guarantee, go to www.beldray.com and register your product within 30 days of purchase.

Find us on 

www.facebook.com/Beldray

Manufactured by:
UP Global Sourcing UK Ltd.,
Victoria Street, Manchester OL9 0DD. UK

www.beldray.com

©Beldray Trademark. All rights reserved.

Please retain instructions for future reference.

Made in China.



CD200420/MD000000/V1