

Beldray[®] est 1872

Our **cordless,**
powerful & lightweight
vacuum cleaner



ROLLER CORDLESS INSTRUCTION MANUAL



www.beldray.com

Please read all of the instructions carefully and retain for future reference.

Safety Instructions

When using electrical appliances, basic safety precautions should always be followed.

Check that the voltage indicated on the rating plate corresponds with that of the local network before connecting the appliance to the mains power supply.

Children aged from 8 years and people with reduced physical, sensory or mental capabilities or lack of experience and knowledge can use this appliance, only if they have been given supervision or instruction concerning use of the appliance in a safe way and understand the hazards involved.

Children should be supervised to ensure that they do not play with the appliance.

Unless they are older than 8 and supervised, children should not perform cleaning or user maintenance.

This appliance is not a toy.

This appliance contains no user serviceable parts. If the power supply cord, plug or any part of the appliance is malfunctioning or if it has been dropped or damaged, only a qualified electrician should carry out repairs. Improper repairs may place the user at risk of harm.

Keep the appliance out of the reach of children.

Keep the appliance out of the reach of children when it is switched on or cooling down.

Keep the appliance away from heat or sharp edges that could cause damage.

Keep the appliance away from other heat emitting appliances.

Keep the appliance free from dust, lint, hair or anything that may reduce the airflow of the appliance.

Do not immerse the appliance in water or any other liquid.

Do not operate the appliance with wet hands.

Do not expose the appliance to rain.

Do not remove from the adaptor from the mains power supply by pulling the cord; switch off and remove the plug by hand.

Do not use the adaptor to recharge non-rechargeable batteries.

Do not use the appliance if it has been dropped or if there are visible signs of damage.

Do not use the appliance for anything other than its intended use.

Do not use any parts/accessories or adaptors other than those supplied with this appliance, as this may cause damage.

Do not use any damaged accessories or adaptors.

Do not use this appliance outdoors.

Do not store the appliance in direct sunlight or in high humidity conditions.

Do not use this appliance if any of the openings are blocked.

Do not use the appliance to pick up flammable liquid, matches, cigarette ends, hot ashes or any hot, burning or smoking objects.

Do not use this appliance to pick up hard, sharp objects such as glass or nails etc.

Do not use the appliance to pick up water or any other liquid, as this poses risk of an electric shock.

The hose should be checked regularly and must not be used if damaged.

Take care when equipping accessories with rotating parts as this could cause entrapment.

Switch off the appliance and disconnect it from the mains power supply before changing or fitting accessories.

Always ensure that the appliance has cooled fully after use before performing any cleaning or user maintenance.

Use of an extension cord with the appliance is not recommended.

Only use the appliance with the power supply unit provided.

This appliance should not be operated by means of an external timer or separate remote control system.

This appliance is intended for domestic use only. It should not be used for commercial purposes.

Caution: The extension tube and flexible hose contain electrical connections. Do not use to suck up water. Do not immerse in water for cleaning. The extension tube and flexible hose should be checked regularly and must not be used if damaged.

Battery Safety

The supply terminals are not to be short-circuited.

In the event of a battery pack leaking, do not allow the liquid to come in contact with the skin or eyes. If contact has been made, wash the affected area with copious amounts of water and seek medical advice.

Secondary cells and batteries need to be charged before use.

After extended periods of storage, it may be necessary to charge and discharge the battery pack several times to obtain maximum performance.

Do not leave a battery pack on prolonged charge when not in use.

Do not use any charger other than that specifically provided for use with the appliance.

Do not use any cell or battery which is not designed for use with the appliance.

Keep batteries out of the reach of children.

Do not dispose of batteries in a fire.

Do not dismantle, open or shred battery pack.

Do not expose cells or batteries to heat or fire.

Do not crush, puncture, dismantle or otherwise damage the battery pack.

Do not store above 60 °C.

Avoid storage in direct sunlight.

Do not expose battery pack to heat or fire as they may explode.

Do not subject the battery pack to mechanical shock.

Do not dispose of an exhausted battery pack in household waste.

To dispose of the exhausted battery pack, take it to a local recycling station. Contact the local government offices for further details.

This appliance is fitted with a 29.6 V 2200 mAh Li-ion rechargeable battery pack.

Dos and Don'ts

Do:

Check that the HEPA filter is kept clear of obstruction. Make sure that the dust container and HEPA filter are cleaned regularly to preserve suction and prolong the life of the vacuum cleaner.

Don't:

Use the vacuum cleaner without the HEPA filter, filter cone or dust container in position.

Use the vacuum cleaner to pick up flammable liquid, matches, cigarette ends, hot ashes or any hot, burning or smoking objects.

Use the vacuum cleaner to pick up water or any other liquid, as this poses risk of an electric shock.

Care and Maintenance

Wipe the external surface of the vacuum cleaner with a soft, damp cloth and allow to dry thoroughly.

Do not use any harsh or abrasive detergents cleaning agents to clean any part of the vacuum cleaner.

Keep the HEPA filter clean and replace when it becomes worn.

Description of Parts

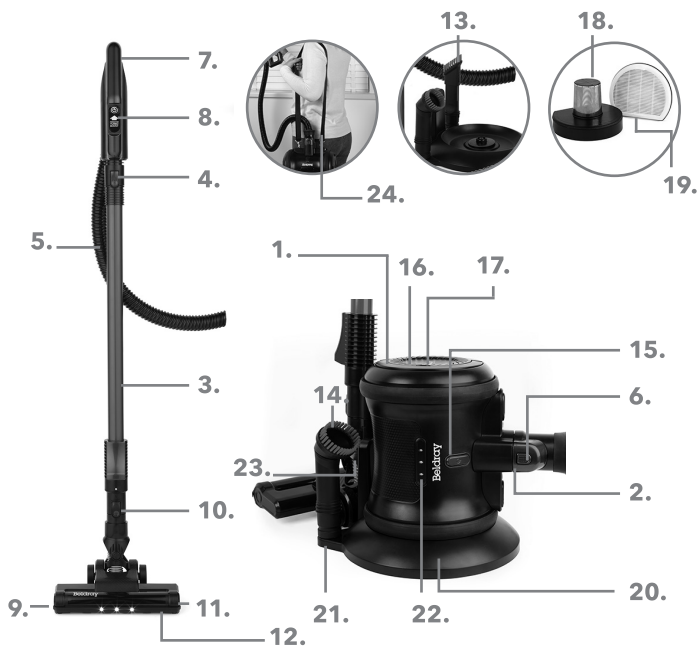

- | | |
|------------------------------------|-----------------------------------|
| 1. Cordless Cylinder Vac main unit | 14. Round brush tool |
| 2. Air inlet | 15. Power button |
| 3. Extension tube | 16. Dust container |
| 4. Accessory release button | 17. Dust container release button |
| 5. Suction hose | 18. Filter cone |
| 6. Suction hose release button | 19. HEPA filter |
| 7. Suction hose handle | 20. Charging base |
| 8. Speed button | 21. Charging port |
| 9. Floor brush | 22. LED indicator light |
| 10. Floor brush release button | 23. Storage hook |
| 11. Brush bar | 24. Carry strap |
| 12. Brush bar release tab | 25. Dust container handle |
| 13. 2 in 1 crevice and brush tool | |

Instructions for Use

Before First Use

Before using the vacuum cleaner for the first time, clean the exterior surface with a soft, damp cloth and dry thoroughly.

Do not immerse the vacuum cleaner in water or any other liquid.

Charging the Cordless Cylinder Vac

Before first use, the vacuum cleaner must be charged for approx. 4 hours. Subsequent charging times will vary dependent upon use. If the vacuum cleaner battery becomes drained completely during use, it may take up to 4 hours to fully recharge.

STEP 1: Check that the vacuum cleaner is switched off.

STEP 2: Secure the vacuum cleaner on the charging base and connect the mains power adaptor to the charging port.

STEP 3: Plug the mains power adaptor into the mains power supply; the LED indicator light will flash during charging and remain illuminated once the battery is fully charged.

Note: Whilst charging, the vacuum cleaner main unit may become warm. Always make sure that the mains power adaptor is unplugged from the mains power supply once the battery is fully charged.

Warning: Do not use any mains power adaptor other than that supplied. Using an alternative increases the risk of damage to the vacuum cleaner and injury to the user.

Assembling the Cordless Cylinder Vac

Before fitting any accessories into the air inlet, make sure the vacuum cleaner is switched off and disconnected from the mains power supply.

STEP 1: To attach the suction hose, insert the suction hose lock into the air inlet so it clicks into place.

STEP 2: To remove the suction hose, press the suction hose release button and pull away from the air inlet.

Using the Cordless Cylinder Vac

The vacuum cleaner can either be used as a cylinder vacuum or as a portable vacuum cleaner, enabling easy manoeuvrability around the house.

STEP 1: Make sure the vacuum cleaner is switched off and disconnected from the charging base.

If using as a cylinder vacuum cleaner, place the main unit horizontally on the floor so the wheels can rotate.

If using as a portable vacuum cleaner, clip both ends of the carry strap onto the main unit, at either side of the air inlet. The length of the carry strap can be adjusted.

STEP 2: Attach the suction hose by following the instructions in the section entitled 'Assembling the Vacuum Cleaner'.

STEP 3: Turn on the vacuum cleaner by pressing the power button; press the speed button on the suction hose handle for the max. power setting, press again for the min. power setting.

STEP 4: To turn off the vacuum cleaner, press the power button or hold down the speed button for approx. 5 seconds.

Warning: Do not use the vacuum cleaner without the HEPA filter and filter cone in position. The dust container must be closed before use. Clean the HEPA filter regularly to preserve the suction of the vacuum cleaner.

If using as a portable vacuum cleaner, ensure the carry strap is securely attached to the main unit before lifting.

Using the Extension Tube and Floor Brush

The extension tube can be fitted onto the suction hose to extend reach, ideal for floor-to-ceiling cleaning.

STEP 1: If required, fit the extension tube onto the suction hose by aligning the pins and carefully pushing the extension tube towards the suction hose until it clicks into position. To release the extension tube, press the accessory release button and pull it away from the suction hose.

STEP 2: Attach the floor brush by aligning the pins on the floor brush with the bottom of the extension tube. Carefully push together to secure into place. To release the floor brush, press the floor brush release button and pull it away from the extension tube.

STEP 3: Turn on the vacuum cleaner by pressing the power button.

Using the 2 in 1 Crevice and Brush Tool

The 2 in 1 crevice and brush tool is ideal for removing dust and dirt from folds in fabrics, radiators, and hard-to-reach areas, as well as shelves, cupboards and windowsills.

STEP 1: If required, fit the extension tube onto the suction hose following the instructions in the section entitled 'Using the Extension Tube and Floor Brush'.

STEP 2: Push the chosen accessory onto the end of the extension tube so it clicks into place. If no extension is required, push the chosen accessory directly onto the suction hose until secure.

STEP 3: To use the 2 in 1 crevice and brush tool, slide the brush bar back for the crevice tool, ideal for removing dust and dirt from corners and recesses, and slide the brush bar forward for the brush tool, perfect for cleaning upholstery and fabrics.

STEP 4: To remove the accessory, press the accessory release button and pull it away from the end of the extension tube or the suction hose.

Emptying the Dust Container

When the dust container has reached max. capacity, the LED indicator lights will flash for ten seconds and then the vacuum cleaner will switch off.

Before emptying the dust container, make sure the vacuum cleaner is switched off and remove any accessories from the air inlet.

It is recommended to empty the dust container outdoors and after each use.

STEP 1: Push the dust container release button and pull the dust container handle to lift the dust container out of the vacuum cleaner main unit.

STEP 2: Holding the dust container over a bin or refuse bag, pull the tab on the dust container base to open. Empty the dust container slowly and carefully to reduce the amount of dust released back into the atmosphere.

STEP 3: Close the dust container by pushing the base closed until it clicks into position.

STEP 4: Replace the dust container into the vacuum cleaner main unit and push until it clicks into place.

Note: Always check that the HEPA filter, filter cone and dust container are fitted correctly before using the vacuum cleaner.

Cleaning the HEPA Filter

The HEPA filter can only be accessed when the dust container is open.

STEP 1: Open and empty the dust container following the instructions in the section entitled 'Emptying the Dust Container'.

STEP 2: Once the dust container is empty, remove the dust container lid by twisting it in an anticlockwise direction, then lift away from the dust container.

STEP 3: Lift out the HEPA filter and filter cone from the dust container.

STEP 4: Shake the HEPA filter and filter cone until the majority of the dust has been removed, then rinse under clean, warm water and allow to dry naturally.

STEP 4: Once fully dry, place the filter cone, then the HEPA filter back into the dust container.

STEP 5: Refit the dust container lid and twist in a clockwise direction to lock it securely into place.

STEP 6: Replace the dust container into the vacuum cleaner main unit by aligning the arrows on the dust container release button with the arrows on the vacuum cleaner main unit and pushing until it clicks into place.

Note: Do not clean the HEPA filter or filter cone using detergents or use external heat sources such as radiators to dry them.

Warning: Do not reassemble or use the vacuum cleaner until the HEPA filter and filter cone are fully dry, as this could cause damage.

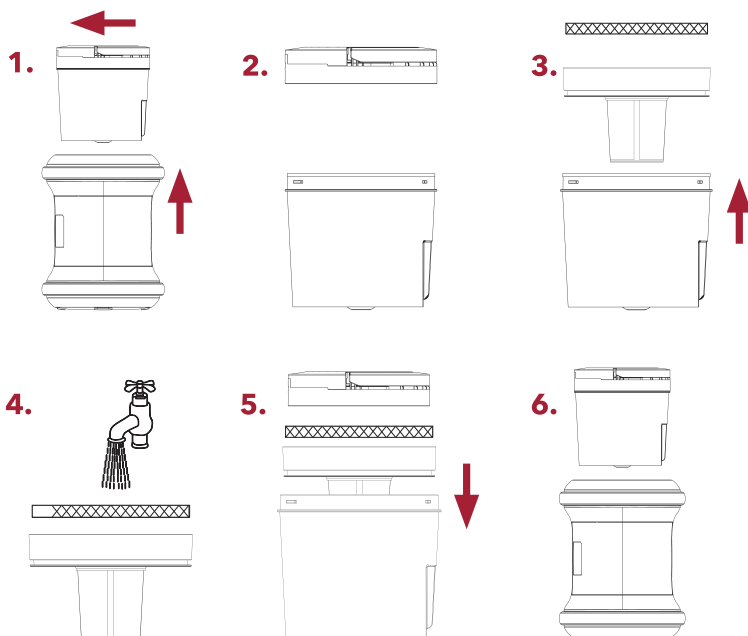

Cleaning the Floor Brush

The floor brush has a removable brush bar for easy cleaning.

STEP 1: Switch off the vacuum cleaner and remove the floor brush by pressing the floor brush release button and pulling it away from the extension tube.

STEP 2: Twist the brush bar release tab to the unlocked position and pull the plastic cover away from the brush bar.

STEP 3: Remove the brush bar by pulling it away from the floor brush.

STEP 4: Clean any built-up dust, debris and hair from the brush bar and floor brush.

STEP 5: Replace the brush bar into the floor brush by aligning it on both sides, then refit the plastic cover and twist the brush bar release tab to the locked position.

Storage

Check that the vacuum cleaner is cool, clean and dry before storing in a cool, dry place. The vacuum cleaner can be neatly stored away after use by securing the vacuum cleaner main unit and accessories onto the charging base.

Troubleshooting

Symptom	Possible Cause	Solution
The vacuum cleaner will not charge.	The mains power adaptor is not securely connected.	Connect the mains power adaptor to the charging port on the charging base following the instructions in the section entitled 'Charging the Cordless Cylinder Vac'.
	The vacuum cleaner is not fitted onto the charging base.	Secure the vacuum cleaner main unit onto the charging
The suction is poor.	The air inlet is blocked.	Switch off the vacuum cleaner and disconnect any accessories, then clear the blockage.
	The dust container is almost full.	Empty the dust container following the instructions in the section entitled 'Emptying the Dust Container'.
	The HEPA filter is blocked.	Clean the HEPA filter following the instructions in the section entitled 'Cleaning the HEPA Filter'.
The brush bar is not rotating.	The brush bar is blocked due to built-up hair, dust and debris.	Clean the floor brush following the instructions in the section entitled 'Cleaning the Floor Brush'.

The vacuum cleaner has turned off.	The vacuum cleaner has run out of charge.	Charge the vacuum cleaner following the instructions in the section entitled 'Charging the Cordless Cylinder Vac'.
	The dust container is full.	Empty the dust container following the instructions in the section entitled 'Emptying the Dust Container'.
	The air inlet is blocked.	Switch off the vacuum cleaner and disconnect any accessories, then clear the blockage.

Specifications

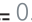
Product code: BEL0993
Battery: 29.6 V 2200 mAh Li-ion
Adaptor Input: 100-240 V ~ 50/60 Hz
Adaptor Output: 36 V  0.5 A 18.0 W
Average active efficiency: 85.91 %
Efficiency at low load (10%): 75.26 %
No load power consumption: < 0.1 W
Dust tank capacity: 500 ml

**UP Global Sourcing UK Ltd.,
Victoria Street, Manchester OL9 0DD. UK.**

If this product does not reach you in an acceptable condition please contact our Customer Services Department at **www.beldray.com**

Please have your delivery note to hand as details from it will be required.

If you wish to return this product please return it to the retailer from where it was purchased with your receipt (subject to their terms and conditions).

Guarantee

All products purchased as new carry a manufacturer's guarantee; the time period of the guarantee will vary dependent upon the product. Where reasonable proof of purchase can be provided, Beldray will provide a standard 12 month guarantee with the retailer from the date of purchase. This is only applicable when products have been used as instructed for their intended, domestic use. Any misuse or dismantling of products will invalidate any guarantee.

Under the guarantee, we undertake to repair or replace free of any charge any parts found to be defective. In the event that we cannot provide an exact replacement, a similar product will be offered or the cost refunded. Any damages from daily wear and tear are not covered by this guarantee, nor are consumables such as plugs, fuses etc.

Please note that the above terms and conditions may be updated from time to time and we therefore recommend that you check these each time you revisit the website.

Nothing in this guarantee or in the instructions relating to this product excludes, restricts or otherwise affects your statutory rights.

The crossed out wheelie bin symbol on this item indicates that this appliance needs to be disposed of in an environmentally friendly way when it becomes of no further use or has worn out. Contact your local authority for details of where to take the item for recycling.





*To be eligible for the extended guarantee, go to www.beldray.com and register your product within 30 days of purchase.

Rechargeable batteries are not included in the extended manufacturer's guarantee (after the first 12 months).

Find us on 

www.facebook.com/Beldray





Manufactured by:
UP Global Sourcing UK Ltd.,
Victoria Street, Manchester OL9 0DD. UK

www.beldray.com

©Beldray Trademark. All rights reserved.

Please retain instructions for future reference.

Made in China.

CD021020/MD091020/V2