

Beldray^{est 1872}[®]

Our, powerful,
flexible & cordless
vacuum cleaner



SMARTFLEX
CORDLESS
INSTRUCTION MANUAL



www.beldray.com

Safety Instructions

When using electrical appliances, basic safety precautions should always be followed.

Check that the voltage indicated on the rating plate corresponds with that of the local network before connecting the appliance to the mains power supply.

Children aged from 8 years and people with reduced physical, sensory or mental capabilities or lack of experience and knowledge can use this appliance, only if they have been given supervision or instruction concerning use of the appliance in a safe way and understand the hazards involved.

Children should be supervised to ensure that they do not play with the appliance.

Unless they are older than 8 and supervised, children should not perform cleaning or user maintenance.

If the power supply cord, plug or any part of the appliance is malfunctioning or if it has been dropped or damaged, cease using the product immediately to avoid potential injury.

This appliance contains no user serviceable parts, only a qualified electrician should carry out repairs. Improper repairs may place the user at risk of harm.

Do not remove the adaptor from the mains power supply by pulling the cord; switch off and remove the plug by hand.

Do not use the adaptor to recharge non-rechargeable batteries or any other appliance.

Do not use the appliance for anything other than its intended use. Take care when equipping accessories with rotating parts as this could cause entrapment.

Switch off the appliance, disconnect it from the mains power supply and allow to cool fully before changing or fitting accessories and before cleaning or user maintenance.

Use of an extension cord with the appliance is not recommended. Only use the appliance with the power supply unit provided.

This appliance should not be operated by means of an external timer or separate remote control system.

This appliance is intended for domestic use only. It should not be used for commercial purposes.

Battery Safety

The supply terminals are not to be short-circuited.

In the event of a battery pack leaking, do not allow the liquid to come in contact with the skin or eyes. If contact has been made, wash the affected area with copious amounts of water and seek medical advice.

Secondary cells and batteries need to be charged before use.

After extended periods of storage, it may be necessary to charge and discharge the battery pack several times to obtain maximum performance.

Do not leave a battery pack on prolonged charge when not in use.

Do not use any charger other than that specifically provided for use with the product.

Do not use any cell or battery which is not designed for use with the product.

Keep batteries out of the reach of children.

Do not crush, puncture, dismantle or otherwise damage batteries.

Do not store above 60 °C.

Avoid storage in direct sunlight.

Do not expose battery packs to heat or fire as they may explode.

Do not subject battery packs to mechanical shock.

Do not dispose of exhausted battery packs in household waste.

Once the batteries have been exhausted, dispose of the product at a local recycling station. Contact the local government offices for further details.

This appliance is fitted with a 25.9 V 2200 mAh Li-ion rechargeable battery.

Care and Maintenance

Always unplug the vacuum cleaner from the mains power supply before attempting any cleaning or maintenance.

Wipe the external surface of the vacuum cleaner with a soft, damp cloth and allow to dry thoroughly.

Do not use any harsh or abrasive detergents or cleaning agents to clean any part of the vacuum cleaner.

Do not immerse the vacuum cleaner in water or any other liquid.

Keep the filter clean after every removal of the dust container.

CAUTION: The flexi tube contains electrical connections. Do not use to suck up water. Do not immerse in water for cleaning. The flexi tube should be checked regularly and must not be used if damaged.

Dos and Don'ts

DO:

Charge the vacuum cleaner fully before use.

Check that the filter is kept clear of obstruction.

Make sure that the dust container and filter are cleaned regularly

DON'T:

Use the vacuum cleaner without the filter, filter cone or dust container in position.

Use the vacuum cleaner to pick up flammable liquid, matches, cigarette ends, hot ashes or any hot, burning or smoking objects.

Use the vacuum cleaner to pick up water or any other liquid, as this poses risk of an electric shock.

Description of Parts



- | | |
|---------------------------------|---|
| 1. Smartflex main unit | 14. Speed button +/- |
| 2. Air inlet | 15. LED screen |
| 3. Flexi tube | 16. Dust container |
| 4. Flexi tube joint button | 17. Dust container base release latch |
| 5. Flexi tube release button | 18. Dust container release button |
| 6. Floor brush | 19. Filter cone |
| 7. Floor brush release button | 20. Filter (qty. 2)/filter holder
(can be separated) |
| 8. Brush bar | 21. Battery pack |
| 9. Brush bar release tab | 22. Battery release catch |
| 10. 2 in 1 brush tool | 23. Battery charging port |
| 11. Crevice tool | 24. Battery LED indicator light |
| 12. Crevice tool release button | 25. Wall mount |
| 13. Power button | |

Instructions for Use

Before First Use

Before using the vacuum cleaner for the first time, clean the exterior surface with a soft, damp cloth and dry thoroughly.

Do not immerse the vacuum cleaner in water or any other liquid.

Charging the Smartflex with the Wall Mount Charging Base

Before first use, the vacuum cleaner must be charged for approx. 5 hours. Subsequent charging times will vary dependent upon use. If the vacuum cleaner battery becomes drained completely during use, it may take up to 5 hours to fully recharge.

STEP 1: Place the vacuum cleaner onto the wall mount charging base by aligning the storage hook on the wall mount with the indent on the dust container.

STEP 2: Connect the mains power adaptor to the battery charging port on the bottom of the wall mount charging base.

STEP 3: Plug the mains power adaptor into the mains power supply; the LED screen will indicate the battery charge percentage level during charging and then show 100 % once the battery is fully charged.

STEP 4: Unplug the mains power adaptor from the mains power supply once the battery is fully charged. Disconnect the mains power adaptor from the wall mount charging base.

NOTE: Whilst charging, the battery pack may become warm. Always make sure that the mains power adaptor is unplugged from the mains power supply once the battery is fully charged.

WARNING: Do not use any mains power adaptor other than that supplied. Using an alternative will increase the risk of damage to the vacuum cleaner or injury to the user.

Charging the Smartflex without the Wall Mount

STEP 1: Remove the battery pack from the main unit by pushing the battery release catch and sliding away from the vacuum cleaner main unit.

STEP 2: Connect the mains power adaptor to the battery charging port on the battery pack.

STEP 3: Plug the mains power adaptor into the mains power supply; the battery LED indicator light will flash during charging and then remain illuminated once the battery is fully charged.

STEP 4: Unplug the mains power adaptor from the mains power supply once the battery is fully charged. Disconnect the mains power adaptor from the battery charging port on the battery pack.

STEP 5: Insert the battery pack back into the vacuum cleaner main unit.

Using the Smartflex

STEP 1: Make sure the battery pack is securely attached to the vacuum cleaner main unit.

STEP 2: Turn on the vacuum cleaner by pressing the power button. Press the speed button once for the medium power setting, press twice to use the maximum power setting.

STEP 3: To turn off the vacuum cleaner, press the power button.

WARNING: Do not use the vacuum cleaner without the dust container, filter and filter cone in position. The dust container must be closed before use. Clean the filter regularly to preserve the suction of the vacuum cleaner.

Power Settings

Setting	Usage
Low	Ideal for hard floors such as linoleum, wood and vinyl.
Medium	Ideal for short and medium pile carpets.
High	Ideal for high pile carpets.

Using the Flexi Tube and Floor Brush

The flexi tube can be fitted onto the air inlet to extend reach, ideal for floor-to-ceiling cleaning.

STEP 1: Fit the flexi tube onto the air inlet by aligning the clip and carefully pushing the flexi tube towards the main unit until it clicks into position. To release the flexi tube, press the flexi tube release button and pull it away from the vacuum cleaner main unit.

STEP 2: Attach the floor brush by aligning the clip on the floor brush with the bottom of the flexi tube. Carefully push together to secure into place. To release the floor brush, press the floor brush release button and pull it away from the flexi tube.

STEP 3: Turn on the vacuum cleaner by pressing the power button.

STEP 4: To reach under furniture, press the flexi tube joint button. When finished, straighten the tube until it clicks and locks into place.

Floor Brush Blockage Sensor

The floor brush is fitted with a dust blockage sensor; if the brush bar stops spinning during use, the vacuum cleaner will automatically cut out. Ensure the brush bar is kept clear of debris at all times. Follow the instructions in the section entitled 'Cleaning the Floor Brush'.

Filtration Blockage Sensor

The dust container is fitted with a blockage sensor; if the dust container is overfilled during use, the vacuum cleaner will automatically cut out. Ensure the dust container and filter are emptied and cleaned regularly. Follow the instructions in the sections entitled 'Emptying the Dust Container' and 'Cleaning the Filter and Filter Cone'.

Using the Crevice and Brush Tool

STEP 1: If required, fit the flexi tube onto the air inlet following the instructions in the section entitled 'Using the Flexi Tube and Floor Brush'.

STEP 2: Push the crevice or brush tool onto the end of the flexi tube. If no flexi tube is required, push the crevice or brush tool directly onto the air inlet until it clicks into place.

STEP 3: To remove the crevice or brush tool, press the crevice tool release button and pull it firmly away from the end of the flexi tube or the air inlet.

Emptying the Dust Container

To maintain optimum performance, the dust container must be emptied regularly. If there is a reduction in suction power, empty the dust container.

Before emptying the dust container, check that the vacuum cleaner is switched off and any attachments have been removed from the air inlet.

It is recommended to empty the dust container outdoors.

STEP 1: Whilst securely holding the vacuum cleaner main unit, press the dust container base release latch. Empty the dust container slowly and carefully to reduce the amount of dust released back into the atmosphere.

STEP 2: Close the dust container by pushing the base closed until the dust container base release latch locks back into position.

NOTE: Always close the dust container base before using the vacuum cleaner.

Cleaning the Filter and Filter Cone

The filter can only be accessed when the dust container is removed.

STEP 1: After emptying the dust container following the instructions in the section entitled 'Emptying the Dust Container', remove the dust container by pressing both of the dust container rear release buttons at the same time and sliding the dust container away from the main unit.

STEP 2: Lift out the filter/filter holder and pull the filter cone away from the dust container.

STEP 3: Shake the filter until the majority of the dust has been removed, then rinse the filter and filter cone under clean, warm water and allow to dry naturally.

STEP 4: Once both are fully dry, replace the filter/filter holder and filter cone by aligning the indents, and gently push until it locks into place.

STEP 5: Refit the dust container bottom first into the main unit and slot into place until secure.

NOTE: The filter and filter cone should be thoroughly cleaned at least once every two weeks.

Do not clean the filter using detergent or use external heat sources, such as a radiator to dry it.

Always clean the filter and filter cone, only when the dust container is empty.

WARNING: Do not reassemble or use the vacuum cleaner until the filter and filter cone have fully dried, as this could cause damage.

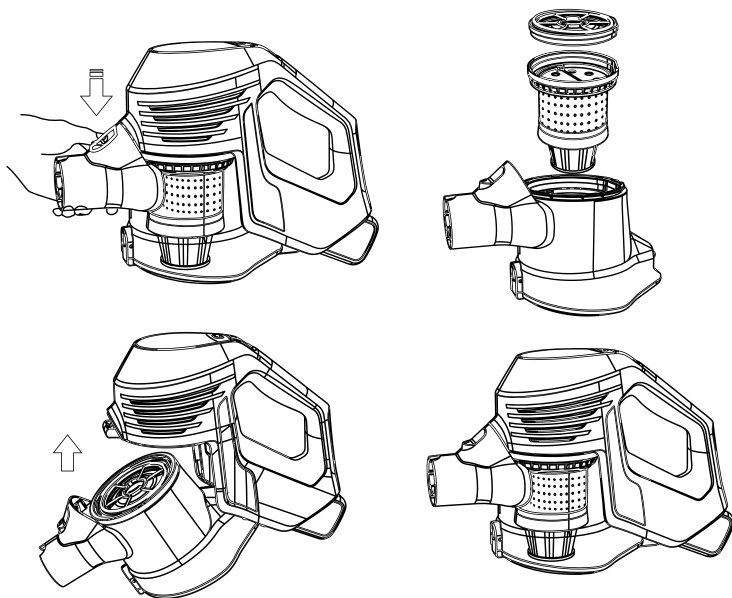

Cleaning the Floor Brush

The floor brush has a removable brush bar for easy cleaning.

STEP 1: Switch off the vacuum cleaner and remove the floor brush by pressing the floor brush release button and pulling it away from the flexi tube.

STEP 2: Slide the brush bar release tab to release the brush bar and lift it out of the floor brush.

STEP 3: Remove any built-up dust, debris and hair from the brush bar and floor brush.

STEP 4: Replace the brush bar into the floor brush by inserting the left side first and pushing the brush bar down into place. Replace the tab and push the release tab back into the locked position.

Removing the Rechargeable Battery Pack

The battery pack can be removed from the vacuum cleaner main unit by pressing the battery release catch and sliding the battery pack out of the main unit. To refit the battery pack, realign it with the main unit and press the release catch down whilst sliding the battery pack into place until it clicks.

Installing the Wall Mount Charging Base

The wall mount charging base can be fixed to a wall for convenient storage. If the vacuum cleaner will be stored whilst it is charging, check that the wall mount charging base is close enough to the mains power supply to avoid overstretching the charging wire; the charging wire is approx. 1.5m.

STEP 1: Using a pencil, mark the positions of 2 screw holes on the desired surface. The gap between the markings should form a straight line.

STEP 2: Using a suitable drill bit, drill pilot holes into the markings. Consult a qualified professional if required.

STEP 3: Firmly place the wall plugs into the pilot holes so that they sit flush with the surface of the wall.

STEP 4: Position the wall mount charging base onto the surface, aligning the holes on the surface with those on the wall mount charging base.

STEP 5: Insert the screws provided through the wall mount charging base and into the wall and tighten so that the wall mount charging base sits flush with the surface. Check that the flat edge of the wall mount charging base is facing upwards.

STEP 6: Slide the vacuum cleaner into position on the wall mount charging base, making sure that it engages with the storage hook.

NOTE: Check that the chosen surface is strong enough to support the wall mount charging base and vacuum cleaner. Make sure that the wall mount charging base is secured at an adequate height to store the fully assembled vacuum cleaner and accessories.

CAUTION: Check that there are no electrical, plumbing or gas supplies situated beneath the surface of the wall. These services normally run vertically or horizontally behind the wall, and the electrical wiring will radiate from the socket, possibly in more than one direction. Testers are available from good DIY stores. Consult a qualified professional if required.

Storage

Check that the vacuum cleaner is cool, clean and dry before storing in a cool, dry place. Never wrap the charging wire tightly around the vacuum cleaner; wrap it loosely to avoid causing damage.

The vacuum cleaner can be neatly stored away after use by securing the main unit onto the wall mount charging base using the storage hook.

Troubleshooting

Symptom	Possible Cause	Solution
The vacuum cleaner will not charge.	The mains power adaptor is not securely connected.	Connect the mains power adaptor to the battery charging port on the battery pack, following the instructions in the section entitled 'Charging the Smartflex without the Wall Mount Charging Base'.
	The vacuum cleaner isn't fully placed onto the wall mount charging base.	Connect the mains power adaptor to the battery charging port on the wall mount charging base, following the instructions in the section entitled 'Charging the Smartflex with the Wall Mount Charging Base'.
The suction is poor.	The air inlet is blocked.	Disconnect the attachment and clear the blockage.
	The dust container is almost full.	Empty the dust container following the instructions in the section entitled 'Emptying the Dust Container'.
	The filter is blocked.	Clean the filter following the instructions in the section entitled 'Cleaning the Filter and Filter Cone'.

The brush bar is not rotating.	The brush bar is blocked due to built-up hair, dust and debris.	Clean the floor brush following the instructions in the section entitled 'Cleaning the Floor Brush'.
The vacuum cleaner has cut out.	<p>The vacuum cleaner has run out of charge.</p> <p>The brush bar is blocked due to built-up hair, dust and debris.</p> <p>The dust container has become full or blocked.</p>	<p>Connect the mains power adaptor to the battery charging port on the vacuum cleaner, following the instructions in the section entitled 'Charging the Smartflex'.</p> <p>Clean the floor brush following the instructions in the section entitled 'Cleaning the Floor Brush'.</p> <p>Clear the blockage in the dust container following the instructions in the section entitled 'Emptying the Dust Container'.</p>

Specifications

Product code: BEL01727

Battery: 25.9 V  2200 mAh Li-ion

Adaptor input: 100-240 V ~ 50/60 Hz 0.5 A

Adaptor output: 31.0 V  0.5 A 15.5 W

Average active efficiency: 86.35 %

Efficiency at low load (10 %): 79.28 %

No-load power consumption: 0.089 W

Dust tank capacity: 1 litre

Rechargeable batteries are not included in the extended manufacturer's guarantee (after the first 12 months).

Notes

**UP Global Sourcing UK Ltd.,
Victoria Street, Manchester OL9 0DD. UK.
Edmund-Rumpler Straße 5, 51149 Köln. Germany.**

If this product does not reach you in an acceptable condition please contact our Customer Services Department at **www.beldray.com**.

Please have your delivery note to hand as details from it will be required.

If you wish to return this product please return it to the retailer from where it was purchased with your receipt (subject to their terms and conditions).

Guarantee

All products purchased as new carry a manufacturer's guarantee; the time period of the guarantee will vary dependent upon the product. Where reasonable proof of purchase can be provided, Beldray will provide a standard 12 month guarantee with the retailer from the date of purchase. This is only applicable when products have been used as instructed for their intended, domestic use. Any misuse or dismantling of products will invalidate any guarantee.

Under the guarantee, we undertake to repair or replace free of any charge any parts found to be defective. In the event that we cannot provide an exact replacement, a similar product will be offered or the cost refunded. Any damages from daily wear and tear are not covered by this guarantee, nor are consumables such as plugs, fuses etc.

Please note that the above terms and conditions may be updated from time to time and we therefore recommend that you check these each time you revisit the website.

Nothing in this guarantee or in the instructions relating to this product excludes, restricts or otherwise affects your statutory rights.

Disposal of Waste Batteries and Electrical and Electronic Equipment



This symbol on the product, its batteries or its packaging means that this product and any batteries it contains must not be disposed of with household waste. Instead, it is the user's responsibility to hand this over to an applicable collection point for the recycling of batteries and electrical and electronic equipment. This separate collection and recycling will help to conserve natural resources and prevent potential negative consequences for human health and the environment due to the possible presence of hazardous substances in batteries and electrical and electronic equipment, which could be caused by inappropriate disposal. Some retailers provide take-back services which allow the user to return exhausted equipment for appropriate disposal.

It is the user's responsibility to delete any data on electrical and electronic equipment prior to disposal. For more information about where to drop batteries, electrical and electronic waste off, please contact the local city/municipality office, household waste disposal service, or the retailer.

To be eligible for the extended guarantee,
go to **<https://guarantee.upgs.com/beldray/>** and
register your product within 30 days of purchase.

Manufactured by:
UP Global Sourcing UK Ltd.,
Victoria Street, Manchester OL9 0DD. **UK.**
Edmund-Rumpler Straße 5, 51149 Köln. **Germany.**

www.beldray.com

©Beldray Trademark. All rights reserved.

CD250423/MD120523/V2

