

# User manual

Garment steamer

---

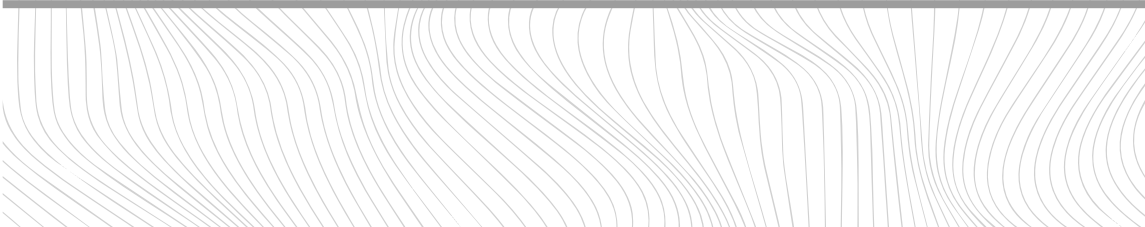
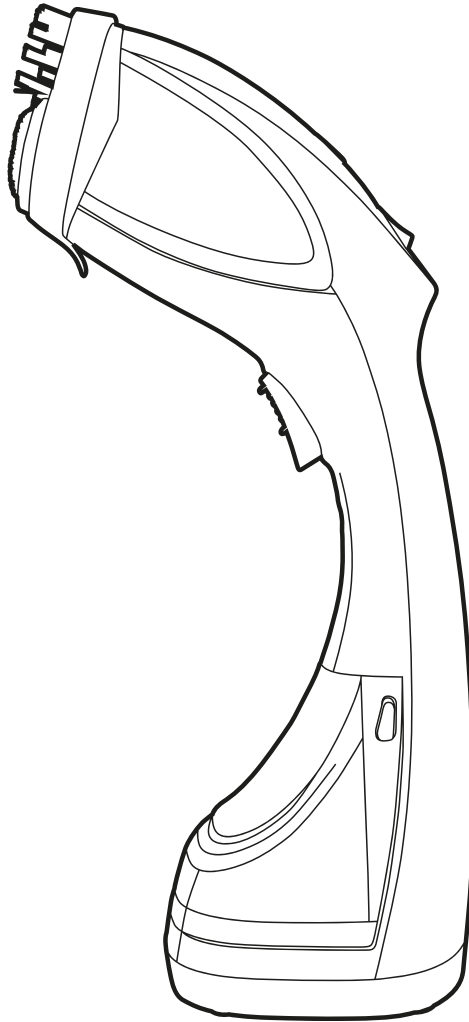

## Description of parts

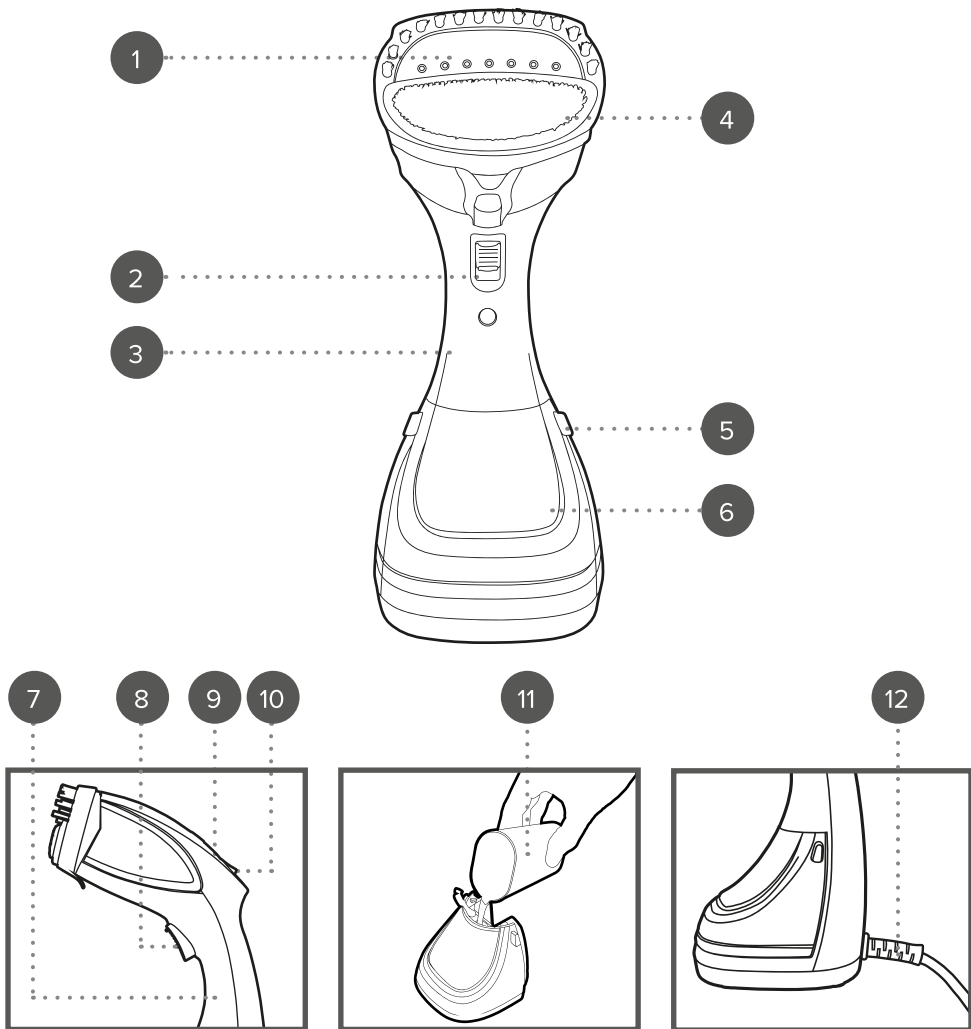

1. Steam head
2. Steam trigger lock
3. Garment steamer main unit
4. 2 in 1 fabric brush
5. Water tank release buttons
6. Water tank

7. Handle
8. Steam trigger
9. Power indicator light
10. Power switch
11. Measuring jug
12. Cord guard

Please retain instructions for future reference.

## **SAFETY INSTRUCTIONS**

- When using electrical appliances, basic safety precautions should always be followed.
- Check that the voltage indicated on the rating plate corresponds with that of the local network before connecting the appliance to the mains power supply.
- Children aged from 8 years and people with reduced physical, sensory or mental capabilities or lack of experience and knowledge can use this appliance, only if they have been given supervision or instruction concerning use of the appliance in a safe way and understand the hazards involved.
- Children should be supervised to ensure that they do not play with the appliance.
- Unless they are older than 8 and supervised, children should not perform cleaning or user maintenance.
- This appliance is not a toy.
- If the power supply cord, plug or any part of the appliance is malfunctioning or if it has been dropped or damaged, cease using the product immediately to avoid potential injury.
- This appliance contains no user serviceable parts, only a qualified electrician should carry out repairs. Improper repairs may place the user at risk of harm.
- Keep the appliance out of the reach of children when it is switched on or cooling down.
- Do not leave the appliance unattended whilst connected to the mains power supply.
- Do not remove the appliance from the mains power supply by pulling the cord; switch it off and remove the plug by hand.
- Do not pull or carry the appliance by its power supply cord.
- Do not use the appliance for anything other than its intended use.
- Do not use any parts/accessories other than those supplied with this appliance.
- Do not direct steam at people or animals or towards equipment containing electrical components, such as the interior of ovens.
- Never add aromatic, alcoholic or detergent products into the appliance, as this may damage the appliance or make it unsafe for use.
- Switch off the appliance and disconnect it from the mains power supply before changing or fitting accessories.
- Always unplug the appliance after use and allow to cool fully before any cleaning or maintenance.
- Use of an extension cord with the appliance is not recommended.
- This appliance should not be operated by means of an external timer or separate remote control system.
- This appliance is intended for domestic use only. It should not be used for commercial purposes.



**CAUTION:** The appliance emits very hot steam; always exercise extreme caution during use. Hot surface – do not touch the hot section or heating components of the appliance.



**WARNING:** Danger of scalding.

## Dos and don'ts

### DO:

Always hold the garment steamer by the handle.

Exercise caution when using the garment steamer, as the surface and steam head will get very hot.

Always follow the garment manufacturer's care instructions.

Allow the garment steamer to cool before removing or attaching the 2 in 1 fabric brush.

### DON'T:

Tip or tilt the garment steamer once it has been filled with water, as this may cause boiling water to leak from the steam head and could cause serious injury.

Hold onto the parts of the garment steamer that get hot during use.

Position the garment steamer too closely to the surface of the fabric or apply too much pressure, as this could cause damage.

Refill the water tank whilst the garment steamer is switched on and plugged into the mains power supply.

Overfill the water tank.

## Care and maintenance

Before attempting any cleaning or maintenance, always unplug the garment steamer from the mains power supply and allow it to cool sufficiently (for approx. 30 minutes).

Drain any remaining water from the water tank once the garment steamer main body has cooled.

Wipe the garment steamer with a soft, damp cloth and allow to dry thoroughly.

Clean the accessories in warm, soapy water; rinse and dry thoroughly.

The garment steamer and its accessories are not suitable for dishwasher use.

Do not use harsh or abrasive cleaners or detergents.

Never immerse the garment steamer in water or any other liquid.

## Descaling the water tank and removing limescale

If living in a hard water area, calcium deposits may begin to build up inside the water tank or accessories. If this occurs, it is recommended to use demineralised water with the garment steamer.

Limescale can develop over time and can affect the performance of the garment steamer. It is recommended to remove limescale at least once a month. Use a limescale removing solution that is suitable for use with a garment steamer. Always follow the manufacturer's instructions.

## Instructions for use

### Before first use

Clean the exterior surface of the garment steamer with a soft, damp cloth and dry thoroughly.

Do not immerse the garment steamer in water or any other liquid.

Allow the garment steamer to steam for approx. 3–4 minutes to remove any impurities that may have been left behind during production.

It is recommended to steam an old piece of cotton prior to steaming the preferred garment, to check that any impurities have been removed.



**NOTE:** When using the garment steamer for the first time, a slight odour may be emitted. This is normal and will soon subside. Allow for sufficient ventilation around the garment steamer when it is in use.

### Using the garment steamer

**STEP 1:** Check that the garment steamer is switched off and unplugged from the mains power supply. If required, attach the 2 in 1 fabric brush to the steam head and click it into place.

**STEP 2:** To remove the water tank, push down the water tank release buttons and pull the water tank firmly away from the garment steamer main body.

**STEP 3:** Lift up the water tank cap and using the measuring jug, fill the water tank with a max. of 180 ml water. Once full replace the water tank cap and refit the water tank.

**STEP 4:** Place the garment steamer onto a flat, stable surface, then plug in and switch on at the mains power supply. Turn on the garment steamer using the power switch. The power indicator light will illuminate red to signal that the garment steamer is preheating.

**STEP 5:** Whilst the garment steamer is preheating, hang the garment to be steamed.

**STEP 6:** After approx. 30 seconds of preheating, the indicator light will switch off, to signal that the garment steamer has reached the required temperature.

**STEP 7:** To begin steaming, press the steam head (with the attachment securely in place, if required) gently against the fabric and press the steam trigger. To use the continuous steam function, press the steam button whilst sliding the steam trigger lock into the “Locked” position. Carefully steam the garment using long, straight, downwards movements to remove any wrinkles or creases.

**STEP 8:** Once the garment has been steamed, turn off the garment steamer by pushing the power switch to the “0” position. Switch off and unplug the garment steamer from the mains power supply.



**NOTE:** Refill the water tank as and when required; one max. fill offers approx. 15 minutes of continuous use. When removing the water tank, take care not to touch the steam head.



**CAUTION:** During operation, the garment steamer will get very hot. Exercise extreme caution. Do not hold the garment steamer by any other part of the unit except the handle. Do not overfill the water tank. Do not use anything other than water to fill the water tank.

## Using the brush attachment

The fabric brush opens the weave of the fabric for deeper steam diffusion. It is ideal for steaming heavier and bulkier items such as car upholstery, curtains, bedding and sofas.



**CAUTION:** Always make sure that the garment steamer has cooled fully before adding or removing the attachment from the steam head.

## Storage

Before storing in a cool, dry place, check that the garment steamer and any accessories are cool, clean and dry.

The water tank should be empty before storage.

Never wrap the cord tightly around the garment steamer; wrap it loosely to avoid causing damage.

## Troubleshooting

| Problem   | Cause   | Solution   |
|---|---|--|
| The garment steamer is not heating up. The power indicator light is not illuminating. | The garment steamer is not plugged into the mains power supply. | Plug in and switch on the garment steamer at the mains power supply and press the power switch.  |
|   | The garment steamer is not switched on.                         | Press the power switch to switch on the garment steamer. The indicator light will illuminate red to signal that the garment steamer is preheating.       |
| No steam is being emitted from the garment steamer.                                   | There is insufficient water remaining in the water tank.        | Ensure that there is enough water in the water tank.   |
|   | The water has not reached the required temperature.             | Plug in the garment steamer at the mains power supply, press the power switch and allow it to preheat sufficiently. This should take approx. 30 seconds. |
| The garment steamer is making an abnormal sound.                                      | The water tank is not securely locked.                          | Make sure that the water tank is securely pushed into place.   |
|   | The water tank is empty.  | Refill the water tank.   |

## Specifications

Product code: BEL01552

Input: 220–240 V ~ 50–60 Hz

Output: 1100 W

Water tank capacity: 180 ml





#### Disposal of Waste Batteries and Electrical and Electronic Equipment



This symbol on the product, its batteries or its packaging means that this product and any batteries it contains must not be disposed of with household waste. Instead, it is the user's responsibility to hand this over to an applicable collection point for the recycling of batteries and electrical and electronic equipment. This separate collection and recycling will help to conserve natural resources and prevent potential negative consequences for human health and the environment due to the possible presence of hazardous substances in batteries and electrical and electronic equipment, which could be caused by inappropriate disposal. Some retailers provide take-back services which allow the user to return exhausted equipment for appropriate disposal. **It is the user's responsibility to delete any data on electrical and electronic equipment prior to disposal.** For more information about where to drop batteries, electrical and electronic waste off, please contact the local city/municipality office, household waste disposal service, or the retailer.

Manufactured by:  
Ultimate Products UK Ltd.,  
Victoria Street, Manchester OL9 0DD. **UK.**  
Ultimate Products Europe Ltd.,  
19 Baggot Street Lower, Dublin D02 X658. **ROI.**

**MADE IN CHINA.**

CD260923/MD000000/V1