

User manual

Spot buster

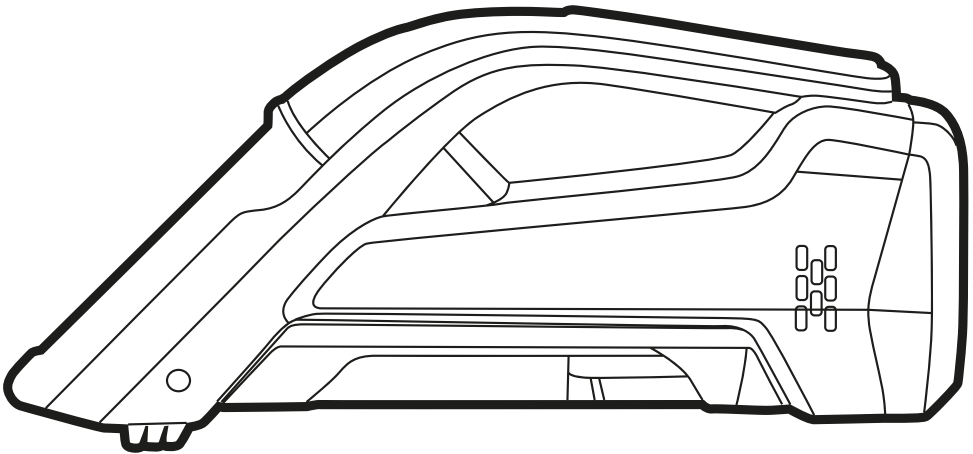

Description of parts

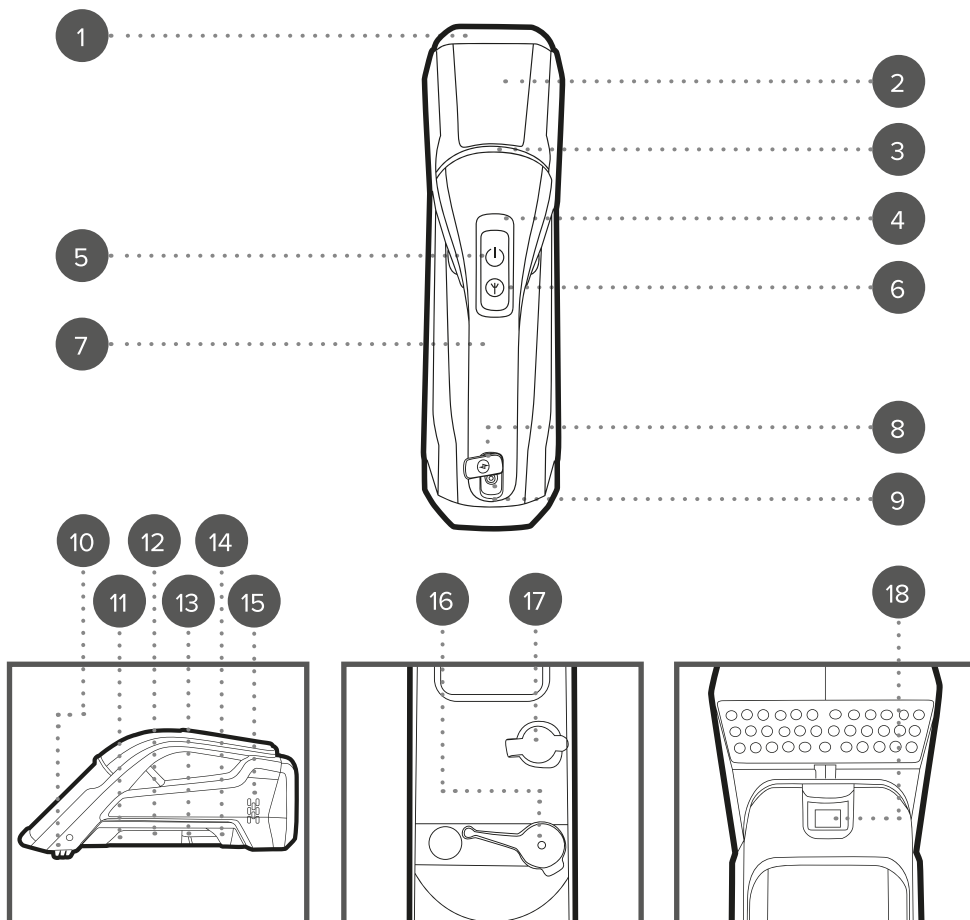

1. Spot cleaner main unit
2. Removable spray nozzle cover
3. Spray nozzle
4. Power indicator light
5. Power button
6. Detergent spray button
7. Handle
8. Charging port cap
9. Charging port

10. Brush bar
11. Dirty water tank max. fill mark
12. Dirty water tank
13. Water tank
14. Detergent compartment
15. Air vents
16. Detergent compartment cap
17. Dirty water tank cap
18. Water tank release latch

Please retain instructions future reference.

SAFETY INSTRUCTIONS

- When using electrical appliances, basic safety precautions should always be followed.
- Check that the voltage indicated on the rating plate corresponds with that of the local network before connecting the appliance to the mains power supply.
- Children aged from 8 years and people with reduced physical, sensory or mental capabilities or lack of experience and knowledge can use this appliance, only if they have been given supervision or instruction concerning use of the appliance in a safe way and understand the hazards involved.
- Children should be supervised to ensure that they do not play with the appliance.
- Unless they are older than 8 and supervised, children should not perform cleaning or user maintenance.
- This appliance is not a toy.
- If the power supply cord, plug or any part of the appliance is malfunctioning or if it has been dropped or damaged, cease using the product immediately to avoid potential injury.
- This appliance contains no user serviceable parts, only a qualified electrician should carry out repairs. Improper repairs may place the user at risk of harm.
- Keep the appliance and its power supply cord out of the reach of children.
- Keep the appliance out of the reach of children when it is switched on.
- Keep the appliance and its power supply cord away from heat or sharp edges that could cause damage.
- Keep the appliance free from dust, lint, hair or anything that may reduce the airflow of the appliance.
- Do not use this appliance if any of the openings are blocked.
- Do not use the appliance to pick up flammable liquid, matches, cigarette ends, hot ashes or any hot, burning or smoking objects.
- Do not use this appliance to pick up hard, sharp objects such as glass or nails etc.
- Do not use any parts/accessories other than those supplied with this appliance, as this may cause damage.
- Do not immerse the appliance in water or any other liquid.
- Do not use the appliance with hot water or caustic cleaning detergents.
- Do not use the appliance for anything other than its intended use.
- Do not leave the appliance unattended whilst connected to the mains power supply.
- Do not pull or carry the appliance by its power supply cord.
- Do not remove from the mains power supply by pulling the cord; switch off and remove the plug by hand.
- Do not use the appliance if it has been dropped, if there are visible signs of damage or if it is leaking.
- Do not use any mains power adaptor other than that supplied, as this could cause a hazard.
- Switch off the appliance and disconnect it from the mains power supply before changing or fitting accessories and before any cleaning or maintenance.
- Always ensure that the appliance has cooled fully after use before performing any cleaning or user maintenance.
- Use of an extension cord with the appliance is not recommended.

- This appliance should not be operated by means of an external timer or separate remote control system.
- This appliance is intended for domestic use only. It should not be used for commercial purposes.
- This appliance is intended for wet pick up only. Do not use for picking up dust or other dry materials.

BATTERY SAFETY

- The supply terminals are not to be short-circuited.
- In the event of a battery or cell leaking, do not allow the liquid to come in contact with the skin or eyes. If contact has been made, wash the affected area with copious amounts of water and seek medical advice.
- Do not use any cell or battery which is not designed for use with the product.
- Secondary cells and batteries need to be charged before use. After extended periods of storage, it may be necessary to charge and discharge the cells or batteries several times to obtain maximum performance.
- Keep batteries out of the reach of children.
- Do not crush, puncture, dismantle or otherwise damage batteries.
- Do not store above 60 °C.
- Avoid storage in direct sunlight.
- Do not expose batteries to heat or fire as they may explode.
- Do not subject batteries to mechanical shock.
- Once the batteries have been exhausted, dispose of the unit at a local recycling station. Contact the local government offices for further details.
- This appliance is fitted with a 7.4 V 2000 mAh Li-ion rechargeable battery.



CAUTION: Do not use the spot cleaner to pick up toxic materials (e.g., chlorine bleach, ammonia, drain cleaner, pesticides, insecticides).



WARNING: The use of cleaning formulas which contain lemon, pine oil or vinegar may damage the spot cleaner and void the warranty. Chemical spot cleaning solutions or solvent-based soil removers should not be used.

Dos and don'ts

DO:

Empty the dirty water compartment frequently, to prevent dirty water leaking from the air vents.

Fill the detergent compartment with detergent solution following the manufacturer's guidelines.

Ensure that the removable spray nozzle cover is fixed into place securely prior to turning on the spot cleaner.

DON'T:

Allow the dirty water compartment to exceed the dirty water tank max. fill line. Invert the unit or tilt it past a 45° angle during use.

Use this appliance to pick up toxic materials.

Care and maintenance

Before attempting any cleaning or maintenance, always switch off and unplug the spot cleaner from the mains power supply. Drain any remaining water from the water tank.

Wipe the spot cleaner main unit with a soft, damp cloth and dry thoroughly.

Do not use harsh or abrasive cleaning detergents or scourers.

Never immerse the spot cleaner main unit in water or any other liquid.

Instructions for use

Charging the spot cleaner

Before first use, the spot cleaner must be charged for approx. 4 hours. Subsequent charging times will take approx. 3–4 hours.

STEP 1: Gently lift up the charging port cap and connect the charging cable to the charging port on the spot cleaner.

STEP 2: Plug the mains power adaptor into the mains power supply; the power indicator lights will flash green to signal that the battery is charging. Once the battery is fully charged, the power indicator lights will stop flashing and remain solid for 10 minutes before turning off.



NOTE: Whilst charging, the spot cleaner may become warm.



CAUTION: Exercise caution when charging the spot cleaner; it must be stood upright on a dry, stable surface, away from other appliances.



WARNING: Do not leave the spot cleaner unattended whilst it is charging. In the case of abnormal operation (e.g. it begins to emit smoke), switch off and unplug the spot cleaner from the mains power supply immediately.

Mixing a cleaning solution

STEP 1: Predilute the cleaning solution following the guidelines on the detergent bottle.

STEP 2: Shake the solution bottle well before adding to the spot cleaner.

STEP 3: Test on a discrete area prior to cleaning. This will ensure that the cleaning solution will not cause the colours to bleed in the area being cleaned.

Filling the water tank and detergent compartment

STEP 1: Remove the water tank by pressing the water tank release latch and lifting the tank away from the main unit.

STEP 2: Access the detergent compartment by lifting the detergent tank cap.

STEP 3: Fill the detergent tank with warm water (max. 40 °C) or dilute detergent (following the manufacturer's guidelines). Do not exceed the max. fill line.

STEP 4: Secure the cap back into place, then replace the water tank into the main unit. The indent on the bottom of water tank should align with the groove on the main unit. Push the tank until it clicks into place.

STEP 5: Ensure that the spray nozzle cover is firmly attached to the spot cleaner main unit. Failure to do so will result in a reduction in suction.



NOTE: Do not use the spot cleaner without the water tank in position.



CAUTION: Do not attempt to remove/replace the water tank whilst the spot cleaner is turned on. Do not press the spray trigger if the detergent tank is empty.

Using the spot cleaner

To prevent colour bleeding, always spot test a discrete area before cleaning. Dampen a white cloth with the cleaning solution and warm water. In a small, hidden area of the carpet, gently rub the surface of the carpet. Wait for 10 minutes, then check for colour bleeding. If the cloth remains clean, the spot cleaner solution is suitable for cleaning the carpet.

Always consult the upholstery or carpet manufacturer's guidelines prior to using the spot cleaner. For best cleaning results, use the spot cleaner immediately after the carpet has been stained.

STEP 1: Before using the spot cleaner to clean fresh spills, remove any solid debris from the area. The spot cleaner is not designed to be used as a dry vacuum cleaner.

STEP 2: Fill the detergent compartment following the instructions in the section entitled '**Filling the detergent compartment**'.

STEP 3: Press the power button on the spot cleaner. The power indicator lights will illuminate to signal that the unit is on.

STEP 4: Point the spray nozzle at the stain and press the spray button to pre-treat the carpet. It is recommended to allow the cleaning solution to soak into the surface for five minutes prior to cleaning.

STEP 5: To begin cleaning, slowly move the spot cleaner backwards whilst releasing the detergent solution.

STEP 6: Release the spray button and push the spot cleaner forwards to remove the dirty solution from the carpet. Repeat this process as many times as necessary, taking care not to saturate the carpet.

STEP 7: Once finished, press the power button to turn off the spot cleaner.



NOTE: Always empty the dirty water tank after cleaning by following the instructions in the section entitled '**Emptying the dirty water tank**'.



CAUTION: Do not allow the spray to come into contact with the eyes or face. Failure to do so may result in injury.



WARNING: Do not allow the dirty water tank to exceed the dirty water tank max. fill mark; this could affect the suction of the spot cleaner and cause dirty water to leak from the air vents of the unit. If this occurs, drain the dirty water tank completely and allow the spot cleaner to dry thoroughly before reusing.

Emptying the dirty water tank

STEP 1: Ensure the spot cleaner is switched off and is not plugged into the mains power supply.

STEP 2: Push the water tank release latch and lift the water tank away from the main unit.

STEP 3: Lift the dirty water tank cap and empty the contents of the dirty water tank into a sink.

STEP 4: Rinse the dirty water tank using clean, running water and allow to dry. Replace the dirty water compartment cap.

STEP 5: Refit the water tank back into the main unit. The indent on the bottom of water tank should align with the groove on the main unit. Push the water tank until it clicks into place.



NOTE: It is recommended to empty the dirty water tank frequently. This will prevent dirty water from leaking through the air vents.

Cleaning the spot cleaner

The spray nozzle cover can be easily removed to clean away any dust or debris that has been trapped whilst using the spot cleaner.

STEP 1: Push the two clips on either side of the spray nozzle cover and lift it away from the main unit.

STEP 2: Wash the spray nozzle cover in warm, soapy water and allow it to dry thoroughly.

STEP 3: Remove the water tank following the instructions in the section entitled '**Filling the water tank and detergent compartment**'.

STEP 4: Rinse the tank and the detergent compartment in warm, soapy water.

STEP 5: Allow them to dry thoroughly before replacing in the main unit.

STEP 6: Wipe the spray nozzle and the rest of the spot cleaner main unit with a soft, damp cloth and allow to dry thoroughly.

STEP 7: Replace the spray nozzle cover by aligning the clips with the indents on the spot cleaner main unit and pushing the cover into place.



NOTE: Do not immerse the main unit in water.

Storage

Check that the spot cleaner main unit and the tanks are clean and dry before storing in a cool, dry place.

Hints and tips

1. When cleaning an area, move any furniture away. If this is not possible, place aluminium foil under the legs of the furniture. This will prevent any wood finishes from staining the carpet.
2. Stain removal varies with the type of stain, the time passed before removal, and the carpet type/material. Heavily soiled areas may have to be pre-treated before using the spot cleaner.
3. For best cleaning results, use a slow and steady, forwards and backwards motion.
4. For multi-coloured carpets, test every colour to ensure that they do not bleed.

Troubleshooting

Symptom	Possible cause	Solution
The spot cleaner will not turn on.	The spot cleaner has run out of charge.	Charge the spot cleaner following the instructions in the section entitled ' Charging the spot cleaner '. Press the power button to turn the unit on.
The spot cleaner will not suck up water.	The dirty water max. fill line has been exceeded.	Follow the instructions in the section entitled ' Emptying the dirty water compartment '.
Solution is not dispensing from the detergent compartment.	The water tank is not fitted securely.	Follow the instructions in the section entitled ' Filling the water tank and detergent compartment '.
The carpet is too wet.	Too much detergent has been used on the carpet.	Use less detergent on the carpet area. Run the spot cleaner over the carpet, without pressing the spray button, to vacuum excess water.

Specifications

Product code: BEL01624 / PF01624

Battery: 7.4 V 2000 mAh Li-ion battery (included)

Adaptor input: 100–240 VAC, 50/60 Hz, 0.3 A Max

Adaptor output: 9.0 V  0.6 A, 5.4 W

Average active efficiency: 81.48 %

Efficiency at low load (10%): N/A

No load power consumption: 0.49 W

Ingress protection: IPX4



Disposal of Waste Batteries and Electrical and Electronic Equipment



This symbol on the product, its batteries or its packaging means that this product and any batteries it contains must not be disposed of with household waste. Instead, it is the user's responsibility to hand this over to an applicable collection point for the recycling of batteries and electrical and electronic equipment. This separate collection and recycling will help to conserve natural resources and prevent potential negative consequences for human health and the environment due to the possible presence of hazardous substances in batteries and electrical and electronic equipment, which could be caused by inappropriate disposal. Some retailers provide take-back services which allow the user to return exhausted equipment for appropriate disposal. **It is the user's responsibility to delete any data on electrical and electronic equipment prior to disposal.** For more information about where to drop batteries, electrical and electronic waste off, please contact the local city/municipality office, household waste disposal service, or the retailer.

Manufactured by:
Ultimate Products UK Ltd.,
Victoria Street, Manchester OL9 0DD. **UK.**
Ultimate Products Europe Ltd.,
19 Baggot Street Lower, Dublin D02 X658. **ROI.**

MADE IN CHINA.

©Beldray trademark. All rights reserved.

CD171122/MD171122/V1