

# User manual

Vacuum Cleaner

---

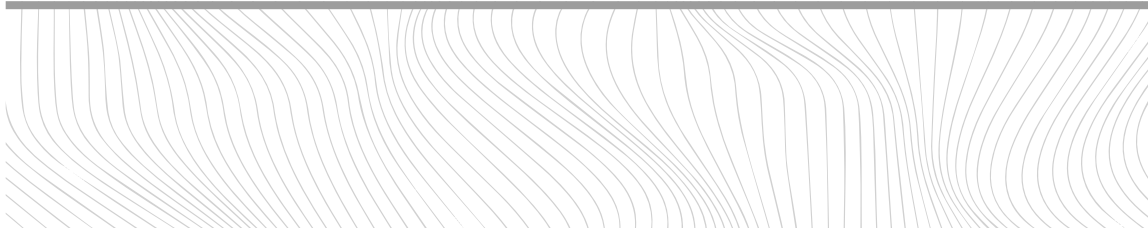
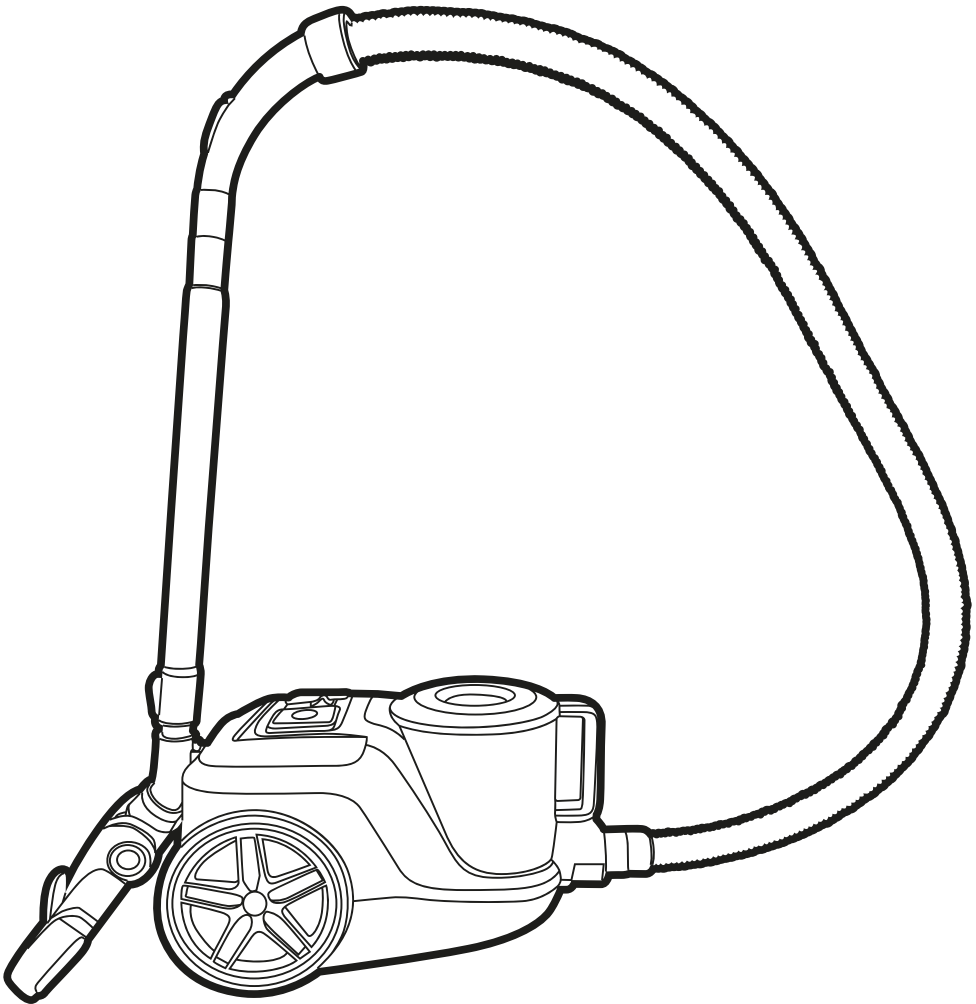

## Description of parts

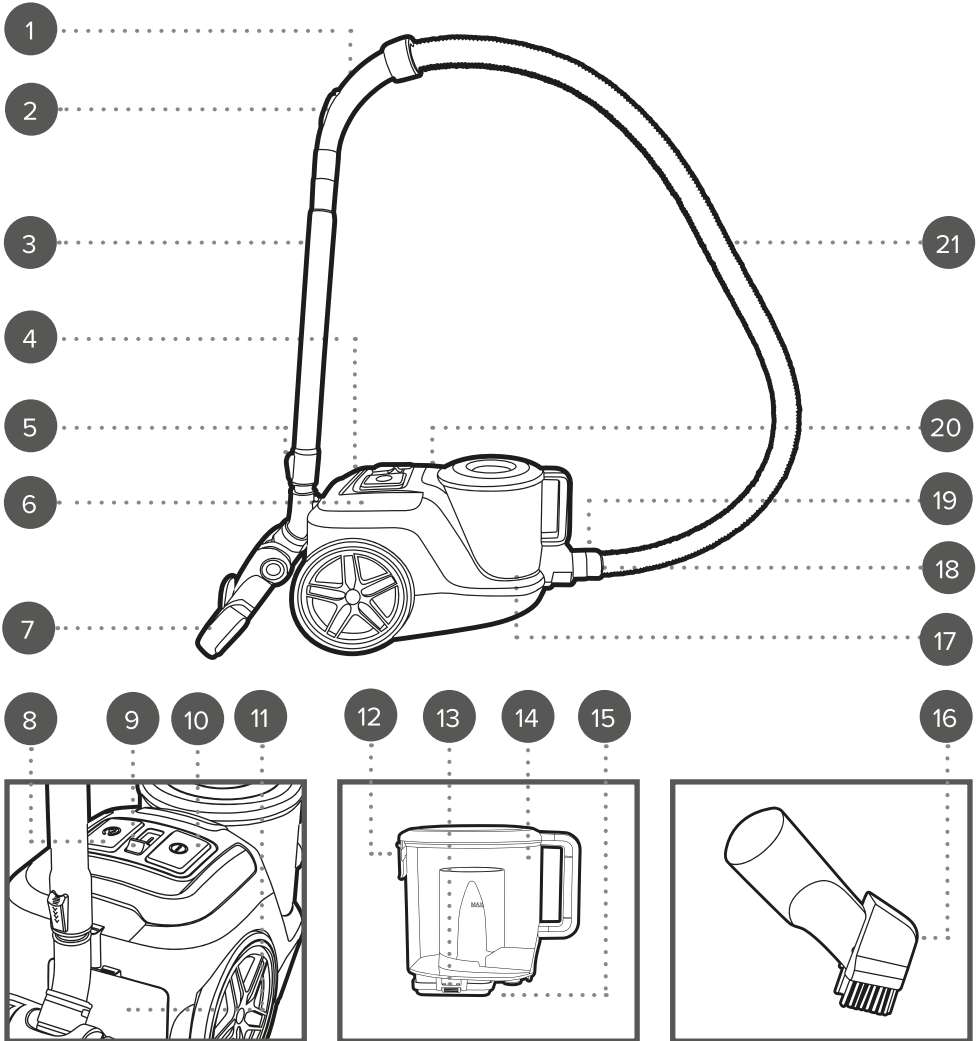

1. Suction hose neck
2. Air valve
3. Telescopic extension tube
4. Vacuum cleaner main unit
5. Telescopic extension tube button
6. Handle
7. Floor brush
8. Cord rewind button
9. Adjustable power setting slider
10. On/off power button
11. Exhaust filter

12. Dust container lid release catch
13. HEPA filter release hooks
14. Dust container
15. HEPA filter
16. 2 in 1 crevice and brush tool
17. Mesh filter
18. Suction hose lock
19. Air inlet
20. Dust container release catch
21. Suction hose

Please retain instructions for future reference.

## **SAFETY INSTRUCTIONS**

- When using electrical appliances, basic safety precautions should always be followed.
- Check that the voltage indicated on the rating plate corresponds with that of the local network before connecting the appliance to the mains power supply.
- Children aged from 8 years and people with reduced physical, sensory or mental capabilities or lack of experience and knowledge can use this appliance, only if they have been given supervision or instruction concerning use of the appliance in a safe way and understand the hazards involved.
- Children should be supervised to ensure that they do not play with the appliance.
- Unless they are older than 8 and supervised, children should not perform cleaning or user maintenance.
- This appliance is not a toy.
- If the power supply cord, plug or any part of the appliance is malfunctioning or if it has been dropped or damaged, cease using the product immediately to avoid potential injury.
- This appliance contains no user serviceable parts, only a qualified electrician should carry out repairs.
- Improper repairs may place the user at risk of harm.
- Keep the appliance and its power supply cord out of the reach of children.
- Keep the appliance out of the reach of children when it is switched on or cooling down.
- Keep the appliance and its power supply cord away from heat or sharp edges that could cause damage.
- Keep the appliance away from other heat emitting appliances.
- Keep the appliance free from dust, lint, hair or anything that may reduce the airflow of the appliance.
- Do not immerse the appliance in water or any other liquid.
- Do not operate the appliance with wet hands.
- Do not expose the appliance to rain.
- Do not leave the appliance unattended whilst connected to the mains power supply.
- Do not remove from the mains power supply by pulling the cord; switch off and remove the plug by hand.
- Do not pull or carry the appliance by its power supply cord.
- Do not use the appliance if it has been dropped or if there are visible signs of damage.
- Do not use the appliance for anything other than its intended use.
- Do not use any parts/accessories other than the parts supplied with this appliance, as this may cause damage.
- Do not use any damaged accessories.
- Do not use this appliance outdoors.
- Do not store the appliance in direct sunlight or in high humidity conditions.
- Do not use this appliance if any of the openings are blocked.

- Do not use the appliance to pick up flammable liquid, matches, cigarette ends, hot ashes or any hot, burning or smoking objects.
- Do not use this appliance to pick up hard, sharp objects such as glass or nails etc.
- Do not use the appliance to pick up water or any other liquid, as this poses risk of an electric shock.
- Take care when equipping accessories with rotating parts as this could cause entrapment.
- Switch off the appliance, disconnect it from the mains power supply and allow to cool fully before changing or fitting accessories and before cleaning or user maintenance.
- Use of an extension cord with the appliance is not recommended.
- This appliance should not be operated by means of an external timer or separate remote control system.
- This appliance is intended for domestic use only. It should not be used for commercial purposes.

### Thermal cut-out device

If the dust container and filters are not cleaned on a regular basis, the vacuum cleaner may overheat, which will cause the thermal cut-out device to activate due to restricted flow of air around the unit. If the vacuum cleaner cuts out, press the power button to turn it off and unplug it from the mains power supply. Proceed to empty the dust container, clean all of the filters and allow the vacuum cleaner to cool for approx. 1 hour.

### Care and maintenance

Always unplug the vacuum cleaner from the mains power supply before attempting any cleaning or maintenance.

Wipe the external surface of the vacuum cleaner with a soft, damp cloth and allow to dry thoroughly.

Do not use any harsh or abrasive detergents or cleaning agents to clean any part of the vacuum cleaner.

Remove the cyclonic cone to clean the inside of the dust container.

### Dos and don'ts

#### DO:

Check that the filters are kept clear of obstruction.

Make sure that the dust container and filters are cleaned regularly to preserve suction and to prolong the life of the vacuum cleaner.

Clean the filters at least every three weeks with clean water to keep the vacuum cleaner working efficiently.

#### DON'T:

Use the vacuum cleaner without the filters or dust container in position.

Use the vacuum cleaner to pick up flammable liquid, matches, cigarette ends, hot ashes or any hot, burning or smoking objects.

### Instructions for use

#### Before first use

Before using the vacuum cleaner for the first time, clean the exterior with a soft, damp cloth and dry thoroughly.

#### Assembling the vacuum cleaner

Before fitting any accessories into the air inlet, check that the vacuum cleaner is disconnected from the mains power supply.

**STEP 1:** Fit the dust container by pushing it onto the vacuum cleaner main unit, aligning the indents on the dust container to the loops on the vacuum cleaner main unit and clicking into place.

**STEP 2:** To attach the suction hose, insert the suction hose lock into the air inlet and push into place until it clicks.

**STEP 3:** To remove the suction hose, simultaneously push both locking tabs and pull the suction hose lock firmly away from the air inlet.

## Using the telescopic extension tube

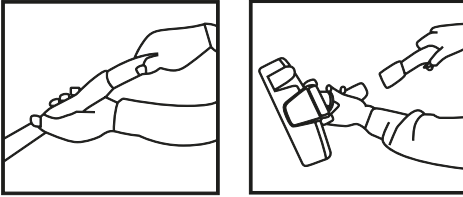

The floor brush and 2 in 1 crevice and brush tool all fit onto the telescopic extension tube to help to reach into confined spaces, such as behind radiators or underneath car seats.

**STEP 1:** Fit the telescopic extension tube by pushing the large opening of the telescopic extension tube over the end of the suction hose neck.

**STEP 2:** Push the chosen attachment onto the end of the telescopic extension tube.

**STEP 3:** Adjust the telescopic extension tube to the required length by pressing the telescopic extension tube button down and sliding the inner tube in or out.

**STEP 4:** Release the telescopic extension tube button to lock the telescopic extension tube into position at the selected length.

## Using the floor brush

**STEP 1:** Push the floor brush onto the end of the telescopic extension tube, or the suction hose neck if the telescopic extension tube is not being used.

**STEP 2:** Select which position on the floor brush is required for the floor type by pressing the switch forwards or backwards. Switching it forwards retracts the brushes for use on hard floors and switching it backwards extends the brushes for use on carpets.

**STEP 3:** Carefully pull out the power supply cord until it is at a suitable length; do not exceed the red mark. Plug it into the mains power supply.

**STEP 4:** Turn on the vacuum cleaner by pressing the power button. Press the power button again to switch it off.



**NOTE:** Open the air valve on the suction hose neck when vacuuming carpets. Use the adjustable power slider for desired suction power. To increase and decrease suction, slide the power slider upwards and downwards.

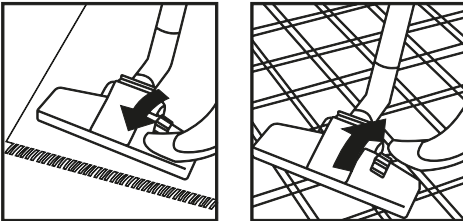

## Using the 2 in 1 crevice and brush tool

The crevice/brush tool is a 2 in 1 attachment with a rotating head that can be used as either a crevice tool for removing dust and dirt from folds in fabrics, radiators, corners, recesses and other places that are hard to reach, or as a brush tool that is perfect for cleaning shelves, cupboards and windowsills.

**STEP 1:** Push the 2 in 1 crevice and brush tool onto the end of the telescopic extension tube or the suction hose neck if the telescopic extension tube is not being used.

**STEP 2:** Rotate the head until the desired brush or crevice tool is selected.

**STEP 3:** Turn on the vacuum cleaner by pressing the power button; press the power button again to switch it off.

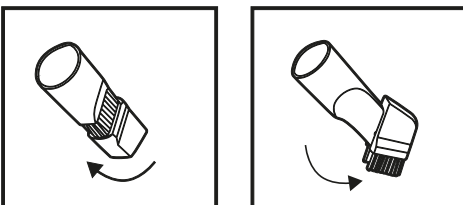

## After use

**STEP 1:** Turn off the vacuum cleaner by pressing the power button.

**STEP 2:** Switch off and unplug the vacuum cleaner from the mains power supply.

**STEP 3:** Press and hold the cord rewind button until the power supply cord has completely wound back into the cable drum.



**WARNING:** Hold onto the plug to guide the power supply cord back into the vacuum cleaner. Failure to do so may cause damage to the vacuum cleaner or injury to the user.

## Emptying the dust container

Before emptying the dust container, switch off and unplug the vacuum cleaner from the mains power supply. It is recommended to empty the dust container outdoors.

**STEP 1:** Whilst securely holding the vacuum cleaner main unit, remove the dust container by pushing the dust container release catch and pulling the dust container away.

**STEP 2:** Holding the dust container over a bin or refuse bag, pull the dust container base release clip to open the dust container. Empty the dust container slowly and carefully to reduce the amount of dust released back into the atmosphere. Shake the dust container gently to dislodge any stubborn dust.

**STEP 3:** To close the dust container, place the lid back onto the top of the container aligning the lid with the indent in the handle of the dust container.

**STEP 4:** Replace the dust container by pushing it onto the vacuum cleaner main unit, aligning the dust container indent to the release button.



**WARNING:** Do not use the vacuum cleaner if the dust container is filled past the max. fill mark, as this could damage the vacuum cleaner or cause injury to the user.

## Cleaning the dust container, HEPA filter and mesh filter

The filters can only be accessed when the dust container has been removed.

**STEP 1:** Empty the dust container following the instructions in the section entitled '**Emptying the dust container**'.

**STEP 2:** Once the dust container is empty, close it.

**STEP 3:** The HEPA filter is located at the bottom of the dust container and the HEPA mesh filter is located on the base of the main unit. Press the HEPA filter release hooks to remove the HEPA filter.

**STEP 4:** Remove the HEPA filter and the HEPA mesh filter.

**STEP 5:** Shake off the HEPA filter and HEPA mesh filter until the majority of the dust has been removed, then wash them under clean, warm water and allow to dry thoroughly.

**STEP 6:** Wash the dust container in clean, warm water and allow to dry thoroughly.

**STEP 7:** Once all the parts have dried fully, insert the HEPA filter back into the bottom of the dust container by pushing it back into the filters housing.



**NOTE:** If the dust container, cyclonic cone, HEPA filter and mesh filter are not cleaned regularly, the thermal cut-out device will activate. For further details, see the section entitled '**Thermal cut-out device**'.



**WARNING:** Do not clean the HEPA filter and mesh filter using detergent. Always allow the HEPA filter and mesh filter to air dry; never use external heat sources, such as a radiator to dry them. Do not wring or twist the HEPA filter or mesh filter as this will cause damage. Do not use the vacuum cleaner without any of the filters or the cyclonic cone in position, as this could cause damage.

## Cleaning the exhaust filter

The exhaust filter is located at the back of the vacuum cleaner main unit.

**STEP 1:** To remove the exhaust filter for cleaning, press down on the release hook and pull away from the vacuum cleaner main unit.

**STEP 2:** Remove the exhaust filter from the exhaust filter housing.

**STEP 3:** Shake off the exhaust filter until the majority of the dust has been removed, then wash it under clean, warm water and allow to dry thoroughly.

**STEP 4:** Once the exhaust filter has dried fully, slot it back into the exhaust HEPA filter housing clicking it into place.



**WARNING:** Do not clean the exhaust filter using detergent. Always allow the exhaust filter and mesh filter to air dry; never use external heat sources, such as a radiator to dry them. Do not wring or twist the exhaust filter as this will cause damage. Do not use the vacuum cleaner without any of the filters or the cyclonic cone in position, as this could cause damage.

## Troubleshooting

Symptom	Possible cause	Solution
The suction is poor.	The telescopic extension tube, floor brush, crevice/brush tool, pet turbo brush or air inlet is blocked.  The dust container is almost full.  The filters are blocked.	Disconnect the attachment and clear the blockage.  Empty the dust container following the instructions in the section entitled ' <b>Emptying the dust container</b> '.  Clean the filters following the instructions in the section entitled ' <b>Cleaning the dust container, HEPA filter and mesh filter</b> ' and ' <b>Cleaning the exhaust filter</b> '.
The vacuum cleaner has cut out or stopped working.	The thermal cut-out device has activated due to restricted air flow, and has cut power to the motor to protect the vacuum cleaner.	Switch off and disconnect the vacuum cleaner from the mains power supply.  Empty the dust container and clean the HEPA filter, exhaust filter and mesh filters.  Allow the vacuum cleaner to cool for approx. 1 hour.

## Static electricity

The vacuum cleaner may build up static electricity during use. This can result in static electric shocks when touching metal components of the vacuum cleaner. There is no need to worry if this happens. Discharge the vac by touching the extension tube against other metal objects nearby.

## Storage

Check that the vacuum cleaner is cool, clean and dry before storing in a clean, dry place.

## Specifications

Product code: BEL01797

Rated voltage: 220–240 V ~ 50 Hz

Rated wattage: 700 W

UK  
CA CE

**Disposal of Waste Batteries and Electrical and Electronic Equipment**



This symbol on the product, its batteries or its packaging means that this product and any batteries it contains must not be disposed of with household waste. Instead, it is the user's responsibility to hand this over to an applicable collection point for the recycling of batteries and electrical and electronic equipment. This separate collection and recycling will help to conserve natural resources and prevent potential negative consequences for human health and the environment due to the possible presence of hazardous substances in batteries and electrical and electronic equipment, which could be caused by inappropriate disposal. Some retailers provide take-back services which allow the user to return exhausted equipment for appropriate disposal. **It is the user's responsibility to delete any data on electrical and electronic equipment prior to disposal.** For more information about where to drop batteries, electrical and electronic waste off, please contact the local city/municipality office, household waste disposal service, or the retailer.

Manufactured by:  
Ultimate Products UK Ltd.,  
Victoria Street, Manchester OL9 0DD. **UK.**  
Ultimate Products Europe Ltd.,  
19 Baggot Street Lower, Dublin D02 X658. **ROI.**

**MADE IN CHINA.**

CD201023/MD000000/V1