

# Beldray

Est. 1872

Nobody Does It Better

## 2in1 Wall Fire Instruction Manual



THE **SCIENCE**  
BEHIND HEAT

Please read all instructions carefully and retain for future reference.

Getting Started

- Remove the appliance from the box.
- Remove any packaging from the appliance.
- Place the packaging inside the box and either store or dispose of safely.

In the Box

Serial Number	Name	Quantity
001	Carton	1
002	Screws (4 x 8mm)	2
003	Screws (4 x 35mm)	2
004	Fixed Angle	1
005	Plastic plug (8mm)	2
006	Packing left bubble	1
007	Fireplace	1
008	Bracket	1
009	Plastic plug (8mm)	4
010	Screws (4 x 35mm)	4
011	Remote control	1
012	Packing right bubble	1
013	Power cord	1

Features

- Wall mounted or free standing
- Flame and light effect
- 2kW power
- Ambient rear lighting with 3 flame options
- Choice of decorative pebbles

## Safety Instructions

When using electrical appliances, basic safety precautions should always be followed.

Check that the voltage indicated on the rating plate corresponds with that of the local network before connecting the appliance to the mains power supply.

Children younger than 3 years old should be kept away from the appliance unless continuously supervised.

Children from age 3 and less than 8 years should only switch the appliance on/off, if it has been placed or installed in its intended normal operating position, if they have been given supervision or instruction concerning use of the appliance in a safe way and understand the hazards involved. Children from age 3 and less than 8 years must not plug in, regulate and clean the appliance or perform user maintenance.

Particular attention should be given where children and vulnerable people are present.

Only a qualified electrician should perform repairs to electrical appliances; improper repairs may put the user at serious risk.

This appliance contains no user serviceable parts. Any attempts to repair the appliance may place the user at risk of harm.

If the supply cord or plug is broken, do not use the appliance and ensure that a qualified electrician fixes it.

Never put the supply cord near to or in contact with the hot parts of the appliance.

Keep the supply cord away from heat or sharp edges that could cause damage.

Keep the supply cord out of reach of children.

Do not run the supply cord under carpets, rugs etc. or anywhere where it may present a trip hazard.

Do not use this heater with a programmer, timer, separate remote-control system or any other device that will switch the heater on automatically, as there is a risk of fire if the heater is covered or positioned incorrectly.

Do not immerse the appliance or plug in water or any other liquid.

Do not touch the appliance during use, as it will get very hot and could cause injury.

Do not use the appliance after a malfunction or if it has been dropped or damaged.

Do not leave the appliance unattended whilst connected to the mains power supply.

Do not leave the appliance unattended whilst it is in use.

Do not attempt to move the appliance during use.

Do not use this appliance in the immediate surroundings of a bath, a shower or swimming pool.

Do not use the appliance for anything other than its intended use.

Do not lift the appliance by the front panel.

Always unplug the appliance after use and before any cleaning or maintenance.

Do not clean the appliance with abrasive chemicals or materials such as scourers as they may damage the appliance and impair future function.

The appliance should be used on a stable, heat resistant surface.

The appliance must not be located immediately below or next to a mains power supply. Keep furniture, curtains and other flammable material at least 1 metre away from the appliance. Never use accessories that are not recommended or supplied by the manufacturer. It could cause danger to the user and damage to the appliance.

Ensure that the appliance has cooled fully after use, any cleaning or maintenance.

This appliance is intended for domestic use only. It should not be used for commercial purposes.

**Caution:** Some parts of this appliance can become very hot and cause burns.

**Warning:** In order to avoid overheating, do not cover the appliance.

**Warning:** This appliance is not equipped with a device to control the room's temperature. Do not use this appliance in small rooms whilst occupied by persons not capable of leaving the room on their own, unless constant supervision is provided.

**Note:** When using this appliance for the first time a slight odour may be emitted, this is normal and will soon pass; ensure that there is sufficient ventilation.

### Description of Parts

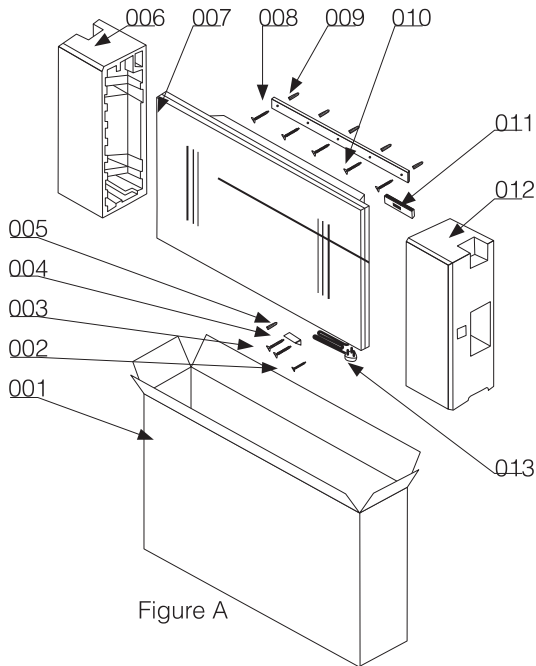

## Instructions for Use

### Helpful Advice Before Fitting

Please retain all packaging until you have checked and counted all the parts and the contents of the fixing pack against the parts list.

The fixing pack contains small items, which should be kept away from young children.

We suggest that you open the fixing pack and place all the contents into a container, therefore reducing the risk of losing any small pieces.

### Installation for a Wall Mounted Fire

Do not connect the fire to the mains power supply until all of the instructions have been read, fully understood and the fire has been properly and securely fitted.

The minimum safe distances must be observed.

For installation of the fire, care must be taken not to damage concealed cables.

This fire should be mounted to a wall at a minimum height of 300mm. The wall bracket must be fitted horizontally and the cable routed to the bottom right of the heater.

A height of 600mm from the bottom of heater to the floor is recommended for optimum viewing of the fuel bed see fig.1 for recommend fixing dimensions.

Use the bracket as template and mark four drill positions on the wall.

Make sure that these holes are level. Observe the recommended fixing dimensions (Fig. 2).

Put the bracket aside and drill holes with a depth of 35 mm using an 8 mm drill bit. Please be careful when drilling holes.

Clean the holes of dust and insert one wall plug in each hole. Make sure that the end of the wall plug is flush with the surface of the wall.

Hold the bracket into position and fix it to the wall with screws.

Attach the fixing angle to the bottom of the fire using the short screws.

Carefully lift the front panel and hook it onto the wall bracket (Fig. 2, circle). Do not let the appliance go until you are sure it is safely engaged to the bracket.

Now mark the hole position for fixing the angle (Fig. 3). Carefully remove the fire front from the bracket and drill a hole to a depth of 35 mm using an 8 mm drill bit.

Clean the hole of dust and insert one wall plug. Make sure that the end of the wall plug is flush with the surface of the wall.

Then lift up the front panel again, engage it to the bracket and finally fix the angle.

**Note:** It is recommended that two people should lift the front panel to attach it to the bracket.

Fig 1

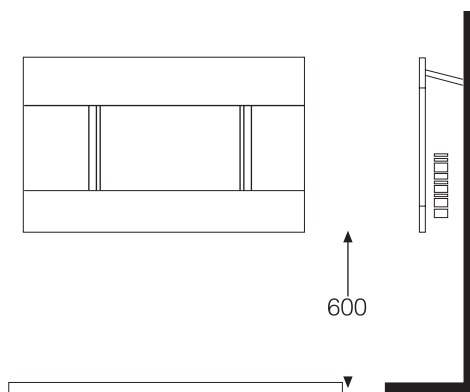

Fig 2

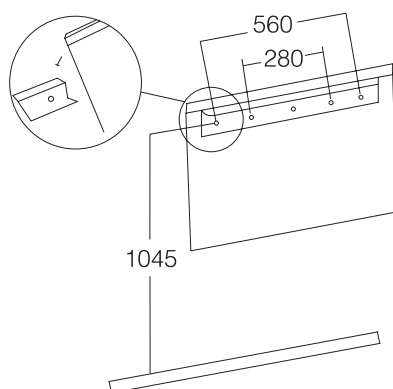
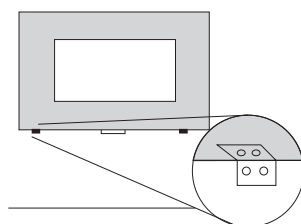

Fig 3



## Installation for a Free Standing Fire

Do not connect the fire to the mains power supply until all of the instructions have been read, fully understood and the fire has been properly and securely fitted.

The minimum safe distances must be observed.

Attach the feet to the bottom of the fire using the screws provided; there are four screws for each pedal. Carefully lift the front panel and hook it onto the bracket. Do not let the front panel go until you are sure that it is safely engaged to the bracket.

**Note:** It is recommended that two people should lift the front panel to attach it to the bracket.

**Note:** The fire must only be operated on a flat, stable, heat-resistant surface.

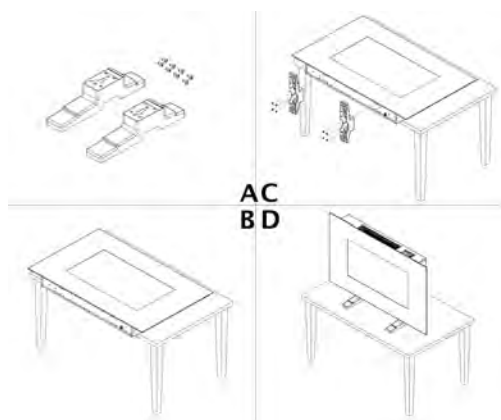

## Placing the Pebbles

Remove the front panel (Fig 4).

Take the pebbles out of the packaging and place evenly onto the plastic board (Fig 5).

Replace the front panel (Fig 6).

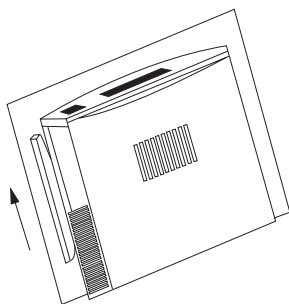

Fig 4

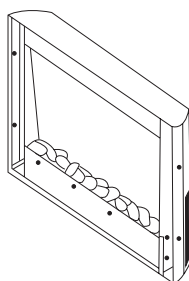

Fig 5

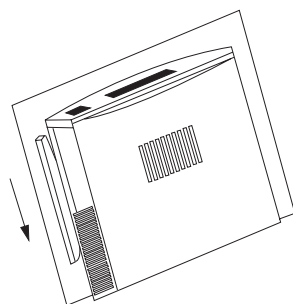



Fig 6

## Instructions for Operation

Make sure that the standby switch is off and plug the mains power adaptor to a mains power supply. The fire can be operated by either the switch located on the top right hand side of the fire or by the remote control supplied.

### Manual Operation

The switches are located on the top right hand side of the fire. Turn the standby switch on first. Switch the  button once to turn the fire and the fire effect on. A red indicator light will illuminate to indicate that the function is operational.

Press the LOW button (next to the  button) once for the low heat setting; press it again to switch the low setting off.

Press the HIGH button (the button furthest to the left) once for the high heat setting; press it again to switch the high setting off.

### Remote Operation

The standby switch located at the top right hand side of the fire must be turned on first. It takes a few moments for the receiver to respond to the transmitter. Do not press the buttons more than once within two seconds for the fire to operate correctly.

Press the  button once on the remote control to turn the fire and the fire effect on.

Press the LOW button once for the low heat setting; press it again to switch the low setting off.

Press the HIGH button once for the high heat setting; press again to switch the high setting off.

**Note:** The fire will emit an audible beep to indicate when a function has been selected.



The FLAME button can be used to control the flame effect of the fire.

### Safety Cut-Off

This fire is fitted with a safety cut-off, which will operate if the fire overheats (e.g. due to blocked air vents). For safety reasons, the fire will NOT automatically reset.

To reset the fire, unplug it from the mains power supply for at least 15 minutes.

Reconnect the fire to the mains power supply and switch it on.



## Troubleshooting

Problem	Solution
The fire/fan will not start.	<p>Ensure that the fire is connected to the mains power supply and is turned on.</p> <p>Check that the safety cut-off switch has not been activated. Wait 15 minutes before attempting to restart the fire.</p> <p>Disconnect the fire from the mains power supply and check the plug to see if the fuse needs replacing.</p>
The remote control is not working.	<p>Make sure that the battery in the remote control is not exhausted. Replace the battery (3V CR2025) according to the diagram and polarity shown on the back of the remote control.</p> <p>Ensure that you are pointing the remote control directly towards the fire.</p>

## Care and Maintenance

Before attempting any cleaning or maintenance, ensure that the fire has been unplugged from the mains power supply.

Use a soft, clean duster to clean the fire; never use abrasive cleaners or solvents.

The glass screen should be cleaned carefully with a soft cloth; DO NOT use proprietary glass cleaners.

## Battery Safety

Only use the batteries recommended.

Batteries are to be inserted with the correct polarity and should not be exposed to excessive heat sources such as fire and direct sunlight.

Remove any batteries from the remote control when it is not being used for a long period of time, to avoid leakage.

Exhausted batteries should be removed from the remote control to avoid leakage.

Remember to keep button cell batteries away from children at all times as they can easily be swallowed.

Non-rechargeable batteries should not be recharged.

Rechargeable batteries must be removed from the remote control before being charged.

Rechargeable batteries should only be recharged under adult supervision.

The supply terminals are not to be short-circuited.

Only batteries of the same or equivalent type as those recommended should be used with this remote control.

Batteries must be inserted according to the correct polarity.

Do not dispose of batteries in a fire.

Do not dispose of batteries in your household waste.

To dispose of the batteries, take them to your local recycling station. Contact your local government offices for details.

This product requires 1 x 3V CR2025 battery (not included).

### Specification

Supply: 220-240V~ 50Hz

Rated power: 2000W

Lighting: 0.5W LED Lamp

### Notes:

This image shows a single sheet of white paper with horizontal ruling lines. The lines are evenly spaced and run across the width of the page. There are no margins, text, or other markings on the paper.

## Connection to the mains

Please check that the voltage indicated on the product corresponds with your supply voltage.

### Important

As the colours in the mains lead of this appliance may not correspond with the coloured markings identifying the terminals in your plug, please proceed as follows:

The wires in the mains lead are coloured in accordance with the following code:

Blue Neutral (N)

Brown Live (L)

Green/Yellow Earth ( $\perp$ )

FOR UK USE ONLY - Plug fitting details (where applicable).

The wire coloured BLUE is the NEUTRAL and must be connected to the terminal marked N or coloured BLACK.

The wire coloured BROWN is the LIVE wire and must be connected to the terminal marked L or coloured RED.

The wire coloured GREEN/YELLOW must be connected to the terminal marked with the letter E or marked  $\perp$ .

On no account must either the BROWN or the BLUE wire be connected to the EARTH terminal ( $\perp$ ).

Always ensure that the cord grip is fastened correctly.

The plug must be fitted with a fuse of the same rating already fitted and conforming to BS 1362 and be ASTA approved.

If in doubt consult a qualified electrician who will be pleased to do this for you.

### Non-rewireable mains plug

If your appliance is supplied with a non-rewireable plug fitted to the mains lead and should the fuse need replacing, you must use an ASTA approved one (conforming to BS 1362 of the same rating).

If in doubt, consult a qualified electrician who will be pleased to do this for you.

If you need to remove the plug - DISCONNECT IT FROM THE MAINS and then cut it off the mains lead and immediately dispose of it safely. Never attempt to re-use the plug or insert it into a socket outlet as there is a danger of an electric shock.

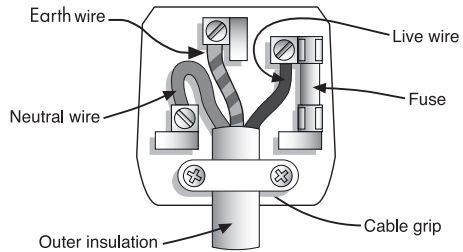

## UP Global Sourcing

Manchester, OL9 0DD.

If this product does not reach you in an acceptable condition please contact our Customer Services Department by one of the following methods:

Telephone: +44 (0)333 577 9820\*

\*Telephone lines are open Monday – Friday, 9am – 5pm (Closed Bank Holidays)

Email: [customersupport@beldray.co.uk](mailto:customersupport@beldray.co.uk)

Fax: 0161 628 2126

Please have your delivery note to hand as details from it will be required.

If you wish to return this product please return it to the retailer from where it was purchased with your receipt (subject to their terms and conditions).

## Guarantee

This product is guaranteed for a period of 1 year from the date of purchase against mechanical and electrical defects.

This guarantee is only valid if the appliance is used solely for domestic purposes in accordance with the instructions and provided that it is not connected to an unsuitable electricity supply or dismantled or interfered with in any way or damaged through misuse. Under this guarantee we undertake to repair or replace free of charge any parts found to be defective. Reasonable proof of purchase must be provided.

Nothing in this guarantee or in the instructions relating to this product excludes, restricts or otherwise affects your statutory rights.

In line with our policy of continuous development we reserve the right to change this product, packaging and documentation specification without notice.

Consumables are not guaranteed i.e. plug and fuse.

The crossed out wheelie bin symbol on this item indicates that this appliance needs to be disposed of in an environmentally friendly way when it becomes of no further use or has worn out. Contact your local authority for details of where to take the item for recycling.



