

Beldray[®]

Est 1872

Nobody Does It Better

Phoenix Inset Electric Fire Instruction Manual



THE **SCIENCE**
BEHIND HEAT



www.beldray.com

Please read all of the instructions carefully and retain for future reference.

Safety Instructions

When using electrical appliances, basic safety precautions should always be followed.

Check that the voltage indicated on the rating plate corresponds with that of the local network before connecting the appliance to the mains power supply.

Children younger than 3 years old should be kept away from the appliance unless continuously supervised.

Children aged from 3 years and less than 8 years shall only switch on/off the appliance, provided that it has been placed or installed in its intended operating position and they have been given supervision or instruction concerning the use of the appliance in a safe way and understand the hazards involved.

Children aged from 3 years and less than 8 years shall not plug in, regulate or clean the appliance or perform user maintenance.

Children should be supervised to ensure that they do not play with the appliance.

This appliance is not a toy.

This appliance contains no user serviceable parts. If the power supply cord, plug or any part of the appliance is malfunctioning or if it has been dropped or damaged, only a qualified electrician should carry out repairs. Improper repairs may place the user at risk of harm.

Keep the appliance and its power supply cord out of reach of children.

Keep the appliance and its power supply cord away from heat or sharp edges that could cause damage.

Keep the power supply cord away from any parts of the appliance that may become hot during use.

Keep the appliance away from other heat emitting appliances.

Keep furniture, curtains and other flammable material at least 1 metre away from the appliance.

Do not run the supply cord under carpets, rugs etc. or anywhere where it may present a trip hazard.

Do not immerse the appliance or plug in water or any other liquid.

Do not operate the appliance with wet hands.

Do not use this appliance in the immediate surroundings of a bath, a shower or swimming pool.

Do not leave the appliance unattended whilst connected to the mains power supply or when in use.

Do not remove from the mains power supply by pulling the cord; switch off and remove the plug by hand.

Do not use the appliance for anything other than its intended use.

Do not use this appliance outdoors.

Do not attempt to move the appliance whilst it is in use.

Do not touch the appliance during use, as it will get very hot and could cause injury.

Do not use the appliance with a programmer, timer, separate remote-control system or any other device that will switch the appliance on automatically, as there is a risk of fire if the heater is covered or positioned incorrectly.

Do not clean the appliance with abrasive chemicals or materials such as scourers as they may damage the appliance and impair future function.

The appliance should be used on a stable, heat resistant surface.

The appliance must not be located immediately below or next to a mains power supply.

Always unplug the appliance after use and before any cleaning or maintenance.

Always ensure that the appliance has cooled fully after use, any cleaning or maintenance.

Never use accessories that are not recommended or supplied by the manufacturer. It could cause danger to the user and damage to the appliance.

Use of an extension cord with the appliance is not recommended.

This appliance is intended for domestic use only. It should not be used for commercial purposes.

Warning: In order to avoid overheating, do not cover the appliance.

Warning: This appliance is not equipped with a device to control the room's temperature. Do not use this appliance in small rooms whilst occupied by persons incapable of leaving the room on their own, unless constant supervision is provided.

Caution: Some parts of this product can become very hot and cause burns. Particular attention has to be given where children and vulnerable people are present.

Caution: In order to avoid a hazard due to inadvertent resetting of the thermal cut-out, this appliance must not be supplied through an external switching device, such as a timer, or connected to a circuit that is regularly switched on and off by the utility.

Caution: Hot surface. Do not touch the hot section or heating components of the appliance.

Getting Started

Remove the appliance from the box.

Remove any packaging from the appliance.

Place the packaging inside the box and store or dispose of safely.

In the Box

Phoenix Inset Electric Fire

Removable Facia

Coals Pack

2 Screws

2 Wall Plugs

Instruction Manual

Features

2000 W

2 heat settings 1000 W / 2000 W

Polished chrome frame with black fret

100 % LED flame effect

Real coal effect fuel bed

'Flame without heat' setting

57 mm spacer included

Description of Parts



Instructions for Use

Before First Use

Please retain all of the packaging until you have checked and counted all of the parts and the contents of the fixing pack against the parts list.

The fixing pack contains small items, which should be kept away from young children.

We suggest that you open the fixing pack and place all of the contents into a container, to reduce the risk of losing any small pieces.

Installation Guide

Do not connect the Phoenix Inset Electric Fire main unit to the mains power supply until all of the instructions have been read, fully understood and the Phoenix Inset Electric Fire has been properly and securely fitted.

The minimum safe distances must be observed.

Note: The Phoenix Inset Electric Fire must only be operated on a flat, stable, heat-resistant surface.

Note: The Phoenix Inset Electric Fire is suitable for installation into a location that has an opening size within the guidelines shown below:

Dimension	Minimum	Maximum
Width	390 mm	483 mm
Height	555 mm	590 mm
Depth	110 mm	125 mm

The minimum clearance required to allow for sufficient ventilation is shown below:

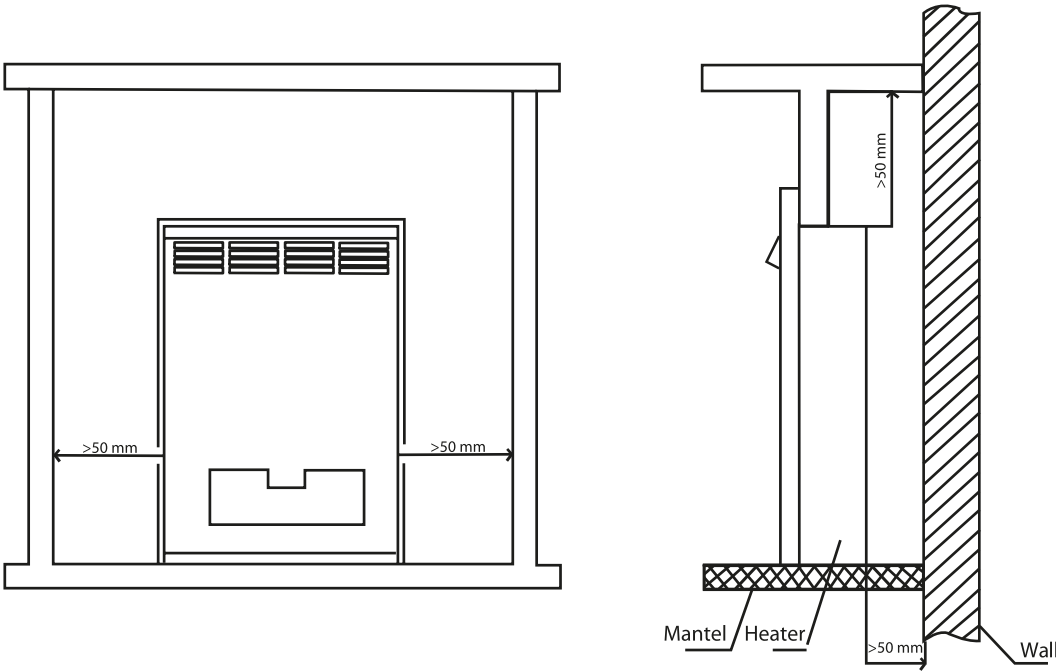

Freestanding

The Phoenix Inset Electric Fire can be placed in any location as a free-standing unit, so long as the Phoenix Inset Electric Fire is kept approximately 1 m clear from any combustible objects.

Securing the Phoenix Inset Electric Fire to a Heath Based on Maximum Dimensions

The Phoenix Inset Electric Fire should be secured to the wall using the 2 keyholes located in the 57 mm spacer and the screws supplied.

Fit the two screws onto the rear wall of the Phoenix Inset Electric Fire and leave a 2 mm gap (see diagram below).

Fit the Phoenix Inset Electric Fire by lifting it, sliding it onto the two screws then lowering it into place.

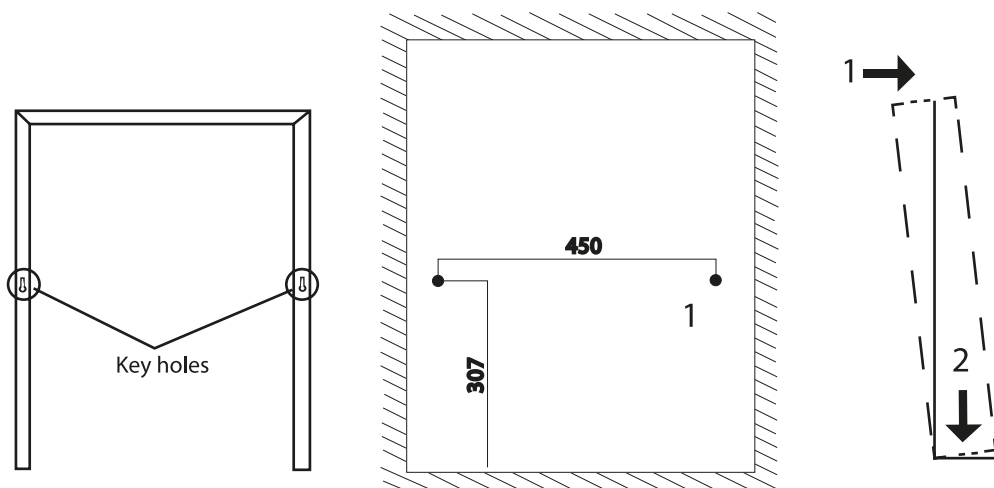

Method 2 (Fire Chamber with Minimum Dimensions)

- Step 1:** Ensure that the Phoenix Inset Electric Fire is disconnected from the mains power supply.
- Step 2:** Remove the four screws from the removable facia located at the rear of the Phoenix Inset Electric Fire and then remove the facia.
- Step 3:** Mark the centre of the opening of the fireplace. Measure 215.5 mm to the left and then again to the right. From there measure from the floor 560 mm up the wall. Once measured, mark these positions on the wall.
- Step 4:** Fit one screw securely into the opening of the fireplace on each of the marked positions, leaving approximately 2 mm of the screws visible.
- Step 5:** Once the two screws have been securely fitted, lift the Phoenix Inset Electric Fire up to the hearth and slide the fire onto the two fixing screws.

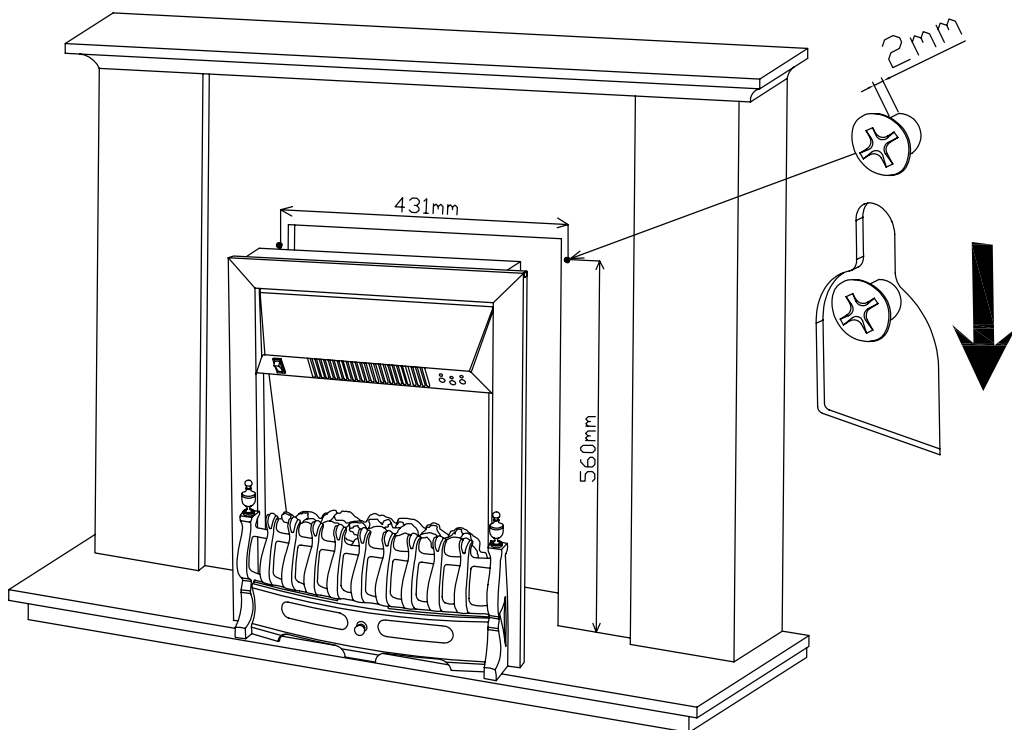

Using the Phoenix Inset Electric Fire

The Phoenix Inset Electric Fire is operated using two switches. The 'ON/OFF' switch is located on the left hand side of the fire hood and the 'Heating setting' switch is one on the right hand side.

	Symbol Shown	Operation
ON/OFF switch	○	○ = Off, = On/flame without heat setting
Heating setting switch	- = ○	1000 W heat setting 2000 W heat setting No heat

Ensure that the plug is connected to the mains power supply and that the plug socket is turned on. Switch the Phoenix Inset Electric Fire on using the 'ON/OFF' switch located on the right hand side of the fire hood.

Press the 'ON/OFF' switch on the Phoenix Inset Electric Fire to switch on the fire and turn the 'Flame without heat' setting on.

The "-" setting sets the Phoenix Inset Electric Fire to the 1000 W heat setting.

Flick the switch to "=" to set the Phoenix Inset Electric Fire to the 2000 W heat setting.

Set the switch to "○" to set the Phoenix Inset Electric Fire to the no heat setting and turn on the 'Flame without heat' setting.

Note: The Phoenix Inset Electric Fire must be turned on with the 'Flame without heat' setting on in order for any of the heat settings to work.

Safety Cut-Off

The Phoenix Inset Electric Fire is fitted with a safety cut-off which will operate if the fire overheats (e.g. due to blocked air vents). For safety reasons, the Phoenix Inset Electric Fire will NOT automatically reset.

To reset the Phoenix Inset Electric Fire, unplug it from the mains power supply for approximately 15 minutes.

Clear any blockages present on the vents being careful not to damage the Phoenix Inset Electric Fire. Reconnect the Phoenix Inset Electric Fire to the mains power supply and switch it on.

Troubleshooting

Symptom	Solution
The Phoenix Inset Electric Fire will not work.	Ensure that the Phoenix Inset Electric Fire is connected to the mains power supply and is turned on. Check that the safety cut-off has not been activated. Wait approximately 15 minutes before attempting to restart the Phoenix Inset Electric Fire. Disconnect the Phoenix Inset Electric Fire from the mains power supply and check the plug to see if the fuse needs replacing.

Care and Maintenance

Before attempting any cleaning or maintenance, ensure that the fire has been unplugged from the mains power supply.
Use a soft, clean duster to clean the fire; never use abrasive cleaners or solvents.

Specifications

Lighting: LED (non-replaceable).

Connection to the mains

Please check that the voltage indicated on the product corresponds with your supply voltage.

Important

As the colours in the mains lead of this appliance may not correspond with the coloured markings identifying the terminals in your plug, please proceed as follows:

The wires in the mains lead are coloured in accordance with the following code:

Blue Neutral (N)

Brown Live (L)

Green/Yellow Earth (\perp)

FOR UK USE ONLY - Plug fitting details (where applicable).

The wire coloured BLUE is the NEUTRAL and must be connected to the terminal marked N or coloured BLACK.

The wire coloured BROWN is the LIVE wire and must be connected to the terminal marked L or coloured RED.

The wire coloured GREEN/YELLOW must be connected to the terminal marked with the letter E or marked \perp .

On no account must either the BROWN or the BLUE wire be connected to the EARTH terminal (\perp).

Always ensure that the cord grip is fastened correctly.

The plug must be fitted with a fuse of the same rating already fitted and conforming to BS 1362 and be ASTA approved.

If in doubt consult a qualified electrician who will be pleased to do this for you.

Non-rewireable mains plug

If your appliance is supplied with a non-rewireable plug fitted to the mains lead and should the fuse need replacing, you must use an ASTA approved one (conforming to BS 1362 of the same rating).

If in doubt, consult a qualified electrician who will be pleased to do this for you.

If you need to remove the plug - DISCONNECT IT FROM THE MAINS and then cut it off the mains lead and immediately dispose of it safely. Never attempt to reuse the plug or insert it into a socket outlet as there is a danger of an electric shock.

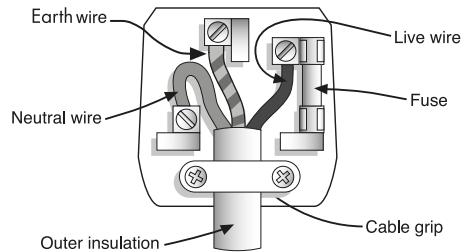

UP Global Sourcing

Victoria Street, Manchester OL9 0DD. UK.

If this product does not reach you in an acceptable condition please contact our Customer Services Department by one of the following methods:

Telephone: +44 (0)161 934 2240*

*Telephone lines are open Monday – Friday, 9am – 5pm (Closed Bank Holidays)

Email: customersupport@beldray.co.uk

Fax: 0161 628 2126

Please have your delivery note to hand as details from it will be required.

If you wish to return this product please return it to the retailer from where it was purchased with your receipt (subject to their terms and conditions).

Guarantee

This product is guaranteed for a period of 2 years from the date of purchase against mechanical and electrical defects.

This guarantee is only valid if the appliance is used solely for domestic purposes in accordance with the instructions and provided that it is not connected to an unsuitable electricity supply or dismantled or interfered with in any way or damaged through misuse. Under this guarantee we undertake to repair or replace free of charge any parts found to be defective. Reasonable proof of purchase must be provided.

Nothing in this guarantee or in the instructions relating to this product excludes, restricts or otherwise affects your statutory rights.

In line with our policy of continuous development we reserve the right to change this product, packaging and documentation specification without notice.

Consumables are not guaranteed i.e. plug and fuse.

The crossed out wheelie bin symbol on this item indicates that this appliance needs to be disposed of in an environmentally friendly way when it becomes of no further use or has worn out. Contact your local authority for details of where to take the item for recycling.



