

User manual

Carpet sweeper

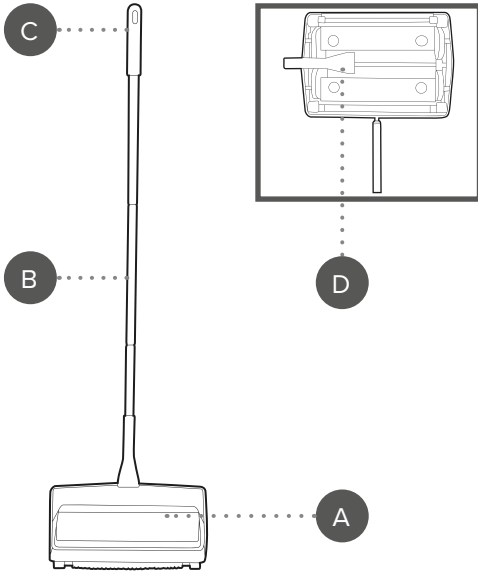

Description of parts

- A) Carpet sweeper body
- B) Pole (qty. 3)
- C) Handle
- D) Brush tool

Please retain instructions for future reference.



CAUTION: The carpet sweeper is not designed to replace a vacuum cleaner. The carpet sweeper should only be used to clean small areas of hard or soft floors. Do not use the carpet sweeper with water or any other liquid.

Getting started

Remove all packaging from the components.
Separate the carpet sweeper body from the poles.
Check for signs of damage before first use.

Care and maintenance

Empty the carpet sweeper after every use.
Regularly check the brushes on the underside of the carpet sweeper body. Use the brush tool provided to remove trapped debris and ensure the carpet sweeper is operating efficiently.
Wipe the carpet sweeper with a soft, damp cloth and allow to dry.
Do not immerse the carpet sweeper in water or any other liquid.
Never use harsh or abrasive cleaning detergents or scourers to clean the carpet sweeper as this could cause damage.

Assembling the carpet sweeper

STEP 1: Screw the poles (B) together by positioning one pole inside the other and twisting in a clockwise direction until secure. Repeat to connect the third pole (B).
STEP 2: Screw the assembled pole into the carpet sweeper body (A) by positioning the carpet sweeper inside the pole and twisting in a clockwise direction until secure.
STEP 3: Attach the handle (C) to the end of the assembled pole by twisting in a clockwise direction until secure.

Disassembling and storing the carpet sweeper

STEP 1: Unscrew the pole from the carpet sweeper body (A) by twisting in an anticlockwise direction.
STEP 2: Separate the poles (B) by twisting each section in an anticlockwise direction.

Directions for use

STEP 1: Holding the handle firmly, steadily push the carpet sweeper along the surface to pick up debris.
STEP 2: To empty the carpet sweeper, turn the carpet sweeper body (A) upside down. Push the indicated areas on one side of the carpet sweeper to empty. To close the lid, push it down on both sides until it clicks shut.

Manufactured by:
Ultimate Products UK Ltd.,
Victoria Street, Manchester OL9 0DD. UK.
Ultimate Products Europe Ltd.,
19 Baggot Street Lower, Dublin D02 X658. ROI.

MADE IN CHINA.

CD191224/MD000000/V1