

User manual

Floor cleaner

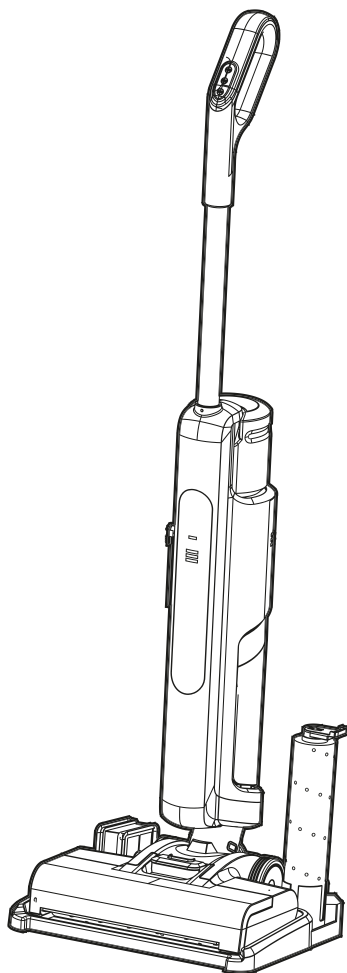

Description of parts

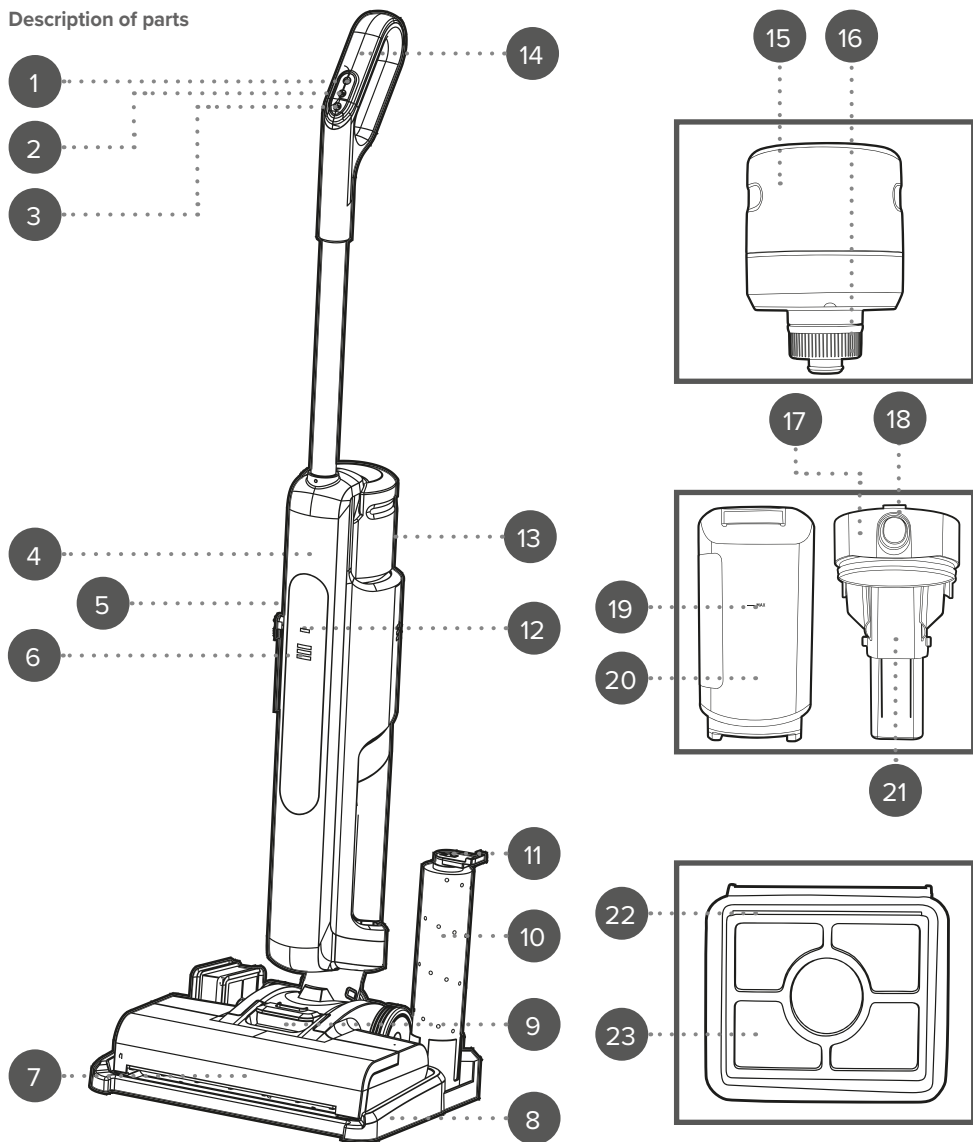

1. Single speed power button
2. Water flow button
3. Self-clean button
4. Floor cleaner main unit
5. Charging port
6. Power indicator lights
7. Floor brush cover
8. Storage tray
9. Brush cover release button
10. Floor brush
11. Floor brush tab
12. Spray indicator light

13. Handle locking button
14. Handle
15. Detergent/clean water tank
16. Detergent/clean water tank cap
17. Dirty water tank lid
18. Dirty water tank release catch
19. Dirty water tank max. fill mark
20. Dirty water tank
21. Dirty water tank max. fill float
22. Foam filter holder
23. Foam filter

Please retain instructions for future reference.

BATTERY SAFETY

- The supply terminals are not to be short-circuited.
- If the battery pack becomes exhausted, it should be removed from the product to avoid leakage.
- In the event of the battery pack leaking, do not allow any liquid to come into contact with the skin or eyes.
- If contact has been made, wash the affected area with copious amounts of water and seek medical advice.
- Keep the battery pack out of the reach of children.
- Avoid storing the battery pack in direct sunlight.
- Do not dispose of the battery pack in a fire.
- Do not crush, puncture, dismantle or otherwise damage the battery pack.
- Do not store above 60 °C.
- Do not expose the battery pack to heat or fire as it may explode.
- Do not subject the battery pack to mechanical shock.
- Do not dispose of the exhausted battery pack in household waste.
- To dispose of the exhausted battery pack, take it to a local recycling station. Contact the local government offices for further details.
- This appliance is fitted with a 22.2 V \approx 2600 mAh Li-ion battery (non-removable).

Dos and don'ts

DO:

Drain any remaining water from the clean and dirty water tanks.
Ensure the max. fill mark is not exceeded on the dirty water tank.

DO NOT:

Use harsh or abrasive cleaning detergents or scourers.
Attempt to replace the clean water/detergent tank whilst the floor cleaner is turned on.
Press the spray button if the clean water/detergent tank is empty or not inserted into the floor cleaner main unit fully.
Wring or twist the foam filter, as this can cause damage to the filter.
Use the floor cleaner without the foam filter in position.

Care and maintenance

Before attempting any cleaning or maintenance, always switch off and unplug the floor cleaner from the mains power supply.
Wipe the floor cleaner body with a soft, damp cloth and dry thoroughly.

Instructions for use

Assembling the floor cleaner

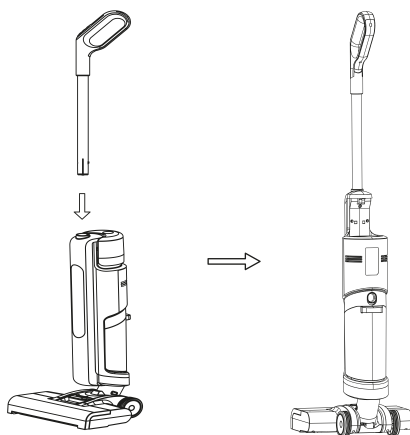

Remove the clean water tank following the instructions in the section entitled '**Filling the clean water/detergent tank**'.
Standing the floor cleaner main body upright, push the handle locking button down and push the metal tube into the handle opening on the main body. Once the handle is fully inserted into the main body, it will click into place.
To remove the handle from the main body, push the handle locking button down and lift the handle away from the main body.

Charging the floor cleaner

Before first use, the floor cleaner must be charged for approx. 5.5 hours.

Subsequent charging times will vary dependent upon use. If the floor cleaner battery becomes exhausted during use, it may take up to 5.5 hours to fully recharge it.

STEP 1: Make sure that the floor cleaner is switched off and unplugged from the mains power supply. Empty the clean water, detergent tank and the dirty water tank and check that the floor cleaner is cool, clean and dry.

STEP 2: Connect the mains power adaptor to the main unit and then plug it in to the mains power supply.

STEP 3: The three indicator lights will flash when the floor cleaner is charging and remain lit for 30 minutes when it has finished charging. After 30 minutes, the indicator lights will turn off.



NOTE: Whilst charging, the floor cleaner may become warm.

Filling the clean water/detergent tank

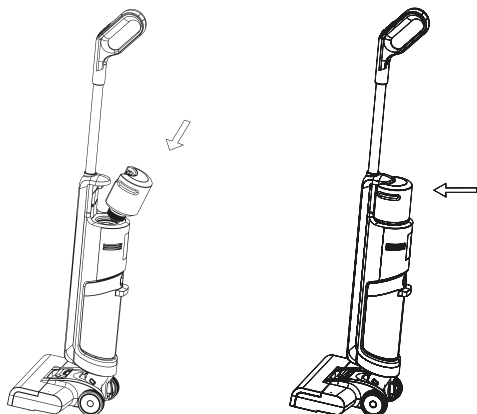

STEP 1: Remove the clean water/detergent tank by pressing down on the clean water tank and pulling it away from the floor cleaner main body.

STEP 2: Unscrew and remove the clean water/detergent tank cap. Fill the clean water/detergent tank with water or a diluted detergent.

STEP 3: Ensure the clean water/detergent tank cap is securely screwed back into place and is facing downwards before pushing the clean water/detergent tank into the main body housing. The tank will click into place when secure.



NOTE: Check the clean water/detergent tank is inserted fully into the floor cleaner.



CAUTION: Do not attempt to replace the clean water/detergent tank whilst the floor cleaner is turned on. Do not press the spray button if the clean water/detergent tank is empty or not inserted into the main unit fully.

Using the floor cleaner

STEP 1: The floor cleaner is not designed to pick up larger debris, please ensure the area to be cleaned is clear of larger debris before proceeding.

STEP 2: Make sure the floor cleaner is unplugged from the power adaptor and then fill the clean water/detergent tank following the instructions in the section entitled '**Filling the clean water/detergent tank**'.

STEP 3: Turn on the floor cleaner by pushing the power button once. The power indicator lights will illuminate green to signal the floor brush is rotating, whilst the spray indicator light will illuminate white to signal the low spray function is active.

STEP 4: If the increased spray function is required, press the spray button again. The spray indicator light will illuminate red signalling the high spray function is active. To switch off the spray function, press the spray button again. The spray indicator light will turn off.

STEP 5: Once the desired spray function has been selected, lightly step on the front of the floor cleaner head to disengage the head lock, pull the handle backwards and angle the cleaner, as desired.

STEP 6: To begin cleaning, slowly move the floor cleaner backwards and forwards over the desired area 3–4 times. To dry the floor once cleaning is complete, ensure the spray function is switched off.

STEP 7: Once finished, turn off the floor cleaner by pushing the power button.

STEP 8: To empty the dirty water tank, follow the instructions in the section entitled '**Emptying the dirty water tank**'.



CAUTION: The floor may be slippery once the floor cleaner has been used and the floor is wet. The floor cleaner should never be used without the foam filter being inserted. Avoid tilting the floor cleaner to the horizontal position during use, as this could risk water leaking from the dirty water tank.



WARNING: The floor cleaner will continue to operate for approx. three seconds after the power button has been pressed, this allows for any excess water to pass into the dirty water tank to prevent the unit from dripping when moving back to the storage tray. Never allow the dirty water tank to exceed the max. fill mark, this will cause the max. fill float to activate and the unit to cut off.

Accessing and maintaining the brush bar

The floor brush contains a removable brush bar for easy drying, cleaning, and storage.

STEP 1: Switch off the floor cleaner. Remove the floor brush cover by pressing the brush cover release button and pulling the cover away from the floor brush.

STEP 2: Lift the brush bar out of the floor brush using the brush bar release tab.

STEP 3: Remove any built-up dust, debris and hair from the brush bar and floor brush before placing the brush bar in the holder on the drying tray for easy storage.

STEP 4: When dry, replace the brush bar into the floor brush by inserting the right side first and pushing the brush bar down into place.

STEP 5: Align the hooks on the floor brush cover with the loops on the floor brush before pushing the cover into place until it clicks.



NOTE: Do not use water to clean the floor head and brush bar.

Emptying the dirty water tank

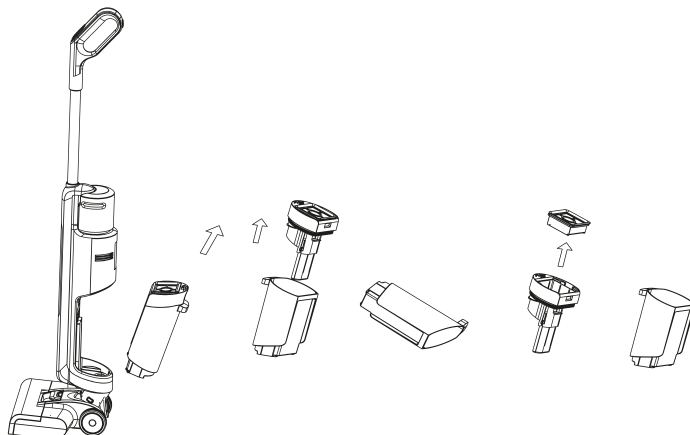

STEP 1: Switch off and unplug the floor cleaner from the mains power supply.

STEP 2: Push the dirty water tank release catch and remove the dirty water tank from the floor cleaner main unit.

STEP 3: Open the dirty water tank lid and lift the dirty water tank lid containing the max. fill float away from the dirty water tank.

STEP 4: Empty the dirty water tank and rinse it under clean running water.

STEP 5: Once clean, replace the dirty water tank lid containing the max. fill float into the dirty water tank until it sits flush.

STEP 6: Push the dirty water tank back into the main body of the floor cleaner by aligning the bottom of the water tank with the opening on the main unit and pushing into place until it clicks.



NOTE: The dirty water tank should be emptied after each use to avoid the build-up of undesirable odours.

Self-clean function

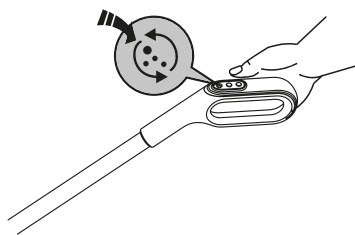

The self-clean function removes dirt and impurities from within the floor cleaner and around the floor brush. It is recommended to use this function after every use of the floor cleaner.

STEP 1: Switch off the floor cleaner and unplug it from the mains power adaptor.

STEP 2: Fill the clean water tank following the instructions in the section entitled '**Filling the clean water/detergent tank**'.

STEP 3: Make sure the dirty water tank is empty before proceeding onto the next step.

STEP 4: Place the floor cleaner on the storage tray and hold the self-clean button for 2 seconds. This will activate the self-clean function.

STEP 5: All four indicator lights will flash on the floor cleaner during this process. Allow the self-clean function to run uninterrupted for approximately 2 minutes or until the floor cleaner switches off. If necessary, the self-clean function can be repeated multiple times.

STEP 6: Then clean the foam filter by following the instructions in the section entitled '**Cleaning the foam filter**'.

STEP 7: Once the cycle has finished, remove and empty the dirty water tank following the instructions in the section entitled '**Emptying the dirty water tank**'.

STEP 8: Remove the brush bar and foam filter and store them in the marked slots on the storage tray to dry.



NOTE: The self-clean function must not be interrupted whilst it is running.



CAUTION: Only use the self-clean function with the foam filter installed. Never use self-clean without the filter in place.



WARNING: Do not use any foaming or disinfectant solution during the self-clean function, as this could damage the floor cleaner.

Cleaning the foam filter

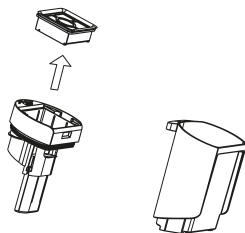

The foam filter is located on top of the dirty water tank and should be removed after each use for cleaning and maintenance.

STEP 1: To access the foam filter for cleaning, remove the dirty water tank from the main unit following the instructions in the section entitled '**Emptying the dirty water tank**'.

STEP 2: Lift the foam filter holder from the dirty water tank.

STEP 3: Lift the filter holder cap and remove the foam filter from the filter holder.

STEP 4: Shake off the foam filter until most of the debris has been removed, then wash it under clean, warm water and allow to dry thoroughly.

STEP 5: Once the foam filter has dried fully, slot it back into the filter holder and close the filter holder cap.

STEP 6: Slot the filter holder back into the dirty water tank and replace the dirty water tank in the main unit following the instructions in the section entitled '**Emptying the dirty water tank**'.



NOTE: The storage tray contains a foam filter storage slot, which is ideal for drying the filter after each use.



WARNING: Never use external heat sources, such as a radiator, to dry the foam filter.

Max. fill safety float

If the liquid in the dirty water tank exceeds the max. fill mark, the max. fill float in the dirty water tank will engage and cause the product to shut off. At this point, the unit should be switched off and the dirty water tank emptied and replaced following the instructions in the section entitled '**Emptying the dirty water tank**'. After this, it is safe to resume.

Troubleshooting

Problem	Possible cause	Solution
The floor cleaner will not turn on.	The battery is not charged.	Charge the floor cleaner following the instructions in the section entitled ' Charging the floor cleaner '.
The floor cleaner will not charge.	The mains power adaptor is not securely connected.	Connect the mains power adaptor to the charging port on the main unit, following the instructions in the section entitled ' Charging the floor cleaner '.
The floor cleaner will not suck up water.	The max. fill safety float has activated.	Follow the instructions in the section entitled ' Max. fill safety float '.

Storage

Empty the clean water/detergent tank and the dirty water tank.
Check that the floor cleaner is clean and dry before storing in a cool, dry place.

Specifications

Product code: BEL01814BRMFOB
Adapter input: 100–240 V ~ 50–60 Hz 0.4 A Max.
Adapter output: 26.5 V \equiv 0.5 A, 13.25 W
Battery: 22.2 V 2600 mAh rechargeable Li-ion
Output power: 180 W
Average active efficiency: 86.42%
Efficiency at low load (10%): 79.37%
No load power consumption: 0.094 W



Imported & distributed by:
BRAND MERCHANT PTY LTD.,
Suite 1, 77 Atherton Road.,
Oakleigh VIC 3166.

MADE IN CHINA.

©Beldray trademark. All rights reserved.

CD160923/MD090525/V3