

Beldray^{est 1872}®

**Our compact,
lightweight &
stylish
air purifier**



COMPACT AIR PURIFIER

INSTRUCTION MANUAL



www.beldray.com.au

Please retain instructions for future reference.

Safety Instructions

When using electrical products, basic safety precautions should always be followed.

Check that the voltage indicated on the rating plate corresponds with that of the local network before connecting the product to the mains power supply.

Children younger than 3 years old should be kept away from the product unless continuously supervised.

Children aged from 3 years and less than 8 years should only switch on/off the product, provided that it has been placed or installed in its intended operating position and they have been given supervision or instruction concerning the use of the product in a safe way and understand the hazards involved.

Children aged from 3 years and less than 8 years should not plug in, regulate or clean the product or perform user maintenance.

Children aged from 8 years and people with reduced physical, sensory or mental capabilities or lack of experience and knowledge can use this appliance, only if they have been given supervision or instruction concerning use of the appliance in a safe way and understand the hazards involved.

Children should not carry out cleaning or user maintenance without supervision.

Children should be supervised to ensure that they do not play with the product.

This product is not a toy.

This product contains no user serviceable parts. If the power supply cord, plug or any part of the product is malfunctioning or if it has been dropped or damaged, only a qualified electrician should carry out repairs. Improper repairs may place the user at risk of harm.

Keep the product and its power supply cord out of the reach of children.

Keep the product and its power supply cord away from heat or sharp edges that could cause damage.

Keep the power supply cord away from any parts of the product that may become hot during use.

Keep hands, fingers, hair and any loose clothing away from the rotating parts of the product.

Do not immerse the product in water or any other liquid.

Do not operate the product with wet hands.

Do not leave the product unattended whilst connected to the mains power supply or when in use.

Do not remove the product from the mains power supply by pulling the cord; switch it off and remove the plug by hand.

Do not use the product for anything other than its intended use.

Do not cover the product.

Do not use the product outdoors.

Do not move the product whilst it is in use.

Do not shake the product.

Do not put objects into any of the openings.

Do not clean the product with abrasive chemicals or materials such as scourers, as they may damage it.

Do not spray insecticide or chemical solvents on the product.

Always unplug the product after use and before any cleaning or maintenance.

Always use the product on a flat, stable surface.

Use of an extension cord with the product is not recommended.

This product should not be operated by means of an external timer or separate remote control system, other than that supplied with this product.

This product is intended for domestic use only. It should not be used for commercial purposes.

Warning: If a strong odour is emitted from the product, turn the unit off and unplug

Care and Maintenance

STEP 1: Unplug the air purifier from the mains power supply before attempting any cleaning or user maintenance.

STEP 2: Wipe the air purifier with a soft, damp cloth and dry thoroughly.

Note: Do not use flammable liquid, abrasive cleaning solvents, polishes or scouring pads to clean the air purifier, as this may cause damage.

Warning: Should the air purifier fall or be pushed over while there is water in the tank, it must be unplugged from the mains outlet immediately as a first action. The air purifier should be righted promptly and dried thoroughly before it is used again.

Description of Parts

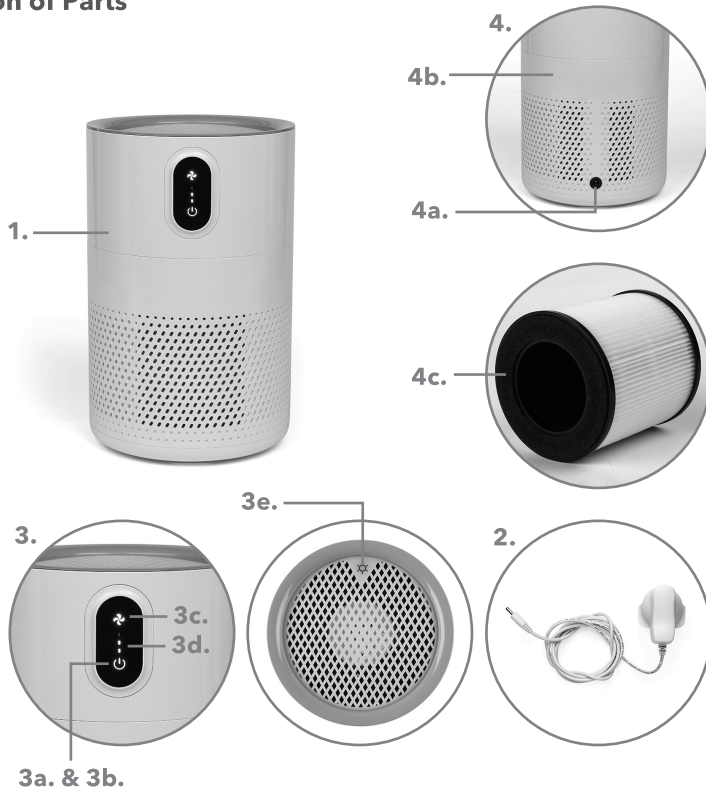

- 1. 16 Watt Air Purifier main unit
- 2. Power adaptor
- 3. Control panel
- a) Power button (⏻)
- b) Power indicator light
- c) Fan speed button (🌀)

- d) Speed setting indicator lights (●, ●●, ●●●)
- e) Night light button (🌙)
- 4. Base cover
- a) Power adaptor inlet
- b) Base cover lid
- c) Filter

Instructions for Use

Before First Use

Warning: Before removing the filter, make sure that air purifier is switched off and unplugged from the main power supply.

Removing the Polybag

STEP 1: Invert the air purifier and remove the base cover lid by twisting in an anticlockwise direction and pulling away from the air purifier main unit.

STEP 2: Remove the filter by lifting up and away from the air purifier main unit.

STEP 3: Remove the polybag from the filter then replace the filter back inside the air purifier main unit.

STEP 4: Replace the base cover lid, checking that the tabs are aligned with those on the base cover and lock into place by pressing downwards and rotating in a clockwise direction until secure.

Using the Air Purifier

STEP 1: Place the air purifier on a flat, stable surface at a height that is comfortable for the user. Plug in the power adaptor into the mains power supply.

STEP 2: Turn the air purifier on by pressing  on the control panel. The air purifier will beep once and start to function. Speed setting indicator light '●' (signalling the lowest speed setting) will illuminate on the control panel.

STEP 3: To select another speed setting, press  on the control panel. There are three speed settings to choose from: Low (●), Medium (●●), and High (●●●). The speed setting indicator lights will show the selected speed setting.

STEP 4: Turn off the air purifier by pressing .

Note: Make sure the air purifier is placed at least 30 cm away from any wall or piece of furniture.

The max. applicable area of use is 16 m² (225 ft²).

Warning: Do not position the air purifier directly under furniture or objects that may obstruct the exhaust air flow.

Do not use the air purifier near any source of heat.

Using the Night Light Function

STEP 1: To turn on the night light function, press  on the control panel.

STEP 2: Press  again to cycle through the LED light colour options. There are 3 LED light colour options to choose from: green, orange and red. The night light will automatically illuminate in the selected colour.

Replacing the Filter

The speed setting indicator lights (●, ●●, ●●●) will flash when the filter needs to be replaced.

STEP 1: To remove the filter from the air purifier, invert the air purifier and remove the base cover lid by twisting in an anticlockwise direction and pulling away from the air purifier main unit.

STEP 2: Remove the exhausted filter by lifting up and away from the air purifier main unit.

STEP 3: Place a new filter back into the air purifier main unit.

STEP 4: Replace the base cover lid, checking that the tabs are aligned with those on the base cover and lock into place by pressing downwards and rotating in a clockwise direction until secure.

Troubleshooting

Problem	Possible Cause	Solution
The air purifier will not switch on.	The air purifier is not connected to the mains power supply.	Plug in and switch on the air purifier at the mains power supply.
A strong odour is being emitted from the air purifier.	The surrounding area is not suitably ventilated. The filter is exhausted and needs to be replaced.	Unplug the air purifier from mains power supply and ventilate the area. Check if the power indicator light is flashing and replace the filter if necessary.
The air purifier is making a high-pitched sound.	The polybag has not been removed from the filter The filter is exhausted and needs to be replaced.	Check if the polybag has been removed and remove if necessary. Check if the power indicator light is flashing and replace the filter if necessary.
There are changes in humidity and temperature.	The area of the room is too large.	Use the air purifier in a room with an area of no bigger than the max. applicable area (20 m ²).

Specifications

Product code: EH3348BRMFOB
Input: 220-240 V ~ 50 Hz

Output: 16 W

Brand Merchant Pty Ltd. Suite 8, 8A St Andrews Street, Brighton Victoria 3186, Australia

If this product does not reach you in an acceptable condition please contact our Customer Services Department by **www.beldray.com.au**.

Please have your delivery note to hand as details from it will be required.

If you wish to return this product please return it to the retailer from where it was purchased with your receipt (subject to their terms and conditions).

The crossed out wheelie bin symbol on this item indicates that this appliance needs to be disposed of in an environmentally friendly way when it becomes of no further use or has worn out. Contact your local authority for details of where to take the item for recycling.



Imported & Distributed by:
Brand Merchant Pty Ltd
Suite 8, 8A St Andrews Street,
Brighton Victoria 3186, Australia

www.brandmerchant.com.au

©Beldray Trademark. All rights reserved.

Please retain instructions for future reference.

Made in China.



CD141020/MD310821/V3