

Storage

Check that the heater is completely cool before storing in a cool, dry place.

Never wrap the cord tightly around the heater; wrap it loosely to avoid causing damage.

Specifications

Product code: EH3000

Input: 230 V–240 V ~ 50 Hz

Power: 1500 W (low heat)/3000 W (high heat)

Item	Symbol	Value	Unit	Item	Unit
Heat output				Type of heat input for electric storage local space heaters only (select one).	
Nominal heat output	P_{nom}	0.7	kW	Manual heat charge control, with integrated thermostat.	No
Nominal heat output (indicative)	P_{min}	0	kW	Manual heat charge control.	No
Maximum continuous heat output	$P_{max,c}$	0.7	kW	with room and/or outdoor temperature feedback.	No
Auxiliary electricity consumption				Fan assisted heat output.	No
At nominal heat output	e_{lmax}	n/a	kW	Type of heat output/room temperature control (select one).	No
At minimum heat output	e_{lmin}	n/a	kW	Single stage heat output and no room temperature control.	No
In standby mode	e_{lse}	0.00032	kW	Two or more manual stages, no room temperature control.	No
				With mechanic thermostat room temperature control.	Yes
				With electronic room temperature control.	No
				Electronic room temperature control plus day timer.	No
				Electronic room temperature control plus week timer.	No
				Other control options (multiple selections possible).	
				Room temperature control, with presence detection.	No
				Room temperature control, with open window detection.	No
				With distance control option.	No
				With adaptive start control.	No
				With working time limitation.	Yes
				With black bulb sensor.	No



Disposal of Waste Batteries and Electrical and Electronic Equipment



This symbol on the product, its batteries or its packaging means that this product and any batteries it contains must not be disposed of with household waste. Instead, it is the user's responsibility to hand this over to an applicable collection point for the recycling of batteries and electrical and electronic equipment. This separate collection and recycling will help to conserve natural resources and prevent potential negative consequences for human health and the environment due to the possible presence of hazardous substances in batteries and electrical and electronic equipment, which could be caused by inappropriate disposal. Some retailers provide take-back services which allow the user to return exhausted equipment for appropriate disposal. **It is the user's responsibility to delete any data on electrical and electronic equipment prior to disposal.** For more information about where to drop batteries, electrical and electronic waste off, please contact the local city/municipality office, household waste disposal service, or the retailer.

User manual

Fan heater

This product is only suitable for well-insulated spaces or occasional use.

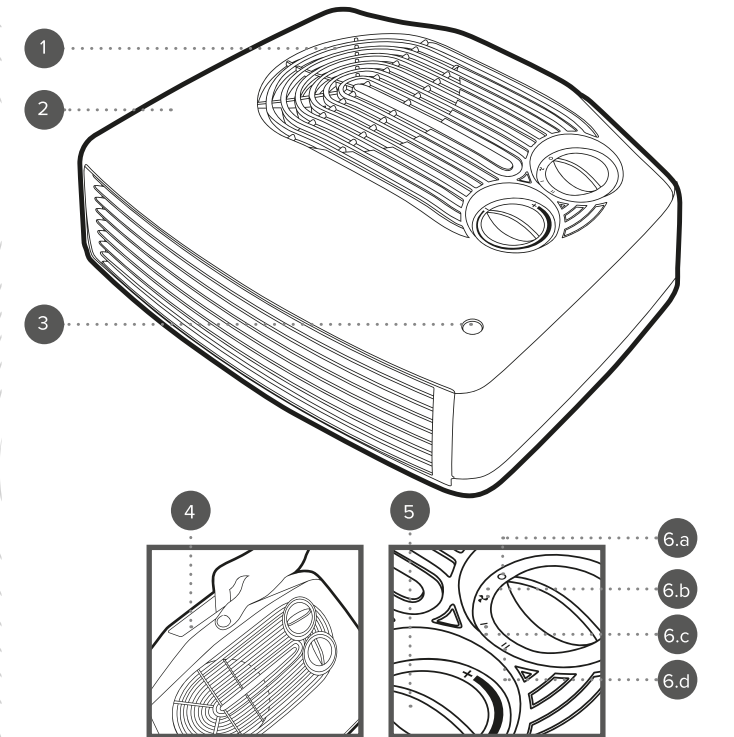

1. Air intake
2. Heater main unit
3. Power indicator light
4. Carry handle
5. Adjustable thermostat

6. Heat control dial
 - a. – Power off
 - b. – Fan control (cool air)
 - c. – low heat setting (1500 W)
 - d. – high heat setting (3000 W)



Manufactured by:
Ultimate Products UK Ltd.,
Victoria Street, Manchester OL9 0DD. **UK.**
Ultimate Products Europe Ltd.,
19 Baggot Street Lower, Dublin D02 X658. **ROI.**

MADE IN CHINA.

CD050424/MD000000/V1

Please retain instructions for future reference.

WARNING – READ BEFORE USE

When using the product for the first time, a slight odour and a small amount of smoke may be emitted. This is normal and will soon subside. Allow for sufficient ventilation around the product. Before each use, check the product for damage. If there is any sign of damage or if the fan blades are not rotating, cease using immediately and dispose of the product.

Do not leave the product unattended while in use.

This product can be used for no longer than 4 hours, after which time it must be switched off and allowed to cool fully before it is used again.

The product must be placed at least 1 metre away in every direction from walls, doors, furniture, curtains, or any other flammable materials. Do not use in dusty environments.

SAFETY INSTRUCTIONS

- When using electrical products, basic safety precautions should always be followed.
- Check that the voltage indicated on the rating plate corresponds with that of the local network before connecting the product to the mains power supply.
- Children aged from 8 years and people with reduced physical, sensory or mental capabilities or lack of experience and knowledge can use this appliance, only if it has been placed in its intended operating position and they have been given supervision or instruction concerning use of the appliance in a safe way and understand the hazards involved.
- Children should not perform cleaning or user maintenance unless they are older than 8 years and supervised.
- This is not a toy – never leave the appliance within reach of children or pets.
- Nominal voltage is still present in this product as long as the product is connected to the electrical source.
- If the plug or any part of the appliance is malfunctioning or if it has been dropped or damaged, cease using the product immediately to avoid potential injury.
- This appliance contains no user serviceable parts, only a qualified electrician should carry out repairs. Improper repairs may place the user at risk of harm.
- Do not immerse the product or plug in water or any other liquid.
- Do not operate the product with wet hands.
- Do not use this product in the immediate surroundings of a bath, a shower or swimming pool.
- Do not leave the product plugged in or operating overnight.

- Do not use the product for anything other than its intended use.
- Do not attempt to move the product whilst it is in use.
- Do not use the product with a programmer, timer, separate remote-control system or any other device that will switch the product on automatically, as there is a risk of fire if the heater is covered or positioned incorrectly.
- Only use the product in a single plug socket, do not position so that when rotated it covers a neighbouring socket.
- Never use accessories that are not recommended or supplied by the manufacturer. It could cause danger to the user and damage to the product.
- This product is intended for domestic use only. It should not be used for commercial purposes.



CAUTION: Some parts of this product can become very hot and cause burns. Particular attention has to be given where children and vulnerable people are present.
Hot surface – do not touch the hot section or heating components of the product.



WARNING: In order to avoid overheating, do not cover the product. Always check the plug sockets for damage before and after use. Do not use the product in damaged or ill-fitting plug sockets. This product is not equipped with a device to control the room's temperature. Do not use this product in small rooms whilst occupied by persons incapable of leaving the room on their own, unless constant supervision is provided.

Thermal cut-out device

The heater is fitted with a thermal safety cut-out device, built in to prevent it from overheating. Should the heater start to overheat, the thermal safety cut-out system will automatically operate and the heat settings will switch off. If this happens:

STEP 1: Switch off the heater by turning the heat control dial to (O).

STEP 2: Check that the heater is unplugged from the mains power supply and allow it to cool for approx. 15 minutes.

STEP 3: Clear any blockages present on the vent, being careful not to damage the heater.

STEP 4: Plug in and switch on the heater at the mains power supply.



CAUTION: In order to avoid a hazard, due to inadvertent resetting of the thermal cut-out, this heater must not be supplied through an external switching device such as a timer or connected to a circuit that is regularly switched on and off by the product.

Care and maintenance

Always unplug the heater from the mains power supply and allow to cool sufficiently before performing any cleaning or maintenance. Wipe the heater with a soft, damp cloth and allow to dry thoroughly. Do not use harsh or abrasive cleaning solvents, as these may damage the finish of the heater.

Instructions for use

Before first use

STEP 1: Check that there is no damage to the heater.

STEP 2: Position the heater on a flat, stable, heat-resistant surface in an open space, at least 1 metre away from furniture, curtains or any other flammable materials. Do not block the air intake on top of the heater.



NOTE: When using the heater for the first time, a slight odour may be emitted. This is normal and will soon subside. Allow for sufficient ventilation around the heater.

Using the heater

STEP 1: Plug in and switch on the heater at the mains power supply.

STEP 2: Turn the thermostat dial to maximum.

STEP 3: To turn on the heater, select a heat setting by turning the heat control dial in a clockwise direction to the desired position; (☼) will emit cool air, whilst (I) and (II) will produce hot air with a low heat setting (1500 W) and a high heat setting (3000 W) respectively.

STEP 4: Turn off the heater by turning the heat control dial to (O).



NOTE: The thermostat dial will need to be rotated to the fully clockwise position for the fan to operate in the fan only mode; (☼)

Thermostat dial

When the room reaches the desired temperature, slowly turn the thermostat dial anticlockwise until a click sounds and the power indicator light switches off. The heater will temporarily switch off. If the room temperature falls below the desired temperature, the heater and power indicator light will turn on again until the room temperature reaches the desired temperature.



NOTE: The heat indicator light will illuminate whilst the heater is warming up and will cycle on and off during use to show that the correct temperature is being maintained. The heater will only produce heat if the adjustable thermostat is at a higher temperature than the room temperature.